

OptiLine

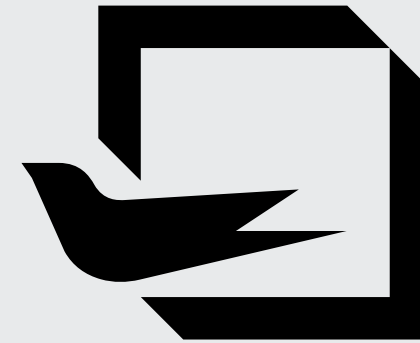

OPENING
NEW
HORIZONS

+31
years of experience

+70.000
square meters

+2.500
partners



Optimedia has been producing PVC and Aluminum joineries since 1994, amassing an impressive and modern production system. Since 2006, we have started exporting our products currently having more than 2.500 B2B partners worldwide.

OUR VISION:

To be a leader in the production of PVC and Aluminum joineries, offering support to all our partners. To achieve this, we have kept to our core principles, maintaining the quality of our products and the relationships with our partners as top priorities.

OUR MISSION:

To produce windows and doors that have certified and proven characteristics, manufactured and delivered to the highest market standards.



GUARDIAN GLASS is one of the largest and most innovative glass manufacturers in the world. Founded in 1932 in Detroit, Michigan, the company operates on five continents, serving more than 160 countries.

guardianglass.com



SAINT-GOBAIN GLASS is the european leader in the production of construction glass. The factory in Călărași, Romania, has the most modern float glass production line in Europe. The thermal, acoustic and security performances of SAINT-GOBAIN glazings recommends them for the most creative and original architectural solutions.

saint-gobain-glass.com



As an independent family-owned business, the RENOLIT Group has been setting quality and innovation standards for over 75 years. Around 5,000 employees at more than 30 locations worldwide are continuously developing pioneering products and High-quality plastic films for all key industries.

renolit.com



Continental is one of the world's leading industrial specialists. Its customers can be found in key industries such as machine and plant engineering, mining, the agricultural industry and the automotive industry. The company uses its development and material expertise for products and systems made of rubber, polyamide, metal, textile, and electronic components.

continental-industry.com



WINKHAUS develops, manufactures and sells hardware for windows and doors, together with automatic closing, access and security systems. The german WINKHAUS group was founded in 1854, remaining a family business with over 2.000 partners worldwide.

winkhaus.com



MACO is an austrian windows & doors hardware manufacturer that ensured its success through the quality of its products, being the first company in its field to be certified according to ISO 9001 standards.

maco.at

OptiLine

Double Gasket Window

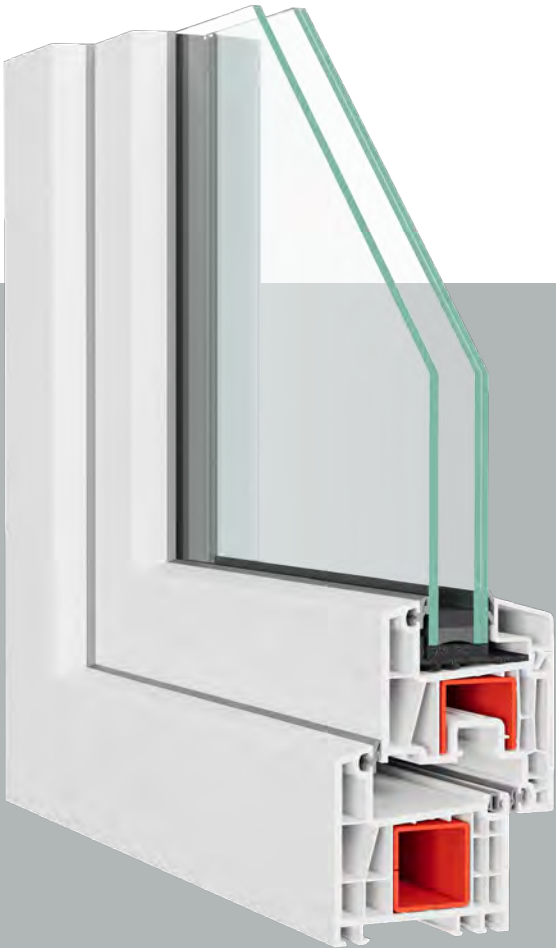

PRODUCT GEOMETRY

2 ¾ in
5 insulation chambers

IGU OPTIONS

Double/Triple-Pane
maximum IGU thickness: 1 ⅝ in

THERMAL PERFORMANCE

U_{factor} ≥ 0,16 Btu/h·ft²·F

MAX. ACOUSTIC PERFORMANCE

46 dB

OPENING STYLES

**Tilt & Turn
Casement
Hopper / Awning
Fixed**



The OptiLine system with 5 insulation chambers for both frame and sash, ensures a high level of thermal and acoustic comfort. Geometrically, it comes with a frame depth of just 2 ¾ in. The chemical composition of the profiles ensures superior mechanical and aesthetic performances, guaranteeing the system’s resistance and durability over time.

*THE PHOTOS ARE FOR INFORMATIONAL PURPOSES ONLY.



OptiLine

Casement

PRODUCT GEOMETRY

2 ¾ in
4 frame insulation chambers
6 sash insulation chambers

IGU OPTIONS

Double/Triple-Pane
maximum IGU thickness: 1 ⅝ in

THERMAL PERFORMANCE

U_{factor} ≥ 0,16 Btu/h·ft²·F

MAX. ACOUSTIC PERFORMANCE

46 dB

OPENING STYLES

**Casement
Fixed**

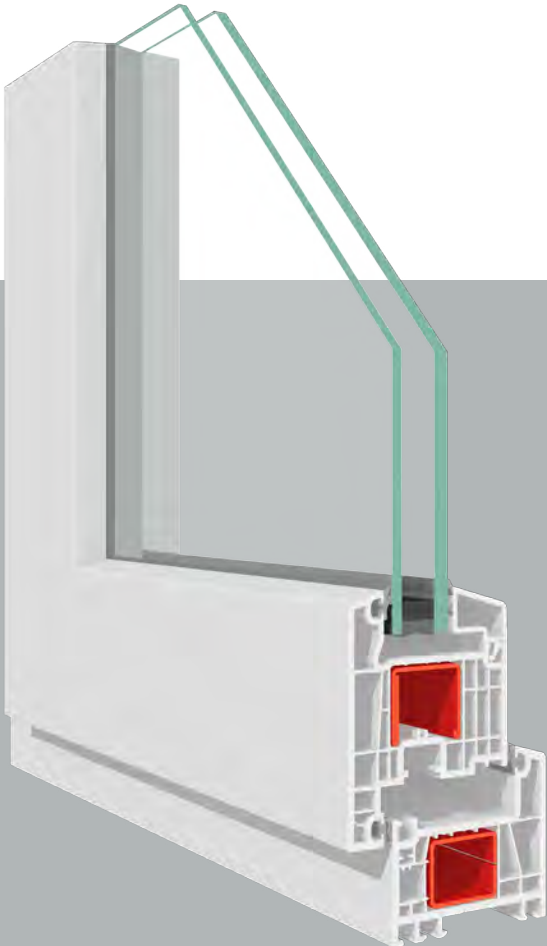

*THE PHOTOS ARE FOR INFORMATIONAL PURPOSES ONLY.



The OptiLine casement window ensures a high level of thermal and acoustic comfort. The chemical composition of the profiles guarantees superior mechanical and aesthetic performances, guaranteeing the system's resistance and durability over time.



OptiLine

Entry Door

PRODUCT GEOMETRY

2 ¾ in
2 sealing gasket
5 insulation chambers

IGU OPTIONS

Double/Triple-Pane
maximum IGU thickness: **1 ⅝ in**

THERMAL PERFORMANCE

U_{factor} ≥ 0,16 Btu/h·ft²·F

MAX. ACOUSTIC PERFORMANCE

46 dB

OPENING STYLES

Inswing Door
Outswing Door

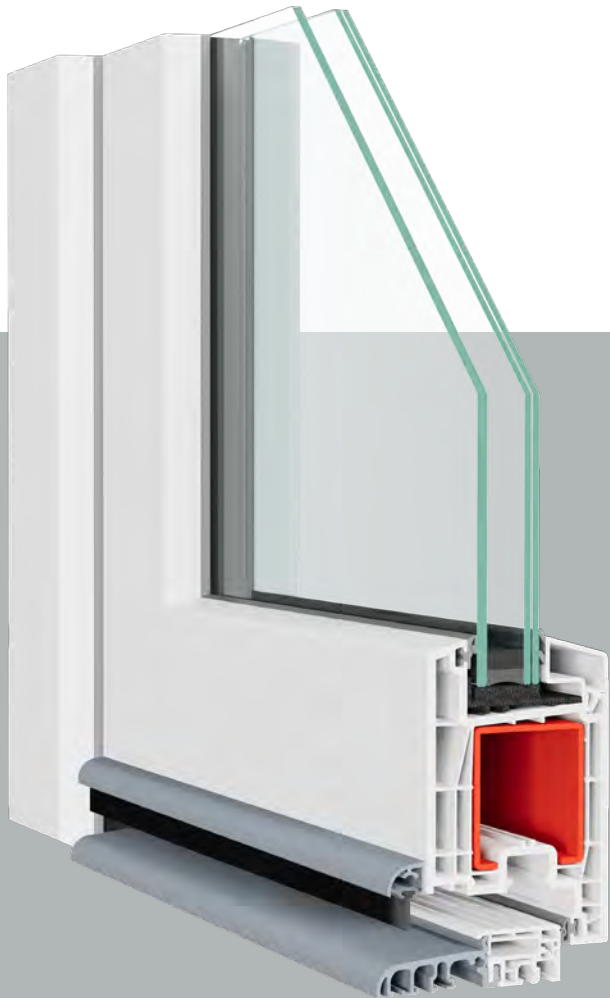

*THE PHOTOS ARE FOR INFORMATIONAL PURPOSES ONLY.



The OptiLine system with 5 insulation chambers for both frame and sash, ensures a high level of thermal and acoustic comfort. Geometrically, it comes with a frame depth of just 2 ¾ in. The chemical composition of the profiles ensures superior mechanical and aesthetic performances, guaranteeing the system’s resistance and durability over time.



OptiLine

Sliding

PRODUCT GEOMETRY

2 ¾ in
with brushes
3 insulation chambers

IGU OPTIONS

Double Pane
maximum IGU thickness: 1 in

THERMAL PERFORMANCE

U_{factor} ≥ 0,23 Btu/h·ft²·F

MAX. ACOUSTIC PERFORMANCE

38 dB

OPENING STYLES

Multi-Slide Patio Door

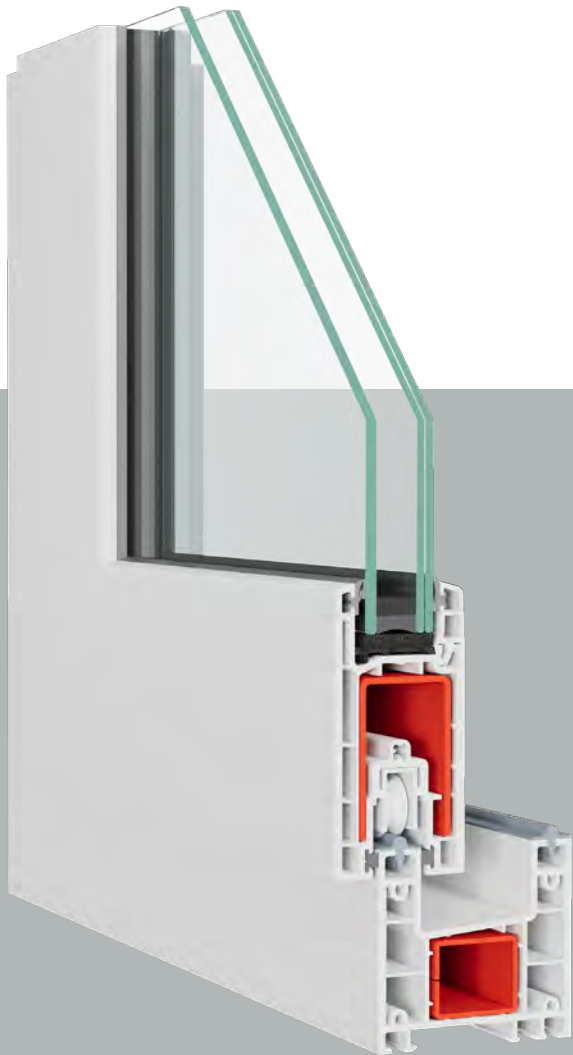

*THE PHOTOS ARE FOR INFORMATIONAL PURPOSES ONLY.



The OptiLine sliding windows and doors system with a 2 ¾ in frame, is highlighted by the minimalist central node measuring only 1 1/8 in which gives it an elegant and modern look. This system offers good thermal and acoustic performances, whilst also maximizing the natural light indoors.



Composition

One of the most important processes in the entire life cycle of the product is the design and production of the material itself. It is at this stage that the PVC resin acquires the necessary characteristics to guarantee its good performance during the manufacturing process and ensure the durability of the final window.

Dry mix: Powder composed mainly of PVC resin, but incorporating other elements, forming a total mixture of 5 components.



OUR DRY MIX

K-97 PVC Resin - Main component, it gives the profile its plastic properties as well as its thermoplastic character

Titanium Dioxide - We use the highest proportion of titanium dioxide available on the market. 7 parts out of 100 guarantee a purer white with greater mechanical resistance and better protection against ultraviolet rays.

Calcium Carbonate - Improves the surface finish of the profile. However, if the ratio is too high the profiles will turn yellow, will not weld well and will be more fragile. For OptiLine products there were only 5 parts added out of 100, compared to the 8 out of 100 used by other brands.

Impact Modifier - Based on an acrylic polymer, it improves the impact resistant properties of the profile. We obtained a class II grading, with maximum resistance to impacts by falling mass on all main profiles.

Stabilizer - It allows the mixture to be made at the optimal temperature and facilitates the extrusion of the profile. The precise amount of resin allows our profiles to withstand higher temperatures and limits expansion.

V-Perfect Welding

PERFECTION IS RIGHT AROUND THE CORNER



Thanks to this patented technology which allows the perfect alignment of the profile junctions and the removal of welding marks, the PVC window's corner finish can reach a quality level equal to that of wooden or aluminum windows. The appearance of the V-Perfect weld answers the current architectural needs, thus addressing the complex and constantly evolving requirements imposed by the market.

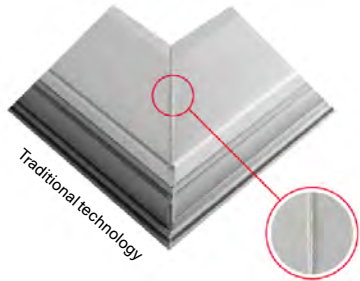
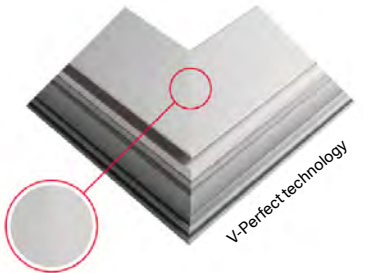

GOOD TO KNOW:

The standard is available for foiled profiles.
The delivery time is the same as for conventional welding.

Min / Max Size: 11 ¾" × 11 ¾" / 110 ¼" × 125 ¾"

Available for the full range of PVC products

Conventional welding is still available



A quality hardware guarantees the optimal usage and safety of the joinery, Optimedia offering you both Winkhaus and Maco solutions. In any variant, the reliability guaranteed at over 15,000 closing-opening cycles, water tightness, multi-point locking and anti-burglary systems are just some of the advantages of the hardware we use. Joineries equipped with our hardware provide protection against incorrect handling and discreet ventilation positions which are secured against burglary attempts.

Optimedia offers you window handles with a patented security mechanism, Secustik, which prevents the window from being operated from the outside. As standard, the handles and hinge covers can be white or brown, with silver, bronze, gold, black, dark brown or cremeweiss being available on demand. The door handles we offer also cover a wide range of shapes and colors (white, brown, silver or gold).

WE OFFER TWO TYPES OF SYSTEMS FOR ENTRANCE DOORS:

Two lever handles inside/outside

A lever handle on the inside and a pull handle on the outside

For the exterior, we also offer rail handles with dimensions ranging from 15 ¾ in to 70 ¾ in.

Hardware and Handles



Black Brown Bronze Silver White

Window Handles

Option 1 - Toulon

Option 2 - Atlanta



Black Brown Bronze Gold Silver Cream White

Door Handles



Option 1

Option 2



Special Handles

Ensuring the safety and comfort of our customers is our top priority. That's why we offer hardware and handles designed with specialized features to meet your needs. In the event of an emergency evacuation, our thumb turn cylinder allows doors to be opened effortlessly. Additionally, our ADA-compliant handle adheres to accessibility standards providing ease of use for individuals with disabilities.

To complement your style, we also provide a wide range of color options, combining functionality with design.

ADA-COMPLIANT HANDLE



THUMB TURN CYLINDER



Design: The nearly 7-inch handle is ergonomically crafted, ensuring a secure grip and effortless operation from various angles and heights.



Performance: Our specialized hardware, enables smooth functionality with minimal physical effort required, prioritizing ease of use for all.



Colors: A variety of color options are available, including white, brown, bronze and silver.



Glass represents approximately 80% of a joinery's surface. Optimedia equips its products with Saint Gobain Glass or Guardian glazings that meet thermal, acoustic and security requirements, whilst ensuring the desired indoor ambiance. Their winter-summer comfort function maintains a pleasant interior atmosphere throughout the year, with the sheen of their coating giving the space a touch of elegance.

CONFIGURATION OPTIONS

For design purposes or to protect you from prying eyes, Optimedia offers you a wide range of decorative glass with a large number of models, textures and colors.

Also, for added style and elegance, you can choose between georgian and astragal bars. These can be of different sizes, colors and shapes, made of PVC or Aluminum.

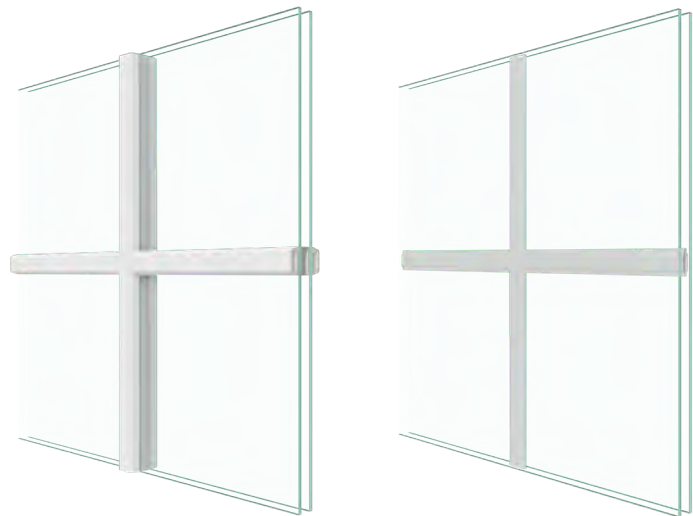

Astragal Bars

1" x 3/8" or 1 5/8" x 3/8"

Georgian Bars

3/4" x 1/4" or 1" x 1/4"

Tempered glass: Optimedia ESG

ESG is a type of glass that, following the tempering process, shows a considerably higher resistance to mechanical and thermal stresses compared to ordinary glass (including laminated glass). In case of breakage, ESG glass fragments into small pieces with blunt edges. Its superior mechanical properties recommend it for large glazed elements.

USES:

Architectural: all types of interior or exterior windows, doors and glass assemblies, consisting of independent or linked elements, facades, glazed roofs, stairs and even glass floors;

Urban furniture: telephone booths, public transport stations, parapets;

Interior furniture: table tops, shower cabins, shelves, furniture.

WHY ESG (TEMPERED) GLASS?



ESG glass is 50% lighter than laminated glass, thus facilitating its transport and assembly whilst at the same time extending the joinery's life by reducing the load on the hardware.



It is 5 times more resistant to tension, shocks and bending stresses compared to an ordinary or laminated glass of the same thickness.



It reduces the risk of injury in case of breakage, by fragmenting into small, blunt pieces and limits the risk of break-ins.

Glass

Color palettes

With a palette of over 10 colors and textures (different wood imitations as well as solid matte or metallic colors) we offer a customized solution for everyone’s taste ensuring diversity, durability and color resistance over time.

You can opt for white on two sides, white on the inside/color on the outside or color on both sides.

The three gasket options perfectly complement the profile offer. Depending on Optimedia’s standard regarding gasket to PVC body color combinations, the available options are: gray gaskets on white and cream profile bodies, black gaskets on gray and brown bodies and caramel gaskets on caramel bodies.

Color reproductions are only partial and approximate. For the complete and accurate color range, please **consult the official Optimedia color palettes**.

AVAILABLE BODY COLOR OPTIONS:

OptiLine - white, brown
OptiLine Sliding- white, brown

GASKET COLORS IN THE CASE OF LAMINATED PROFILES



Exterior / Interior Colors - Extended Warranty Available

		
White-Profile Color	Moondance	Anthracite Gray
		
Fango	American Brown	Brown
		
Golden Bronze	Black Smooth 2	Turner Oak Toffee

Interior Colors

		
Weissbach Oak	Ginger Oak	Honey Oak

Smart Keys

Together with our top supplier, we are proud to present an electronic locking system that offers enhanced flexibility, complete control, and a comprehensive overview of your entire locking setup. Compared to traditional mechanical locking systems, the smart keys developed by WinkHaus excel in their user-friendly design, robust security, and long-term cost savings.

APPLICATIONS:

Homes: blueCompact is perfect for smart homes and residential buildings;

Businesses: blueSmart is an ideal solution for growing businesses and commercial buildings; The system supports the integration of hundreds of cylinders and keys, providing scalability and efficiency.



Masterkey



Cylinder



Keys, available in 5 colours

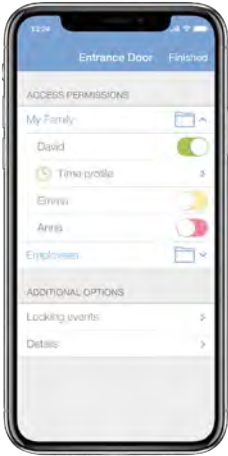

ADVANTAGES

- Convenience**
Easily manage your entire locking system with an app
- Flexibility**
Grant acces or block lost keys at the flick of a switch
- More control**
All access events can be closely monitored
- Remote access**
Locking authorisations can be issues remotely
- Security**
Data is only stored on the masterkey
- Practicality**
Easy installation and flexible expansion

OptiLine Double Gasket Window

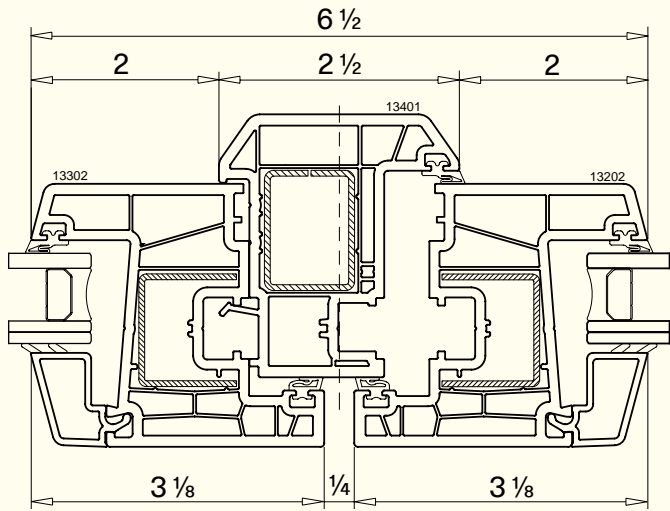
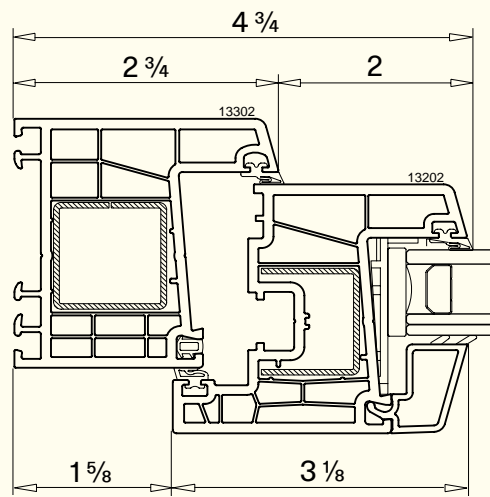

OptiLine Entry Door

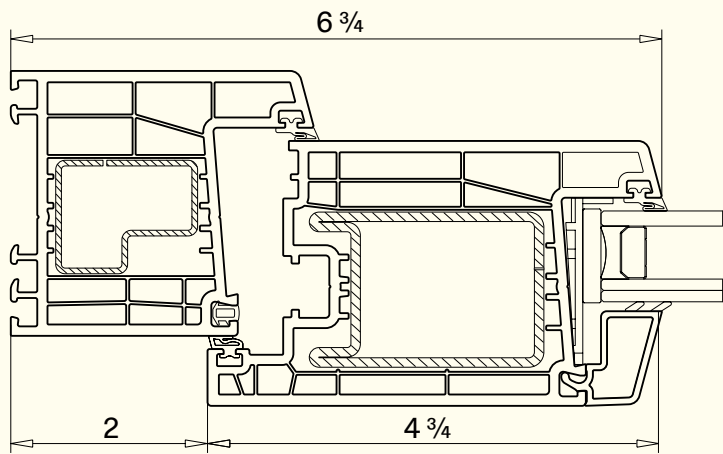
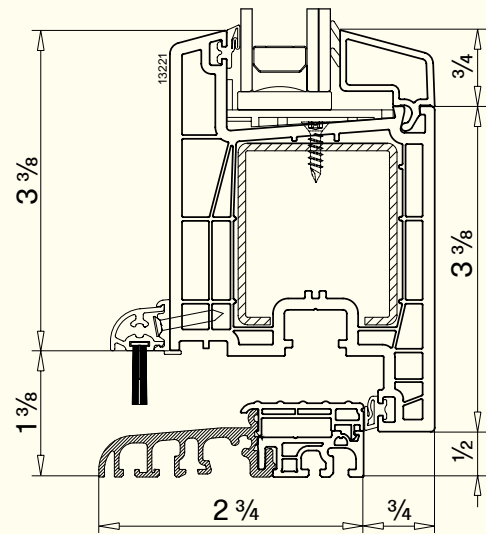

OptiLine Casement

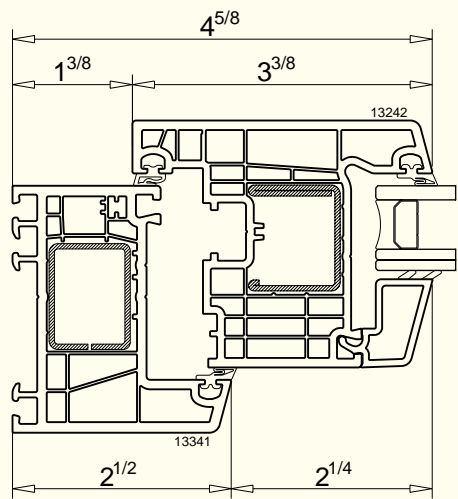

OptiLine Sliding

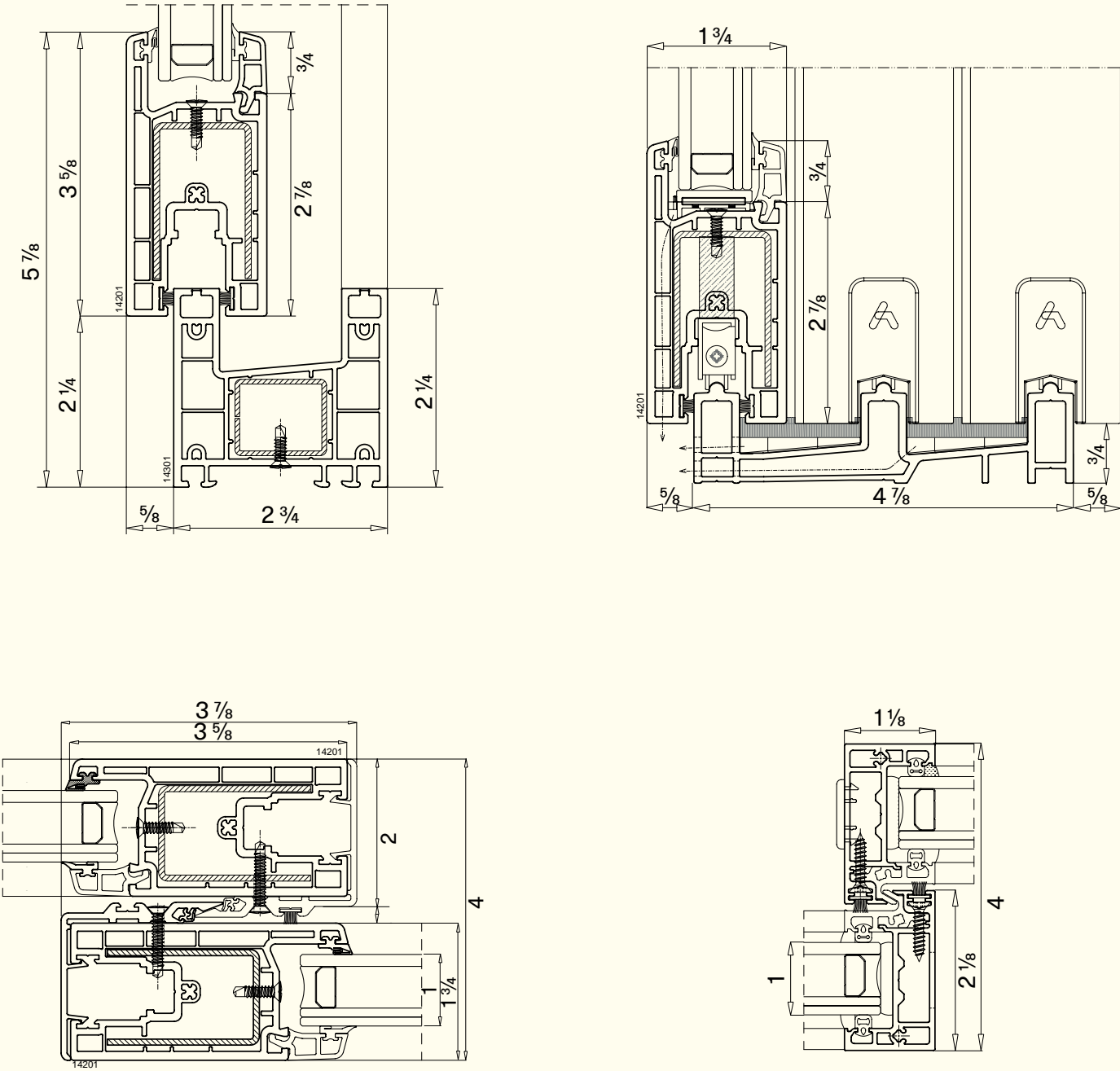

Join the Optimedia team

We are constantly recruiting agents to represent Optimedia. We export to all continents and offer extensive sales support and packages so you can be an exceptional dealer in your area.



Contact

 [optimedia](#)

 [Optimedia SRL](#)

 [optimedia.eu](#)

 [optimedia.eu](#)





S.C. OPTIMEDIA S.R.L.
Calea Sântandrei, nr. 38
410238, Oradea, România
+40 259 442 821
worldwide@optimedia.eu

optimedia.eu