

Balcony Waterproofing System

Durable, Watertight Protection for Long-Lasting Performance



Ensure every balcony stays dry and safe with our proven waterproofing and drainage system, designed to prevent damage due to water infiltration.

Keene Building Products High-Performance Composite Drainage System for Critical Waterproofing and Drainage Applications

Our highly puncture-resistant membranes feature cross-woven HDPE coated fabric that makes mechanical damage easy to detect during installation. For superior waterproofing protection, select **Driwall™ Membrane 60-36** or **Driwall™ Membrane 60-12** paired with galvanized flashing for industry-standard applications, or choose **Driwall™ Membrane 105-12 Flashing** to eliminate metal flashing and simplify installation.

Select the **Driwall™ Prefabricated Composite Drain** system that matches your project needs: 10/013 for low-profile applications, 10/025 for mid-profile, or **TriDent® Dimple Drain** for cost-effective performance.

Together, these solutions provide comprehensive moisture management for balconies and ensures long-term protection.

DETAIL SYSTEM OPTIONS

Galvanized Metal Flashing

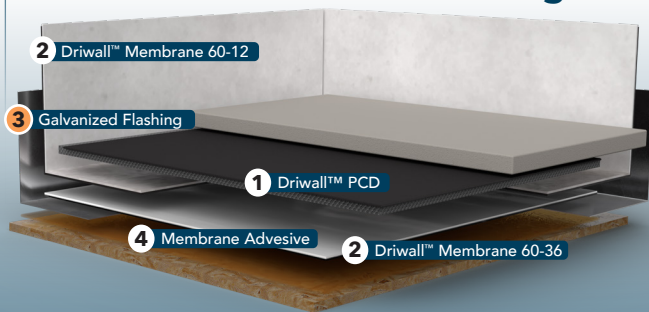

Maximum Protection Meeting Industry Standards for Balcony Waterproofing

- 1 **Drainage Layer Options:**
PCD 013 for Low Profile
PCD 025 for Mid Profile
TriDent® Dimple Drain
- 2 **Membranes:**
Driwall™ 60-36 and 60-12
- 3 **Flashing:**
26-gauge galvanized flashing
- 4 **System Accessories:**
Driwall™ Membrane Adhesive
KeeneSeal 100

Asphaltic Flashing Membrane

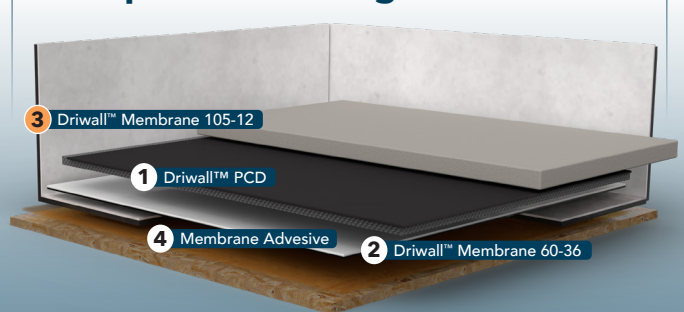

Streamlined Flashing Membrane System for Effortless Balcony Installation

- 1 **Drainage Layer Options:**
PCD 013 for Low Profile
PCD 025 for Mid Profile
TriDent® Dimple Drain
- 2 **Deck Membrane:**
Driwall™ 60-36 and 60-12
- 3 **Flashing Membrane:**
Driwall™ 105-12
- 4 **System Accessories:**
Driwall™ Membrane Adhesive
KeeneSeal™ 100



Keene's Driwall™ System includes a 10-year Limited Warranty

The Limited Warranty covers leaks caused by defects in materials or workmanship when the system is installed as instructed. Coverage applies only to the original owner and the full Keene system. If a covered defect is verified, Keene may repair, replace, or credit the product. Damage from improper installation, misuse, or external conditions is not covered. Claims must be filed within 30 days of discovery with proof of purchase.

Balcony Waterproofing System

Durable, Watertight Protection for Long-Lasting Performance



Drainage Layer Options



Driwall™ PCD 10/013

Description	Value
Thickness	0.13" (3.175mm)
Area	400 sq. ft
Flow rate at 2% with 1,000 PSF compressive load applied (working load)	0.28 gpm/ft. of width

Driwall™ PCD 10/025

Description	Value
Thickness	0.25" (6.0mm)
Area	400 sq. ft
Flow rate at 2% with 1,000 PSF compressive load applied (working load)	1.12 gpm/ft. of width



Flow Rates by Application: ASTM D4716

TriDent® Dimple Drain

Product	Thickness	Area	Flow rate at 2% with 1,000 PSF compressive load applied (working load)
TriDent® DD 025	0.25" (6.35mm)	200 sq. ft	.45 gpm/ft. of width

Keene's Driwall™ Balcony System includes a 10-year Limited Warranty

The Limited Warranty covers leaks caused by defects in materials or workmanship when the system is installed as instructed. Coverage applies only to the original owner and the full Keene system. If a covered defect is verified, Keene may repair, replace, or credit the product. Damage from improper installation, misuse, or external conditions is not covered. Claims must be filed within 30 days of discovery with proof of purchase.

System Accessories

Driwall™ Membrane Adhesive



Property	Measurement
VOC	2.1 lbs/gallon or 250 grams/liter
Viscosity	1250 cps
Density	7.75 lbs/gallon
% Solids	33%
Coverage	Approximately 450 sq ft/gallon when applied at 1 mil

KeeneSeal™ 100



Property	Measurement
Cure System	Hybrid, Moisture Cure
Movement Capability	± 25%
Modulus	Medium
Temperature Range	-75°F to 225°F
Intermittent Temp Range	250°F
Cure Rate	1/8" per 24 hrs*

Membrane Options

*Use of Driwall™ Membrane 60-36 with 60-12 requires additional use of 26 gauge galvanized flashing.



Driwall™ Membrane 60-36 & 60-12*

Self-Adhesive Waterproofing Membranes (36" and 12" width rolls)

Property	Measurement
Thickness	60 mil (1.5mm)
Tensile Strength Membrane	390 psi
Tensile Strength Film	6,242 psi
Face Fabric	Cross-Woven HDPE
Puncture Resistance	> 60 lbs
Water Vapor Permeation	0.02
Moisture Absorption	0.2%
Hydrostatic Head	Pass 231 ft

Driwall™ Membrane 105-12

(12" width rolls only)

Measurement
105 mil (3mm)
390 psi
6,242 psi
Cross-Woven HDPE
> 60 lbs
0.02
0.2%
Pass 231 ft