

A photograph of a brick building with a large window reflecting a stone building. The building has a gabled roof with a grey shingle pattern. The brickwork is a mix of red and tan colors, with horizontal bands of lighter-colored bricks. The window is framed in dark wood or metal. The background is a clear blue sky.

Moisture Management for Masonry



Masonry Division of
Keene Building Products

Your Reputation. Your Legacy. Our Mission.

Building professionals who work with masonry know the #1 reason masonry buildings fail is moisture trapped behind the veneer.

Professionals also know that it is impossible to keep moisture from penetrating the masonry veneer, so the best masonry building designs manage both liquid water and water vapor to allow masonry and substrates to drain quickly and dry completely between wetting events.

MortarNet Solutions is the only company in the industry that specializes exclusively in moisture management solutions for all types of masonry walls, including cavity, single-wythe block and adhered masonry walls. Each solution is designed to help prevent moisture damage, and to be fast and easy to install.

MortarNet Solutions' industry-leading moisture management solutions help designers and contractors build projects they can be proud of for a lifetime.





CAVITY WALL CONSTRUCTION

- MortarNet, WallDefender, & MortarDeflection
- WeepVent & CellVent
- TotalFlash
- CompleteFlash
- Cav-Air-Ator
- Flashing Membranes & Accessories

ADHERED MASONRY CONSTRUCTION

- LathNet
- Driwall
- WallNet

SINGLE WYTHER CONSTRUCTION

- BlockFlash
- BlockNet

COMMERCIAL CONSTRUCTION

Our products facilitate proper airflow within cavity walls and drainage planes, helping to maintain the integrity and performance of your legacy buildings.



At MortarNet, we understand that commercial construction is about more than just buildings - it's about creating legacy structures that endure for generations. Investing in superior protection for masonry walls is crucial in ensuring effective moisture management and long-lasting durability in projects.





CAVITY WALL CONSTRUCTION

- HouseNet
- WeepVent & CellVent
- TotalFlash
- CompleteFlash
- Flashing Membranes & Accessories

ADHERED MASONRY CONSTRUCTION

- LathNet
- Driwall
- WallNet

RESIDENTIAL CONSTRUCTION

MortarNet masonry wall solutions offer superior protection, enhancing the performance and life of residential masonry structures.



MortarNet products are essential for residential construction because they ensure proper moisture management and long-term durability of masonry construction. By preventing water intrusion and promoting airflow within the cavity wall or drainage plane, our products help keep walls dry and performing as designed.



Collection

MORTAR

CAVITY WALL CONSTRUCTION



- 1 MortarNet
- 2 WeepVent or CellVent
- 3 Flashing Membrane
- 4 Termination Bar
- 5 Drip Edge

MortarNet™
—With Insect Barrier™

MortarNet™
—With Insect Barrier™

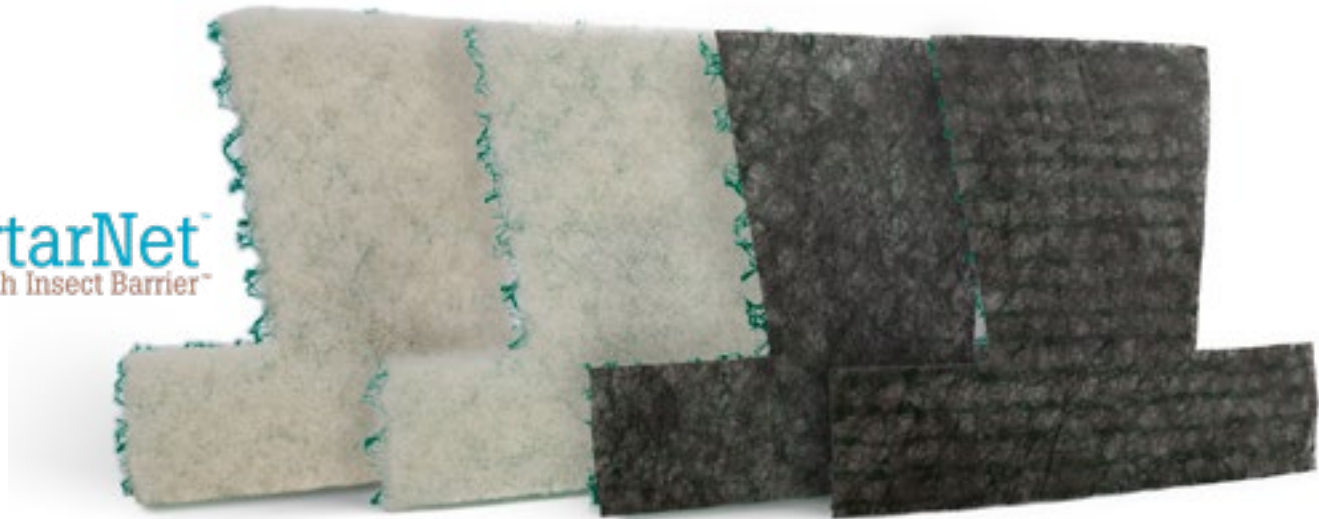

Available in **2-inch**, **1-1/2-inch**, **1-inch**, and **3/8-inch** nominal thicknesses.



MortarNet™
—WallDefender

- Dovetail shape breaks up and suspends mortar droppings in cavity walls on two levels so moisture can drain to the open weeps
- Structured strand deign provides countless pathways for water to flow to weeps
- Available in 3/8-inch, 1-inch, 1-1/2-inch, and 2-inch nominal thicknesses



HouseNet®

- Residential mortar dropping collection device
- Dovetail shape breaks up and suspends mortar droppings in cavity walls on two levels so cavity moisture can drain to the weeps
- Patented insect barrier helps eliminate insect infestations
- Structured strand deign provides countless pathways for water to flow to weeps
- Available in 3/8-inch and 1-inch nominal thicknesses

*Insect Barrier U.S.
Patent No. 8,061,090

Shape: Trapezoidal shape breaks up and suspends mortar droppings above the flashing so weeps stay open
Material: 0.4" & 1"- structured strand mesh bonded to polyester fabric, 1-1/2" & 2"- structured strand mesh bonded to hi-loft mesh
Preventative: Helps prevent efflorescence and damage from freeze-thaw cycles
Permeable: Air, water and water vapor drain easily due to the low fiber density of the non-woven structure
Compressible: Allows for variations in cavity width
Exposure: Will not degrade, oxidize or react with common building materials
Multi-story: Installs easily on brick ties in cavity walls

Cav-Air-Ator®



- Full wall drainage and ventilation mat brick and stone masonry walls
- Prevents mortar droppings from entering the cavity and clinging to wall ties or blocking weep holes
- Available in 3/8-inch, 3/4", 1", and 1-3/4" thicknesses
- Manufactured in 16" x 4' strips

MortarDeflection™

- Straight strip mortar collection device designed to catch and hold mortar droppings
- Structured strand design provides countless pathways for water to flow to weeps
- Available in 3/8-inch & 1-inch, and 2-inch thicknesses.



WeepVent™ & CellVent™

Keeps Weep Holes Open, Insects and Debris Out

- WeepVent and CellVent ensure that moisture can migrate out and air can flow in providing a path for moisture to drain to the exterior face of the wall which will accelerate drying
- Can be placed at the top and bottom of the wall allowing air to circulate in the cavity keeping the wall drier
- WeepVent is made of 90% open-weave mesh
- CellVent is made of durable polypropylene

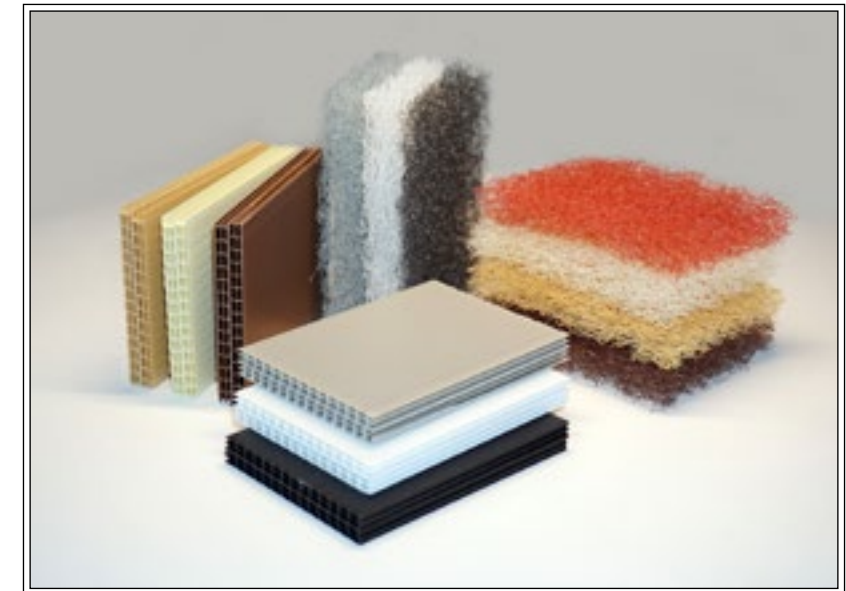

CellVent™

Available in black, brown, cocoa, tan, gray, white, clear.

WeepVent™

Available in brown, tan, red, almond, white, gray, black, and pebble.

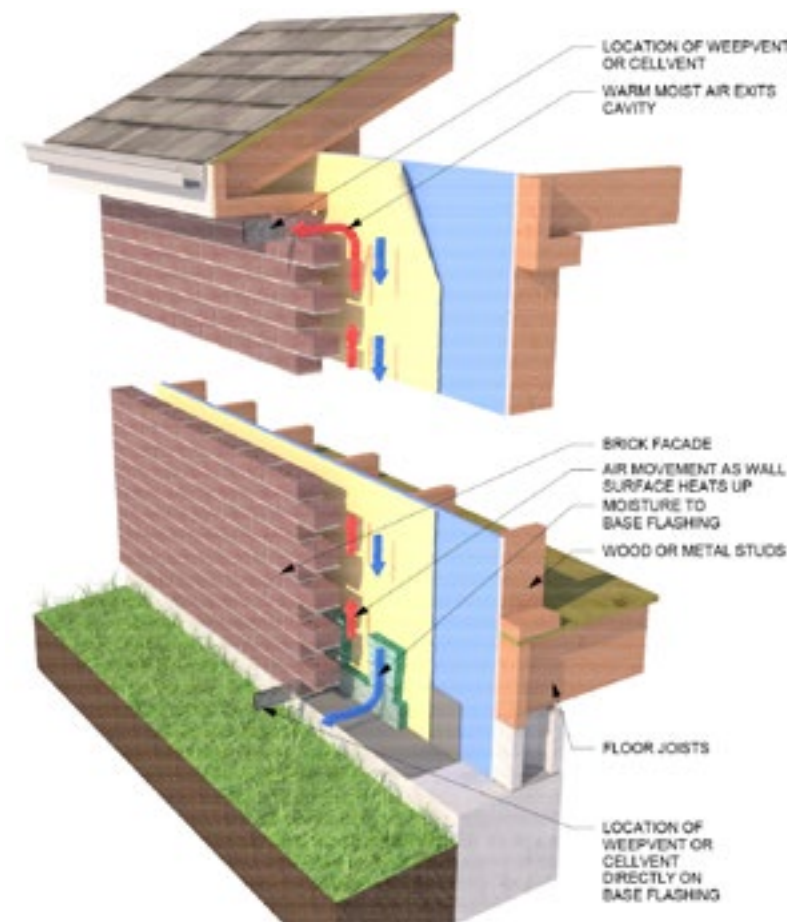

Flashing

CAVITY WALL FLASHING SYSTEM

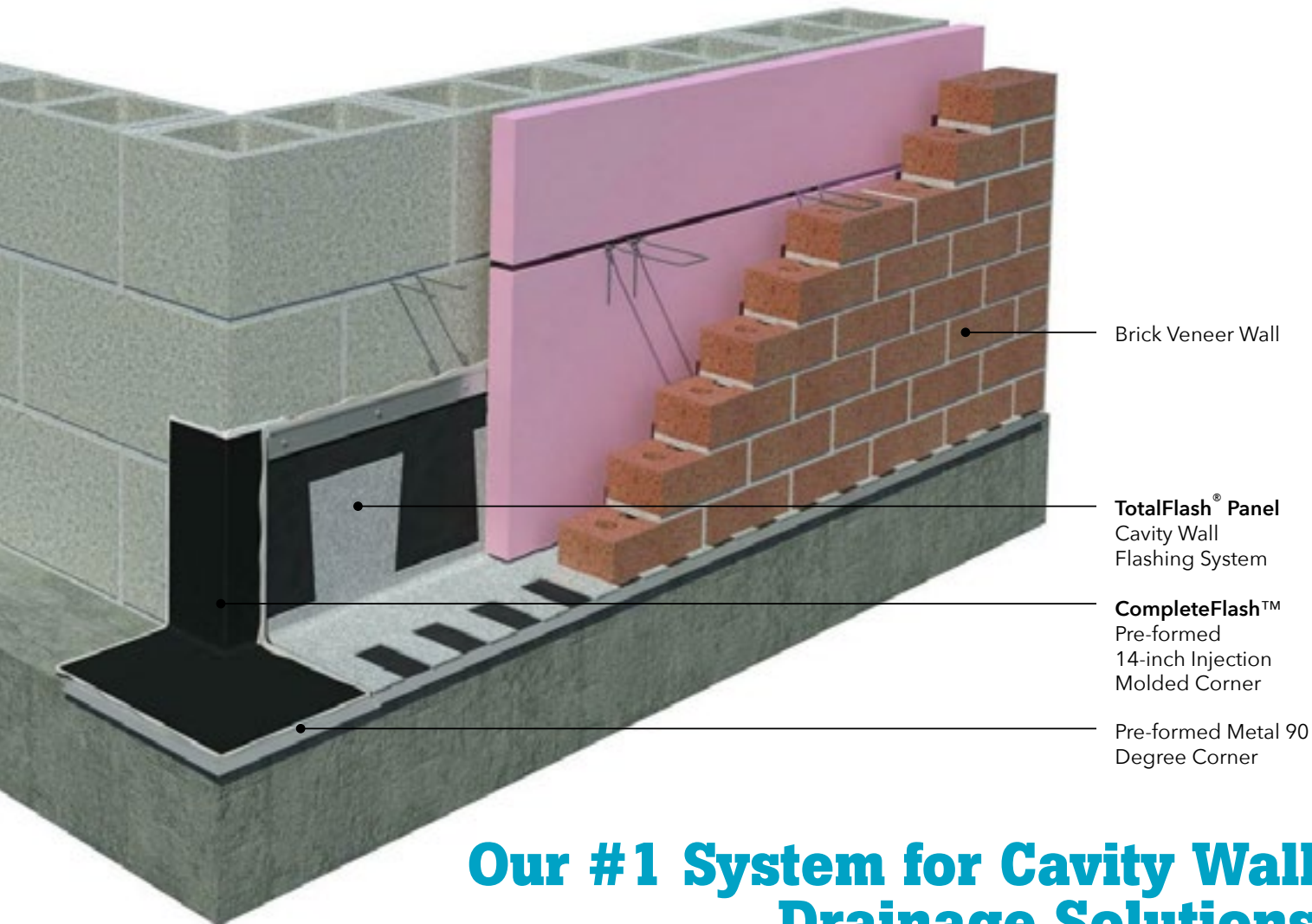

Our #1 System for Cavity Wall Drainage Solutions

Each TotalFlash® System contains a membrane with a no-clog mortar-dropping collection drainage mat, weep tabs, drip edge, termination bar with pre-drilled holes, and fasteners, all built into a single easy-to-install system.

Time savings: Cuts installation time by at least 50% compared to field-installed flashing pieces and parts

Restoration: Ideal for restoration projects with a variety of standard and custom sizes

Support: More than just a product. Every awarded TotalFlash job includes expert takeoff and assistance.

Water-tight: Proven overlap and termination method quickly and easily creates air- and water-tight lap joints and terminations

Repetitive openings: Pre-assembled, custom-sized panels designed specifically for the opening's conditions.

U.S. Patent No. 7,543,414

One System. One Source. TotalFlash®

TotalFlash®

Factory-Assembled Masonry
Cavity Wall Flashing Panel System

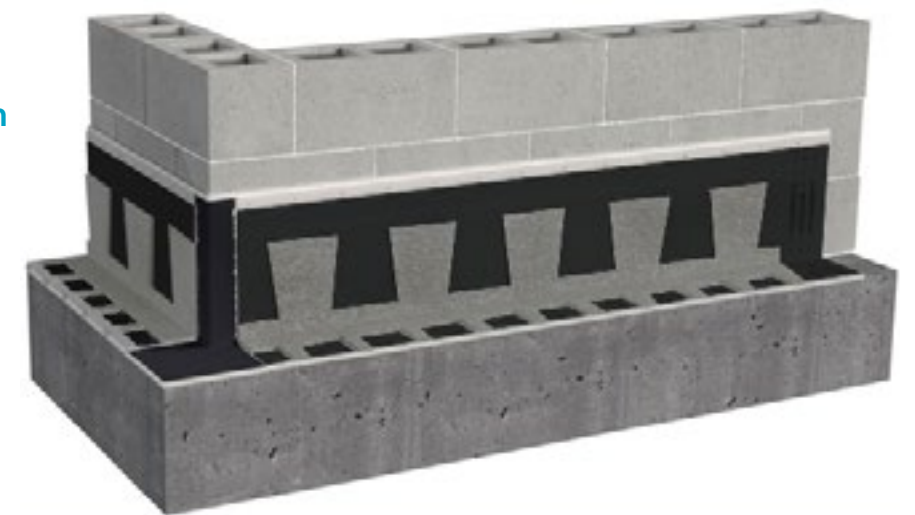

- Pre-assembled 5-foot 6-inch panels (5-foot net) with membrane, drip edge, 90% open-weave drainage mesh, anchor screws and termination bar to ensure all components are installed in the wall
- Pre-assembled panels can be custom sized to fit all masonry openings, such as door and window openings
- Optional membranes, drip edges, and termination bars available
- Combine with CompleteFlash pre-formed injection molded corner boots and end dams, metal corners, BTL-1 sealant, and WeepVent or CellVent to complete the system

TotalFlash®

Factory-Assembled Masonry
Cavity Wall Flashing Roll System

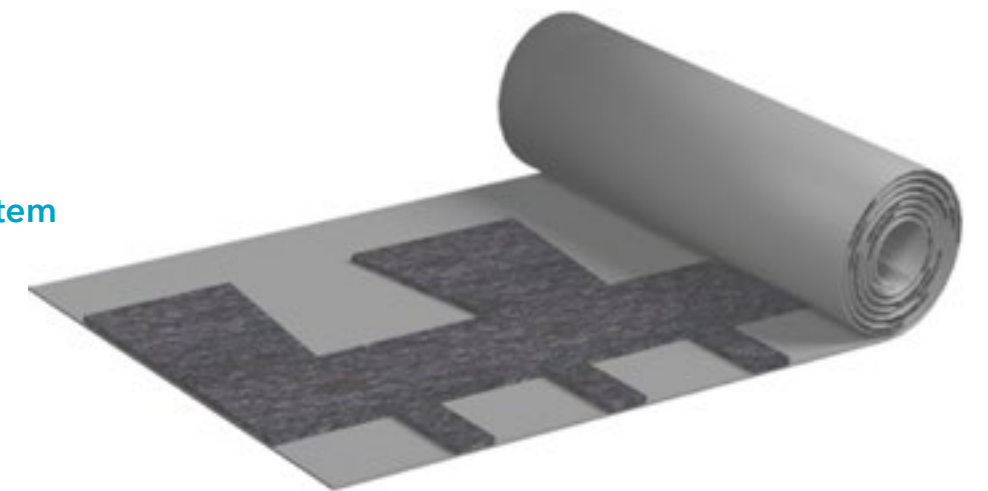

- Pre-assembled system combines flashing membrane, 90% open-weave drainage mesh and weep tabs into a single easy-to-install 50-foot roll
- Customizable with various membranes
- Combine with CompleteFlash pre-formed injection molded corner boots and end dams, termination bar, drip edge, metal corners, BTL-1 sealant, and WeepVent or CellVent to complete the system

Flashing

CAVITY WALL FLASHING SYSTEM

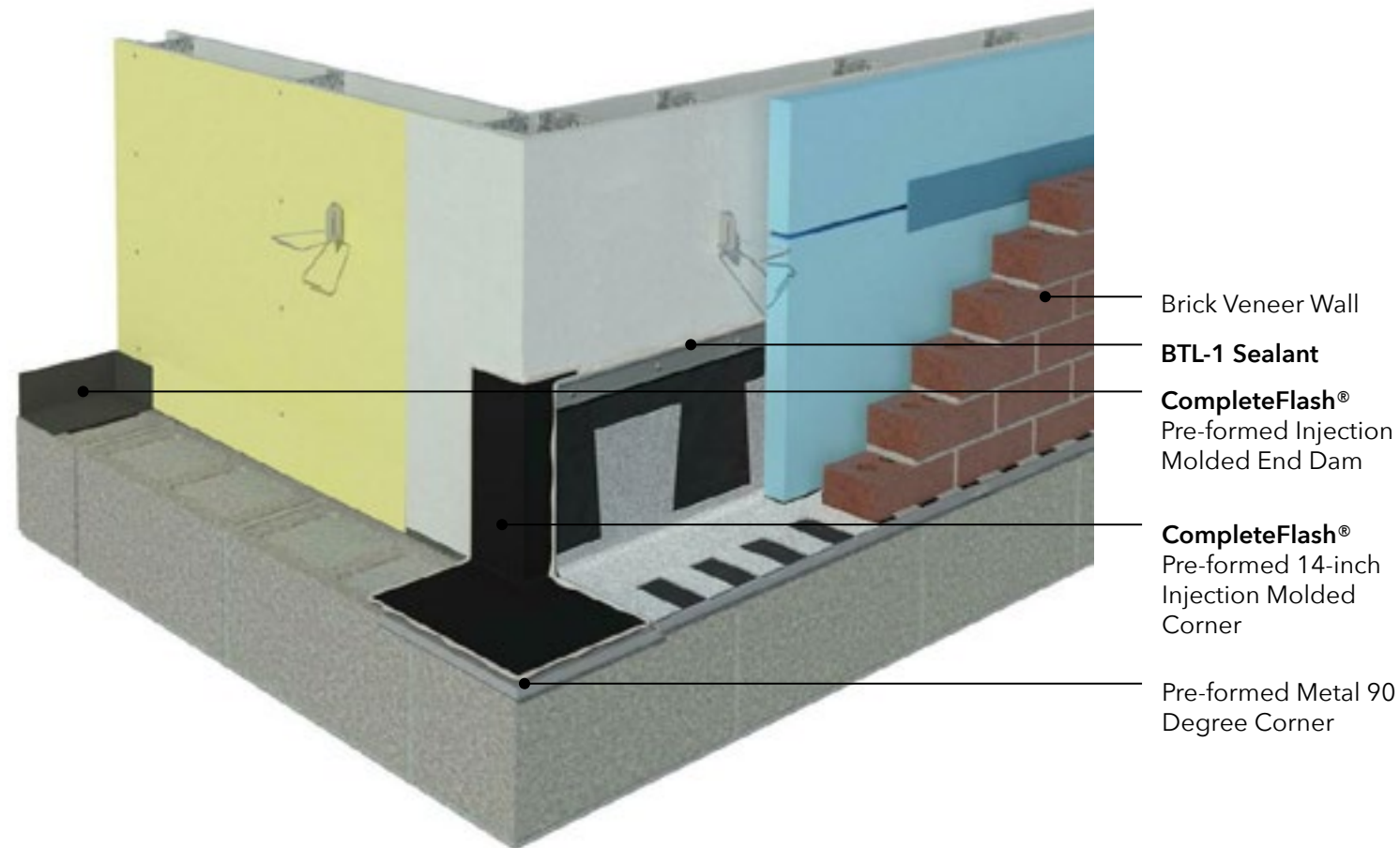

CompleteFlash® Pre-formed Inside/Outside Corner Boots and End Dams

- Injection molded seamless end dams and corner boots for complete moisture protection
- Eliminates the uncertainty of field fabrication
- Available in thermoplastic polyolefin (TPO) and synthetic rubber (SR) compatible with all membranes and air barriers on the market
- 14-inch tall Inside and Outside Corner Boots provide one piece protection
- End Dams available in 4-inch and 6-inch widths to fit most bed depths



Metal Drip Edge

Use with Conventional Flashing, TotalFlash, and CompleteFlash®

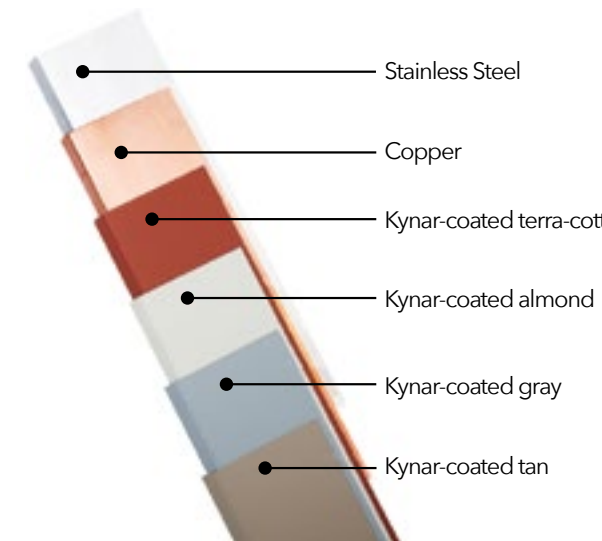

- Available in 26 or 28-gauge 304 stainless steel, 24 gauge cold-rolled copper, and four colors of 24 gauge Kynar®-coated galvanized steel
- All drip edges are made with a factory hemmed edge (flat profile also available)
- Available in 1-1/2 and 3-inch wide x 8-foot lengths

Metal Corners

Use with Conventional Flashing, TotalFlash, and CompleteFlash®

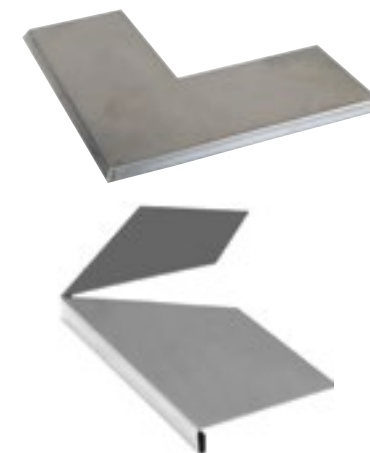

Pre-formed Metal 90 Degree Corner

- Available in 26 gauge stainless steel, 24 gauge cold-rolled copper, and four colors of 24 gauge Kynar®-coated galvanized steel
- Creates a clean looking corner and eliminates sharp corner edges

Adjustable Inside/Outside Metal Corner

- Adjustable from 22 degrees to 325 degrees to fit custom requirements (US Patent No. 9,151,039)
- Available in 28 gauge stainless steel, 24 gauge cold-rolled copper, and four colors of 24 gauge Kynar®-coated galvanized steel

BTL-1 Synthetic Rubber Butyl Sealant

- Permanently elastic and tacky
- Bonds aggressively to all types of flashings, masonry materials, types of metal, sheathing (wood or composite materials found in flashing applications)
- Low VOC, no primer required, excellent chemical resistance, and can be installed in temperatures between 40 and 95 degrees Fahrenheit



Flashing

CAVITY WALL CONSTRUCTION

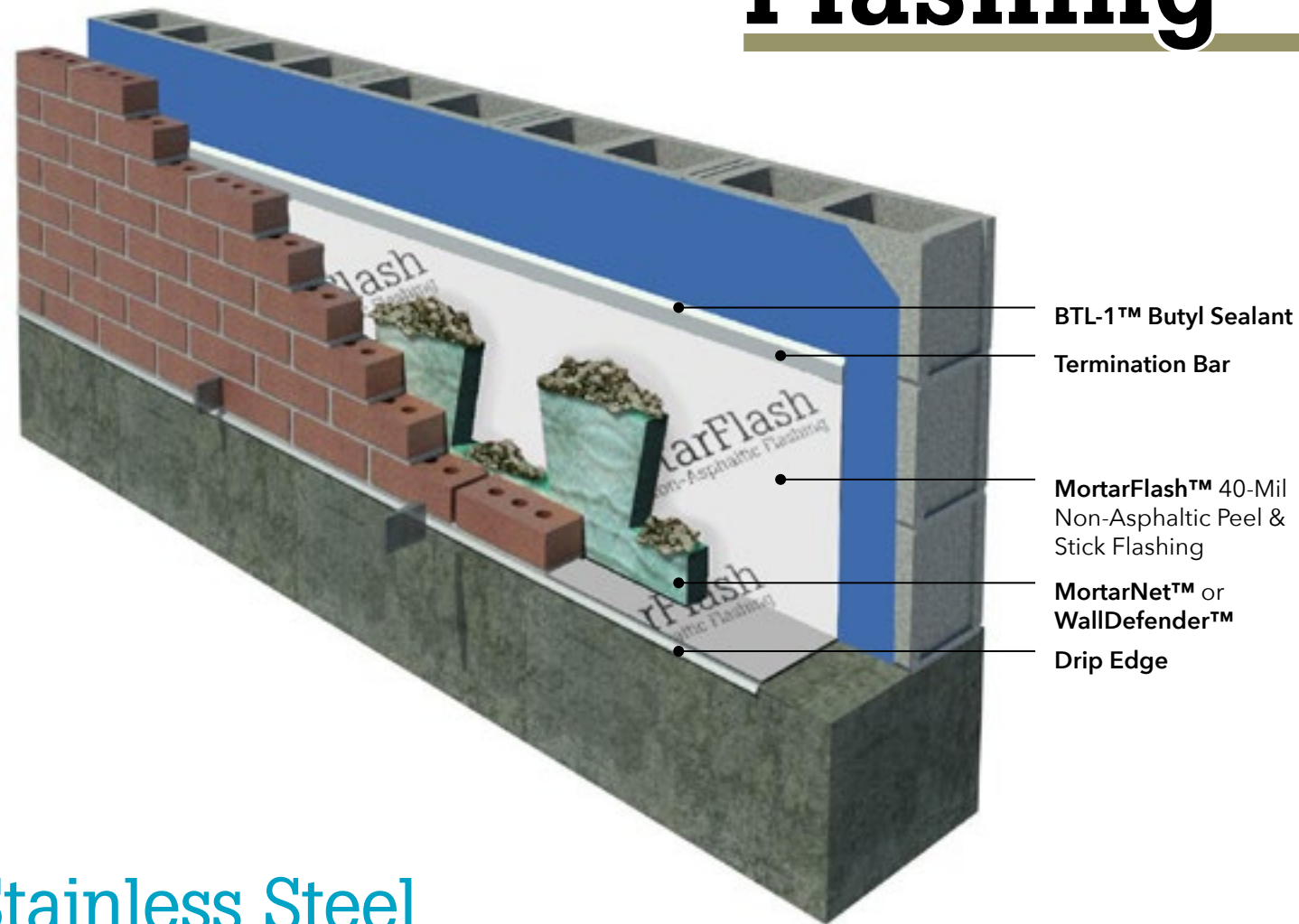

Stainless Steel Corners & End Dams

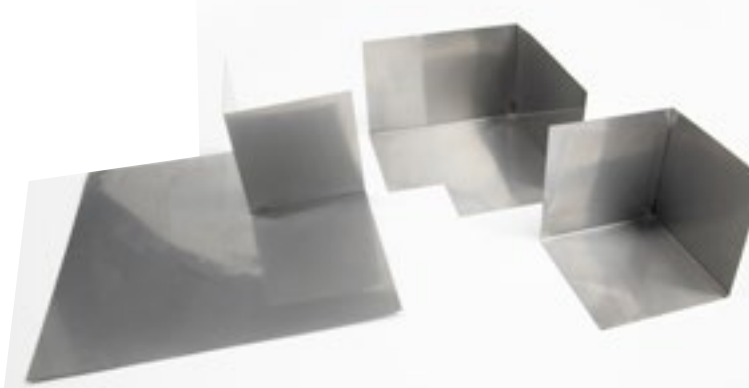

- Use with Conventional Flashing and TotalFlash
- Manufactured from 26-gauge Type 304 stainless steel for excellent durability
- Eliminates the uncertainty of field fabrication

Termination Bars™



- Use with Conventional Flashing and TotalFlash
- Permanently mechanically fastens flashings to substrate for the life of the structure
- Pre-drilled holes for mounting screws
- Available in High Density PVC, Stainless Steel, Stainless Steel with Lip, and Aluminum

MortarFlash™

– Non-Asphaltic Flashing



- 40-Mil Non-Asphaltic polyethylene blend peel-and-stick flashing membrane
- Applications to masonry, concrete, steel, gypsum, and wood
- Primer not required, however, we recommend the use of a termination bar, and a bead of sealant under the leading edge of the flashing
- Available in 9", 12", 16", 18", 20", 24", and 36" widths x 75' long

MortarFlash™

– Rubberized Asphalt Flashing

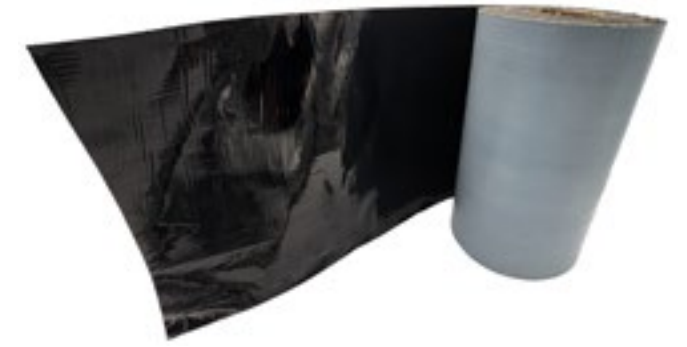

- 40-Mil Rubberized Asphalt peel-and-stick flashing membrane
- Adheres to most dry, clean surfaces including masonry, metal, wood, and vinyl
- Primer and termination bar is recommend, and a bead of sealant under the leading edge of the flashing
- Available in 12" & 18", and 24" widths x 75' long

MortarFlash™

– 20-Mil PVC Flashing



- 20-Mil PVC membrane designed for use as a low-cost alternative for concealed flashing applications
- Termination bar is recommend, and a bead of sealant under the leading edge of the flashing
- Available in 12", 16", 18", and 24" widths x 150' long

MortarFlash™

– Stainless Steel Flashing



- 0.003" thick stainless steel bonded to a polymeric fabric
- Termination bar is recommend, and a bead of sealant under the leading edge of the flashing
- Available in 12", 16", 18", 24", and 36" widths x 60' long

LathNet™

Drainage Plane and Metal Lath System for Adhered Masonry Veneers



- Factory-assembled self-furring dimpled metal lath with Driwall rainscreen drainage mat mechanically fastened with built-in overlap
- Designed for use with stucco, thin brick, thin stone, cultured stone and other types of adhered masonry
- Provides a continuous drainage plane and air flow between the scratch coat and weather resistant barrier
- Allows full lath encapsulation of scratch coat without clogging the drainage plane
- Available in 2.5 or 3.4 pound lath with 1/4-inch or 3/8-inch mesh

WallNet®

Continuous Drainage Plane Behind Rainscreen Systems, and Stone and Stucco Veneers

- 90% open-weave polyester mesh, provides countless pathways for water to flow to the flashing
- Provides continuous drainage behind all types of stucco, adhered masonry, rainscreen walls, and lap siding applications
- Available in 1/4-inch



Driwall™

Drainage Plane for Exterior Rainscreen Systems

- Extruded polymer matrix of tangled monofilaments bonded to a non-woven, breathable fabric
- May eliminate the need for a second layer of weather resistant barrier (check local codes)
- Provides continuous drainage behind all types of stucco, adhered masonry, rainscreen walls, and lap siding applications
- Allows complete encapsulation of metal lath in all scratch coat applications
- Available in 1/8-inch, 1/4-inch, 3/8-inch, and 3/4-inch thicknesses

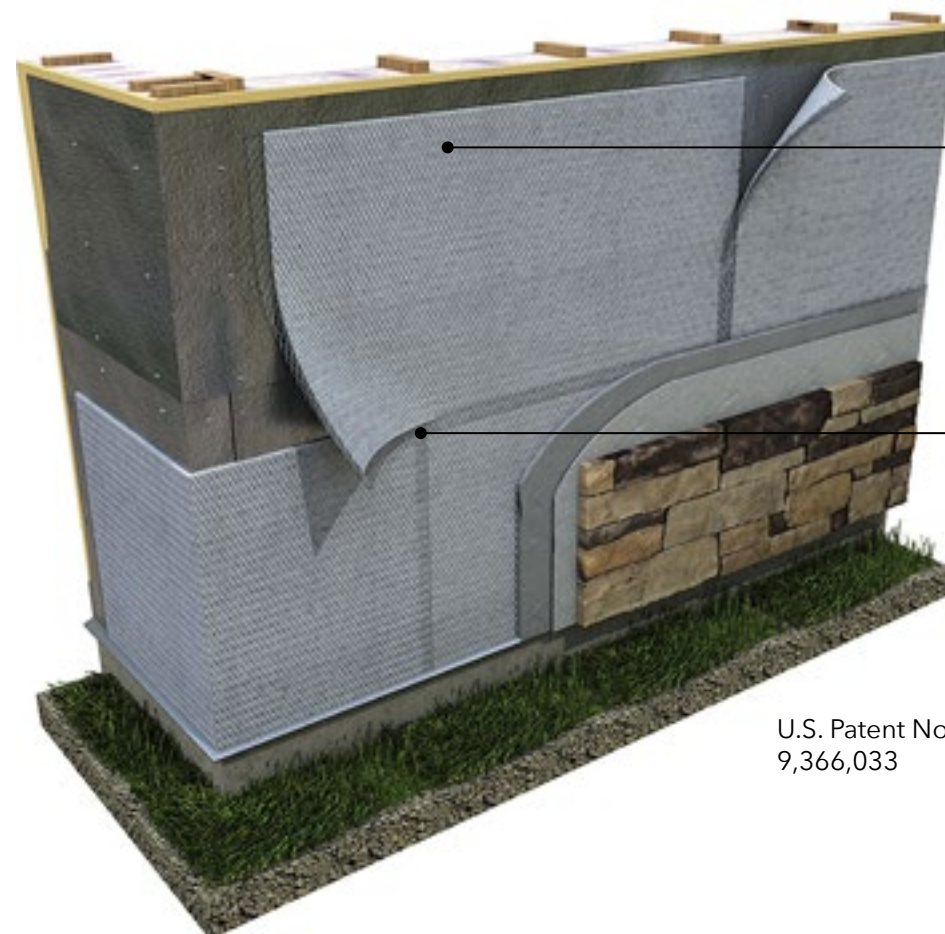

LathNet™
Combination lath & mechanically fastened drainage mat. May eliminate the need for a second layer of weather resistant barrier (check local codes)

Panels overlap shingle-style providing code compliant spacing on all vertical and horizontal joints

U.S. Patent No.
9,366,033

BlockFlash[®]

The Complete Flashing Solution for Single Wythe Concrete Masonry Unit Walls and Structural Brick



- Applicable in all CMU wall flashing locations, including base of wall, bond beams over masonry openings and within the walls, and over structural steel members at flashing courses
- Available for 6-inch, 8-inch, 10-inch, and 12-inch standard or insulated Concrete Masonry Units (CMU) and structural brick. Can also be used with core insulation systems
- Drainage Mat protects weep spout from clogging
- Eliminates the need for multiple architectural CMU sizes typical with step down through-wall flashings
- Provides 10 times greater bond strength at the base of the wall than a membrane through-wall flashing system

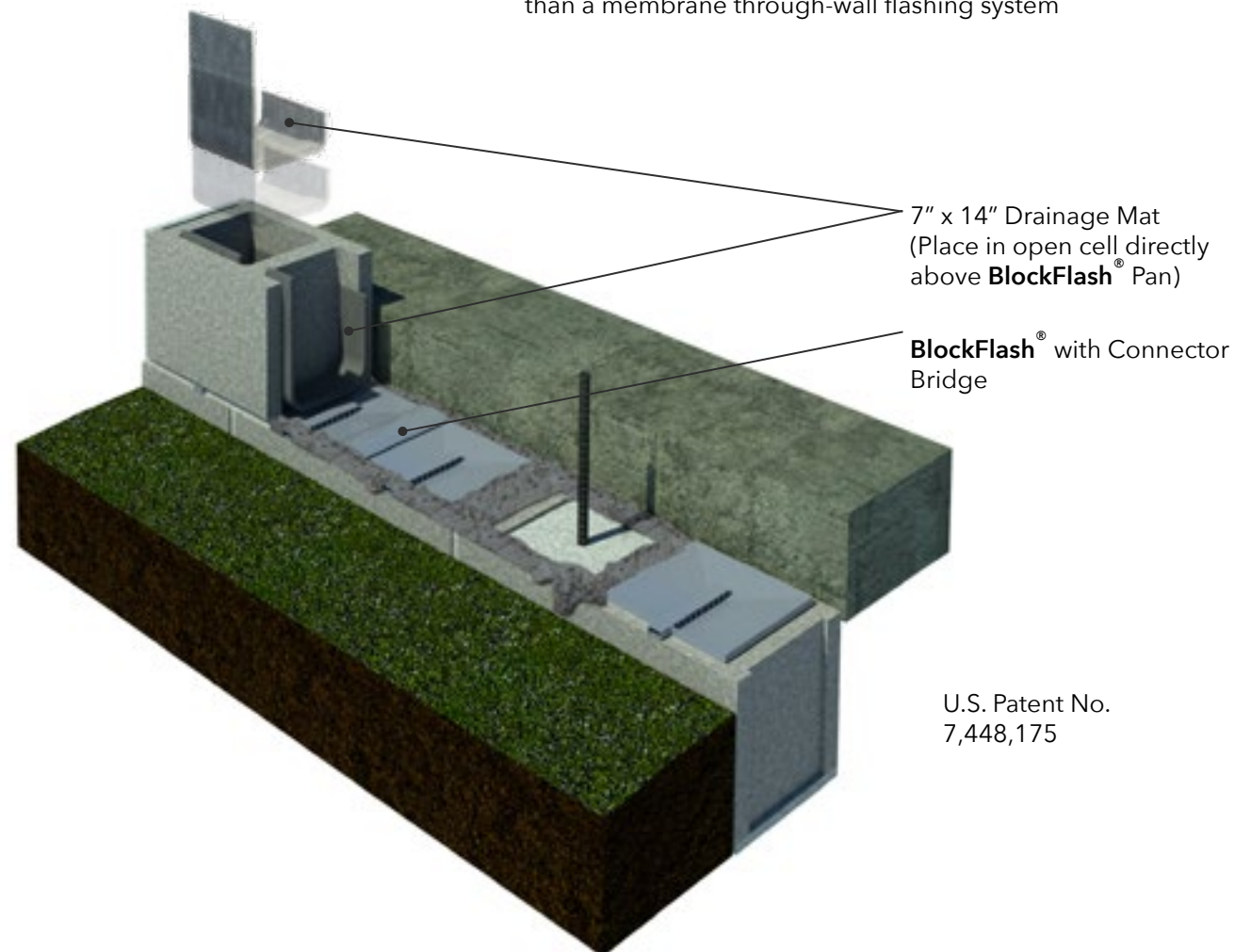

7" x 14" Drainage Mat
(Place in open cell directly
above **BlockFlash[®]** Pan)

BlockFlash[®] with Connector
Bridge

U.S. Patent No.
7,448,175

BlockNet[®]

Continuous Single Wythe Drainage System for Concrete Masonry Unit Walls



- Applicable in all flashing locations, including base of wall, at bond beams, over masonry openings and within the walls, and over steel structural steel members at flashing courses
- Can be installed in 8-inch, 10-inch and 12-inch fully grouted walls without reducing the effect of the reinforcing. Can also be used in 6-inch unreinforced walls.
- 28 gauge stainless steel drainage section collects moisture on a pitched drip edge and channels it to the exterior of the building through weep tabs placed every 4 inches

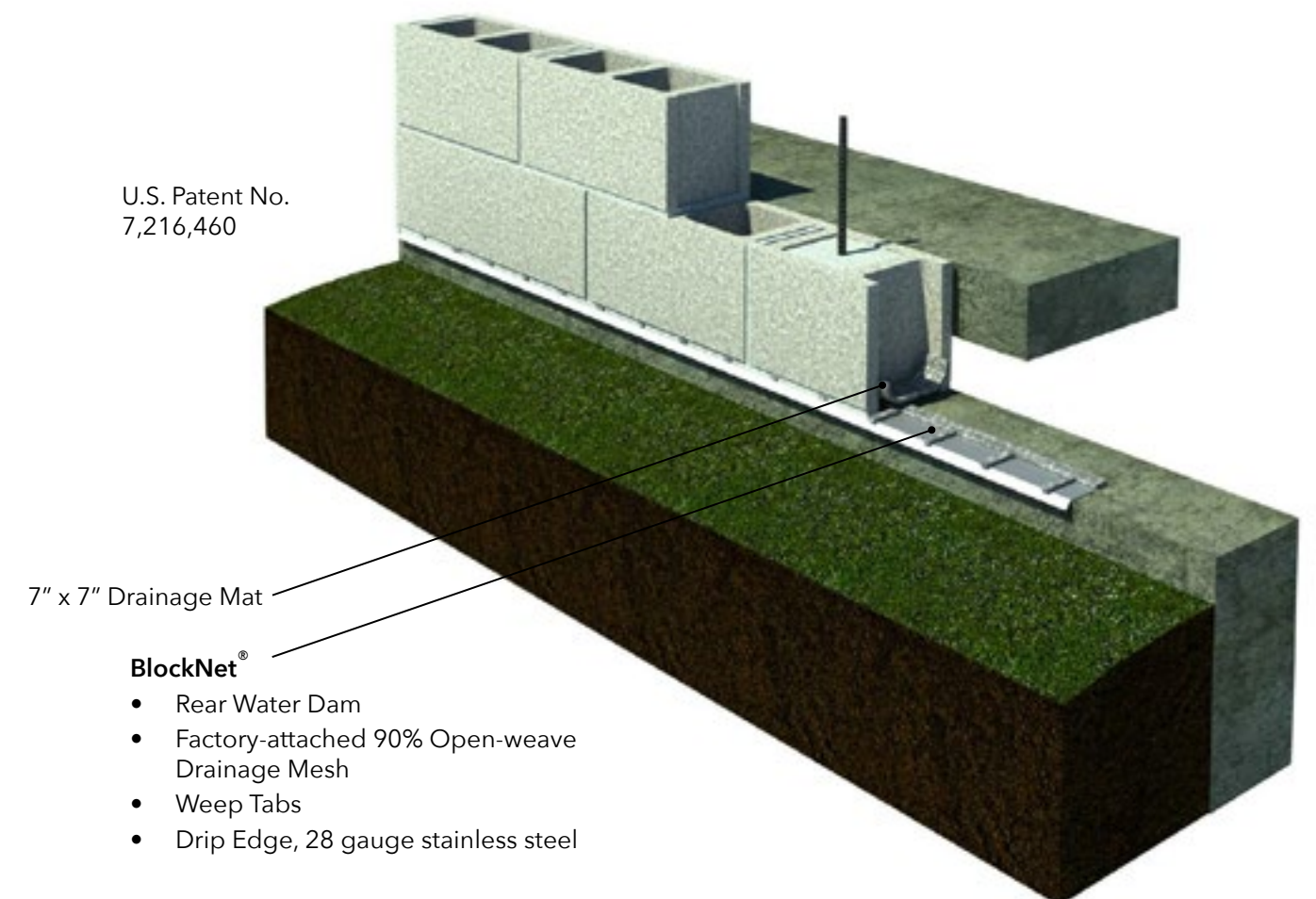

U.S. Patent No.
7,216,460

7" x 7" Drainage Mat

BlockNet[®]

- Rear Water Dam
- Factory-attached 90% Open-weave Drainage Mesh
- Weep Tabs
- Drip Edge, 28 gauge stainless steel

PRODUCT Information

PRODUCT SIZES AND PACKAGING INFORMATION



MortarNet with Insect Barrier™

Thickness	Height	Length	LF/Box
3/8"	10"	5'	250
1"	10"	5'	100
1-1/2"	10"	5'	100
2"	10"	5'	100

WallDefender®

Thickness	Height	Length	LF/Box
3/8"	10"	5'	100
1"	10"	5'	100
1-1/2"	10"	5'	100
2"	10"	5'	100

HouseNet™ with Insect Barrier™

Thickness	Height	Length	LF/Box
3/8"	7-3/4"	5'	80
1"	7-3/4"	5'	80

WeepVent™

Colors: Brown, Red, Tan, Almond, Gray, White, Black, & Pebble			
Thickness	Height	Length	Pieces/Box
1/2"	2-5/8"	3-1/2"	125
1/2"	3-1/2"	3-1/2"	125
1/2"	4"	4"	125
1/2"	2"	2"	125
1/2"	3-1/2"	7-5/8"	125
1/2"	2-1/2"	4"	125

CellVent™

Colors: Black, Brown, Cocoa, Tan, Gray, White & Clear			
Thickness	Height	Length	Pieces/Box
3/8"	2-1/2"	3-3/8"	200
3/8"	3-1/2"	3-3/8"	200

Metal Drip Edge Corners

Description	Size	Gauge
90 Degree Corner	3" x 7-1/2"	SS - 26 Kynar - 24 Copper - 24
Adjustable Corner 22 degrees to 325 degrees	3" x 7-1/2"	

*Kynar available in terra-cotta, almond, gray & tan. Please note: Kynar-coated and cold-rolled copper are special order and may have a lead time

TotalFlash® Panels

Height	Panel Length	Panels/Box	LF/Box
12"	5'-6"	10	50
18"	5'-6"	10	50
24"	5'-6"	10	50
Custom sizing and takeoffs available upon request			

TotalFlash® Rolls

Height	Length/Roll	Rolls/Box	LF/Box
12"	50'	3	150
18"	50'	2	100
24"	50'	1	50

CompleteFlash®

Available in Synthetic Rubber or TPO		
Description	Size	Pieces/Box
Inside Corner Boot	6" x 6" x 14"	25
Outside Corner Boot	6" x 10" x 14"	25
Universal End Dam	4" x 4" x 3"	50
Right/Left End Dam	4" x 6" x 3"	25 Left & 25 Right

Termination Bar

Description	Width	Thickness	Length
PVC	1"	1/8"	5'
304 Stainless Steel	1"	1/8"	8'
304 Stainless Steel w/Lip	1-1/2"	26 gauge	8'
Aluminum	1"	1/8"	8'
Aluminum w/Lip	1"	14 gauge	8'

Drip Edge

Description	Width	Thickness	Length
304 Stainless Steel	1-1/2"	26 gauge	8'
304 Stainless Steel	3"	26 gauge	8'
*Kynar-coated	3"	24 gauge	5'
Cold-rolled Copper	3"	24 gauge	5'

*Kynar available in terra-cotta, almond, gray & tan. Please note: Kynar-coated and cold-rolled copper are special order and may have a lead time

PRODUCT INFORMATION:
See our website MortarNet.com for the most up-to-date product information. **NOTE:** Published technical data & instructions are subject to change without notice. Please contact **Keene Building Products** for the most current technical data, safety data & application instructions. Keene Inc. and/or its affiliates assume no responsibility for any errors that may inadvertently appear in this document.

LET MAKE SAFETY FIRST!
Wear appropriate personal protective equipment. Read applicable PDS and product literature before specification and installation.

Stainless Steel Corners & End Dams

Description	Size	Gauge	Pieces/Box
Outside Corner Boot	10" x 10" x 4"	26 gauge	25
Inside Corner Boot	6" x 6" x 2"		25
End Dam	4" x 4" x 4"		50
End Dam	2" x 4" x 4"		50

Cav-Air-Ator®

Thickness	Height	Length
3/8"	16"	4'
3/4"	16"	4'
1"	16"	4'
1-3/4"	16"	4'

MortarFlash™ Flashing Membranes

40-Mil Non-Asphaltic

Thickness	Height	Length	SF/Box
0.040"	9"	75'	225
0.040"	12"	75'	225
0.040"	16"	75'	200
0.040"	18"	75'	225
0.040"	20"	75'	125
0.040"	24"	75'	150
0.040"	36"	75'	225

20-Mil PVC

0.020"	12"	150'	150
0.020"	16"	150'	200
0.020"	18"	150'	225
0.020"	24"	150'	300

40-Mil Rubberized Asphalt

0.040"	12"	75'	225
0.040"	18"	75'	225
0.040"	24"	75'	150

Stainless Steel

0.003"	12"	60'	120
0.003"	18"	60'	180
0.003"	24"	60'	120

MortarDeflection™

Thickness	Height	Length	LF/Box
3/8"	10"	50'	200
1"	10"	50'	200
2"	10"	25'	100

BTL-1™ Synthetic Rubber Sealant

Tube Size	Tubes/Case	LF Coverage/Case
10.3 oz	12	Approx. 100

ADHERED MASONRY PRODUCTS

LathNet™

Lath Weight	Mesh Thickness	Sheet Size	SF/Sheet
2.5#	1/4" or 3/8"	27" x 97"	17.3
3.4#	1/4" or 3/8"	27" x 97"	17.3

Driwall™

Thickness	Roll Size	SF/Roll
1/8"	48" x 100'	400
1/4"	48" x 65'	260
3/8" (10mm)	48" x 45'	180
3/4"	48" x 50"	200

WallNet®

Thickness	Roll Size	SF/Roll
1/4"	30" x 100'	250

SINGLE WYTHE PRODUCTS

BlockFlash™

Size	Pieces/Box	LF/Box
6", 8", 10", & 12"	100 pans & 100 drainage mats	Approx. 67

BlockNet®

Pieces/Box	LF/Box
20- 6' strips & 150 drainage mats	110 usable



Masonry Division of
Keene Building Products

Over 30 years of installations. Thousands of walls.
Not a single wall failure.