



HURRICANE IMPACT RATED

RTS-430I THERMALLY BROKEN STAINLESS STEEL WINDOWS AND DOORS



DESIGNED FOR COASTAL APPLICATIONS TO MEET HVHZ | ENERGY-EFFICIENT | DELICATE SIGHT LINES



MADE IN THE USA | [OPTIMUMWINDOW.COM](https://www.optimumwindow.com)



THIN SIGHT LINE THERMALLY BROKEN STEEL

Thermally broken steel windows and doors from a name that you can trust, ***Optimum Window Manufacturing Corp.*** Optimum Window's thin sight lines thermally broken steel windows and doors are durable and tested to surpass the competition in air, water and structural performance.

TABLE OF CONTENTS

Get To Know Us	4
Performance	10
General Specifications	12
Fixed Window: RTS-430i FX	12
Out-Swing Casement w/ Advantage Fork Latch: RTS-430i OC	13
Out-Swing Casement: RTS-430i OC	14
Out-Swing Single Casement Mulled to Fixed: RTS-430i OC	15
Out-Swing Double Casement Mulled: RTS-430i OC	16
Out-Swing French Casement: RTS-430i OC	17
Out-Swing Double Casement: RTS-430i OC	18
Out-Swing French Door: RTS-430i OD	19-20
Out-Swing Door: RTS-430i OD	23-24
Out-Swing Hopper w/ Roto/Fork Latches: RTS-430i PO	26
Out-Swing Awning w/ Pushout: RTS-430i PO	27
Options	28
Glazing Frame options and Mullions & Frame Legs	28
Finish	29-30
Window: Typical Elevations	31
Window Hardware	32-34
Door: Typical Elevations	35
Door Hardware	36-38
Typical Installation Details	39



Optimum Window Manufacturing Corp: Where style meets functionality.

Optimum Window is a family-owned business nestled in the town of Ellenville, in upstate NY. Established in 1985, our President, Candido Perez launched this ambitious enterprise in the Steel Window industry and has since become the largest and most diversified manufacturer of Fire-Rated and Architectural steel windows in the United States in this ever-evolving world.

Making continuous strides in the fenestration industry has been a consistent goal of Optimum Window. We utilize state-of-the-art technology to maintain the quality, precision and craftsmanship our clients have come to depend on over the years. We have also made becoming a "greener" institution a priority, while taking initiatives to reduce waste and use 100% recycled steel for our multitude of versatile systems.

We pride ourselves on custom making each unit as ordered in house at our upstate facility so that every piece features the unique perspective of each of our clients. Our Manhattan Design Studio also provides an opportunity for us to showcase an array of options to those that may wish to get a better idea of Optimum Window's endless design possibilities. Whether your project is residential, commercial or even a landmark application, we can create the steel windows and doors that would best meet your needs.

Another source of Optimum Window's pride can be traced back to editorials in such publications as Architectural Digest, Elle Design and Mountain Living, just to name a few. We are also happy to boast that we ship our products nationwide and beyond. Through creative ingenuity from our fantastic team, the use of custom-made specifications on a per job basis allows for maximum innovation to shine through on all collaborations, be it with architects, builders, and even homeowners.



RTS430i

Optimum's Thermally Broken Technology in the form of the RTS430i line, is renowned for its thin sight lines and beauty. The RTS430i also offers reliability, versatility and thermal efficiency. Having surpassed vigorous testing requirements, the RTS430i is NFRC Certified. Optimum continues to work with architects that require custom designs for their applications, bringing performance and structural excellence together seamlessly; combining beauty and style with strength and reliability through the use of new computerized machinery for cutting, welding, punching, etc. All products are custom-made per specifications and approved shop drawings.

THERMALLY BROKEN STAINLESS STEEL: HURRICANE IMPACT

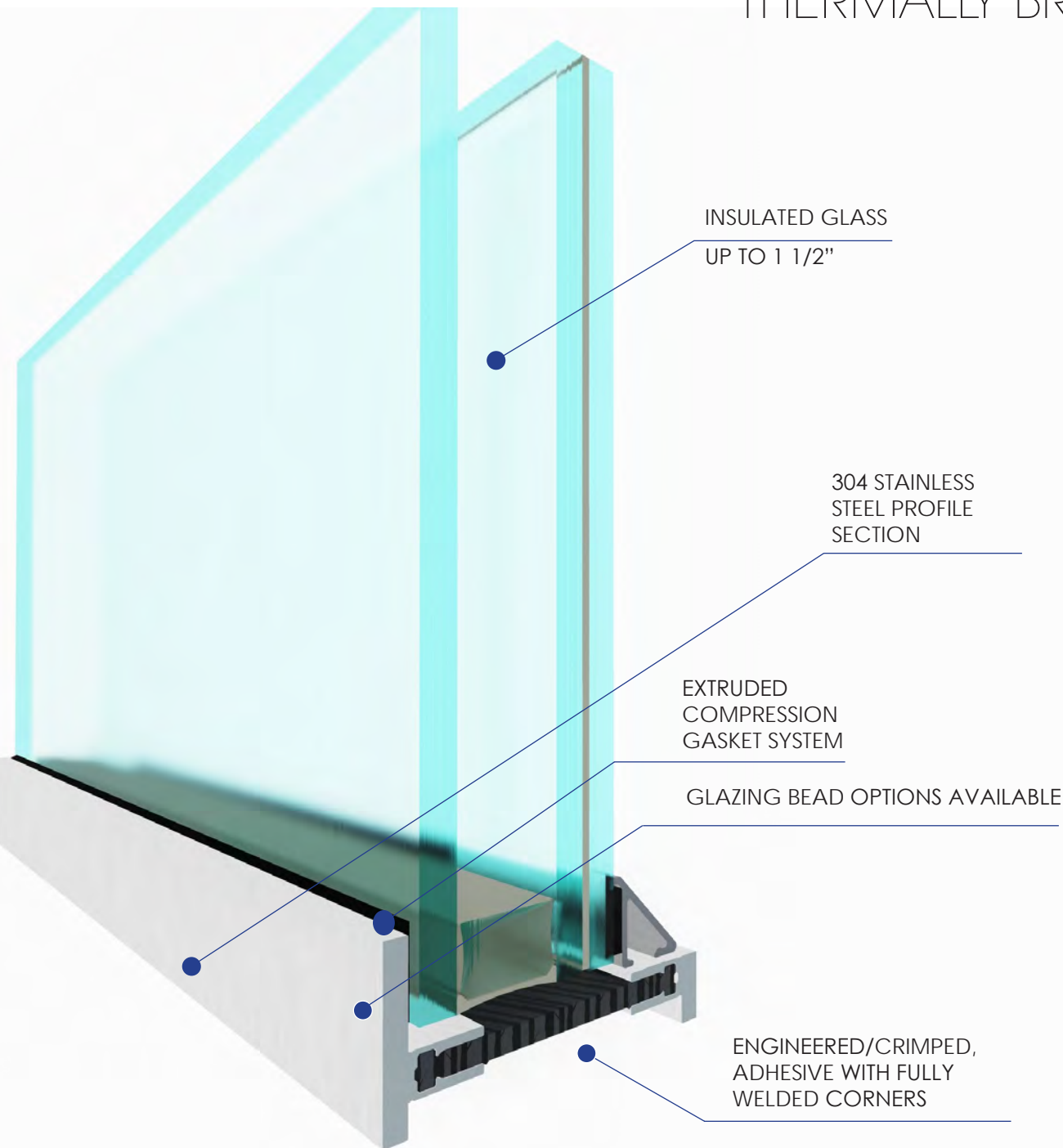

HANDCRAFTED HISTORICAL STEEL PERFECTION

STRUCTURAL MULLION

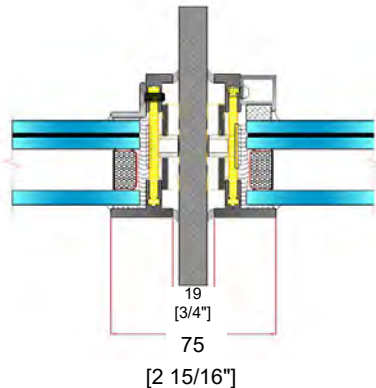

FIXED WINDOW

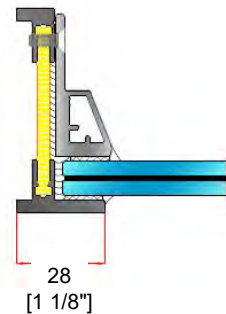

OPERABLE WINDOW & DOOR

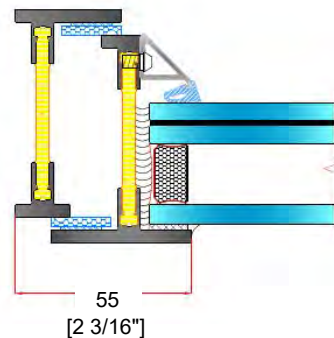

Having been featured in Architectural Digest for numerous appearance as well as other prestigious publications, Optimum Window Manufacturing has proven itself time and time again, offering the very best in steel window and door selections. Our rigorous testing ensures that our customers are receiving premium products. Mechanically bonded rather than utilizing glue adhesive like other window companies, our Thermally Broken Windows offer years of service, as well as timeless beauty and dynamic strength.

Note: Placement and depth can vary based on design pressures.





RTS430i Series Thermally broken steel windows and doors manufactured in Ellenville, New York by skilled craftpeople. It provides great energy performance that meets NFRC Rating and exceeds on steel performance (Air & Water) .

GLAZING OPTIONS:

DESIGN FLEXIBILITY

- MONOLITHIC GLAZED
1 1/16" Laminated Glass
- DUAL GLAZED
1/4" individual panes with 5/8" air space for 1 1/8" over all glass thickness (**standard product)
- TRIPLE GLAZED
1 3/8" over all glass thickness
- MUNTINS
available in either simulated Divided Lite (SDL) or True Divided Lite (TDL)

GLAZING OPTIONS

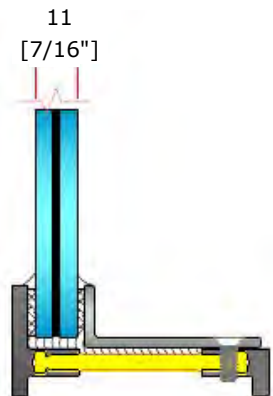

GB-IM2

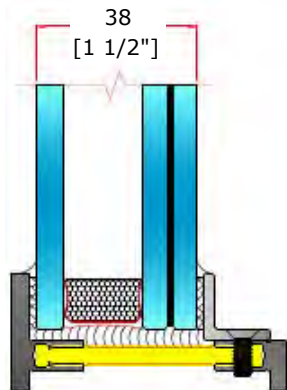

GB-18

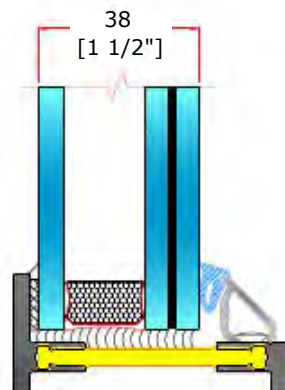

GB-20

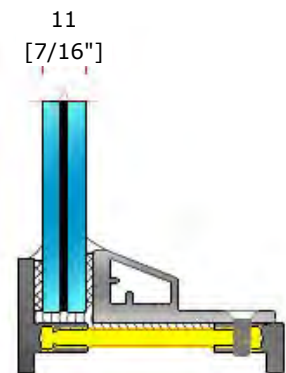

GB-IM1

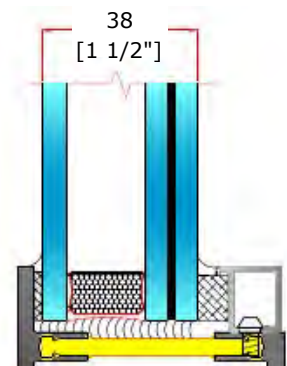

GB-31

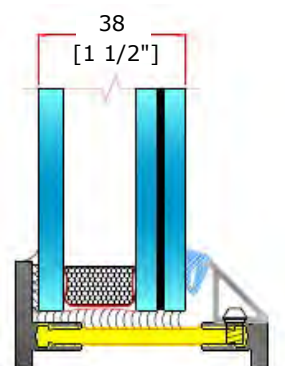

GB-35

INTERIOR GLAZED

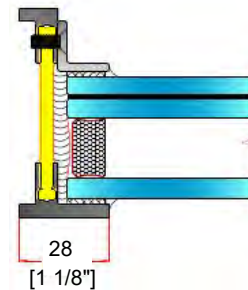

SASH

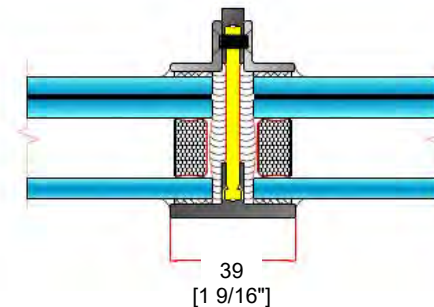

TDL MUNTIN

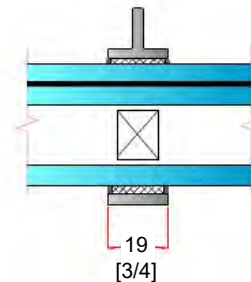

SDL MUNTIN

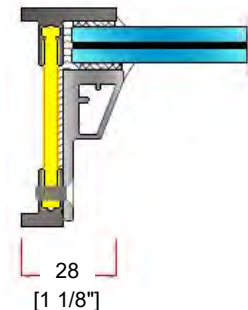

28
[1 1/8"]

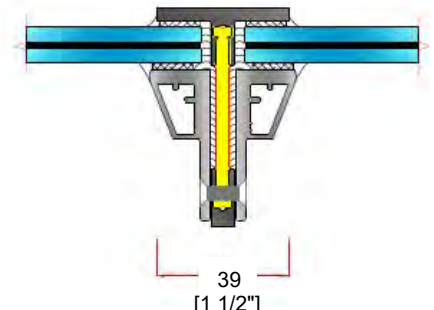

39
[1 1/2"]

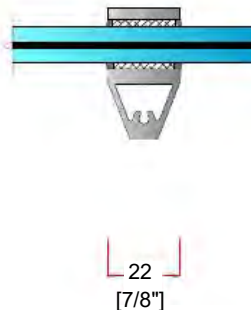

22
[7/8"]

EXTERIOR GLAZED

PERFORMANCE



Out-swing Casement Window
Dual Glazed IGU
7/16" Laminated Glass with
0.90" SGP Interlayer
(3/16" HS-0.090" SGP Interlayer
3/16" HS/13/16" Air Space 1/4"
Tempered Glass

Energy Performance Ratings

U-Factor (U.S./I.P.)

Casement: 0.24
Projected: 0.24
Fixed: 0.18
Door: 0.22

Solar Heat Gain Coefficient

Casement: 0.18
Projected: 0.18
Fixed: 0.22
Door: 0.19

Additional Performance Ratings

Visible Transmittance

Casement: 0.41
Projected: 0.41
Fixed: 0.51
Door: 0.43

Condensation Resistance

Casement: 45
Projected: 46
Fixed: 51
Door: 42

Model/Type: RTS-430i Steel Out-Swinging Casement

Summary of Results

Air Filtration Per Area 300 Pa (6.24 psf)	0.06 cfm/ft 0.06 cfm/ft
Water Penetration Resistance	9.75 psf 9.75 psf
Design Pressure	65 psf 65 psf



AMAZINGLY ENERGY EFFICIENT

THERMAL PERFORMANCE

- NFRC Certified
- U-Values as low as .19
- The best Energy Performance in the steel window industry rivaling high performance wood windows

CONDENSATION RESISTANCE

- Thermally Broken design greatly reduces the chance of condensation seen with most steel and aluminum window constructions
- Product has gone through condensation resistance "CR" testing with results similar to high-performance windows.

RECYCLED STAINLESS STEEL CONSTRUCTION

- Steel is a very eco-friendly product. Optimum's aim is to provide the best windows & doors while protecting our environment.

THIRD PARTY TESTING

- Our product has gone through extensive independent engineering testing for air Infiltration, water Infiltration, and structural testing.
- Optimum Window Mfg. meets or exceeds steel windows industry standards in all of these categories

ACOUSTICAL (OPERABLE) SPACE



RTS430i

GENERAL STEEL SPECIFICATIONS

MATERIAL: 304 stainless steel

GLAZING

TYPE: Single / Double / Triple

GLASS: 3/16 Solar Ban 70 3/16 Sungate 500 Argon Gas .24 SPACER:

Warm-edge, Dark Bronze

THICKNESS: 1 1/8 to 1 1/2 Insulated Glass

GLAZING FRAME

ORIENTATION: Exterior (interior available)

DETAIL: Sloped Bevel (other glazing beads available)

MUNTIN: Specify: None, SDL, and options for TDL upon review

FRAME DEPTH: 1 7/8"

FINISH: Super Durable Powder Coating /Epoxy Primer, Specify color. Available in 2605 and 2605 Finish options.

RTS430i-FX

FIXED WINDOW

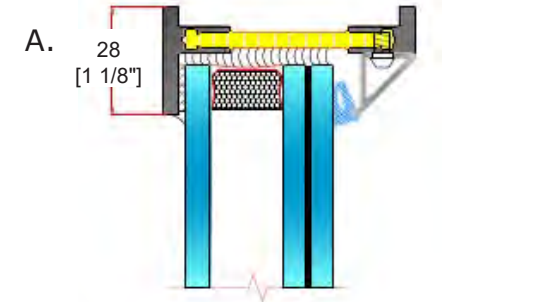
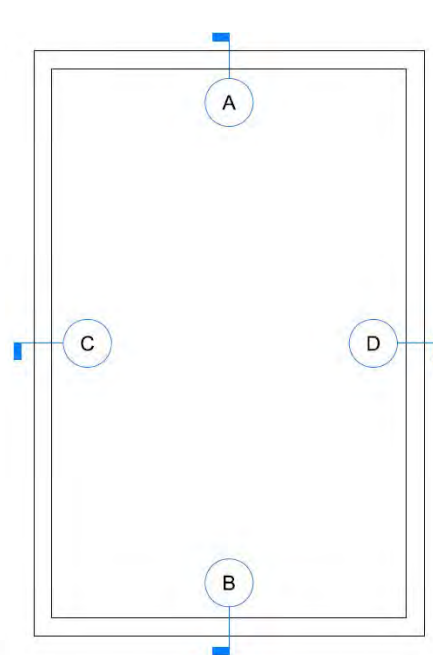

EXTERIOR

INTERIOR

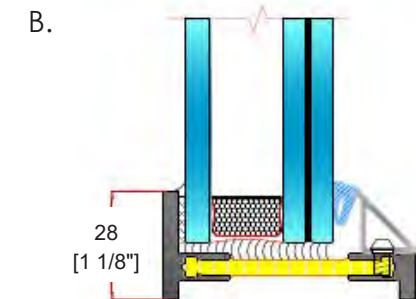

C.

INTERIOR

D.

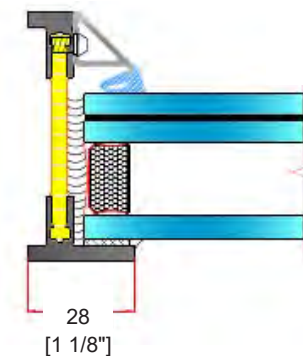

EXTERIOR

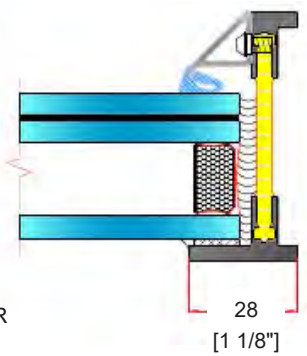

RTS430i-OC

OUT-SWING CASEMENT WITH ADVANTAGE FORK LATCH

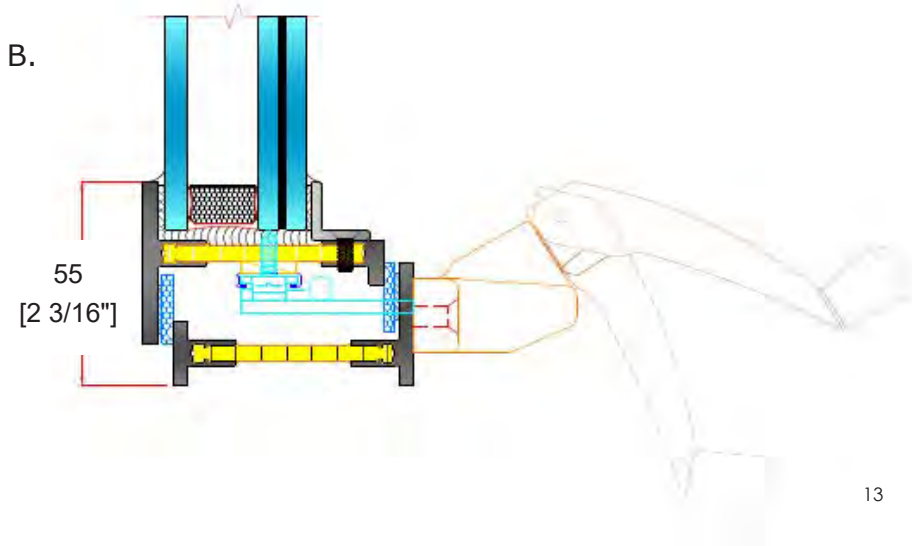
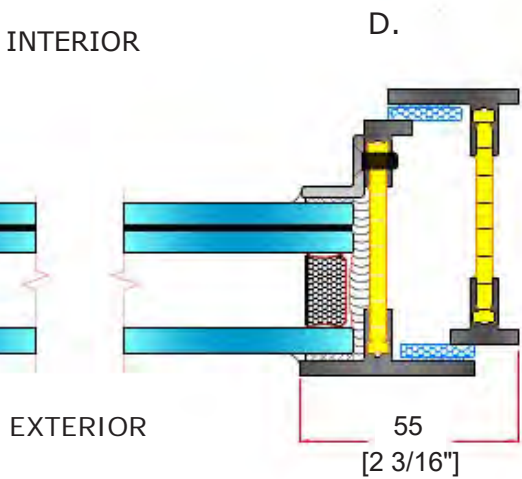
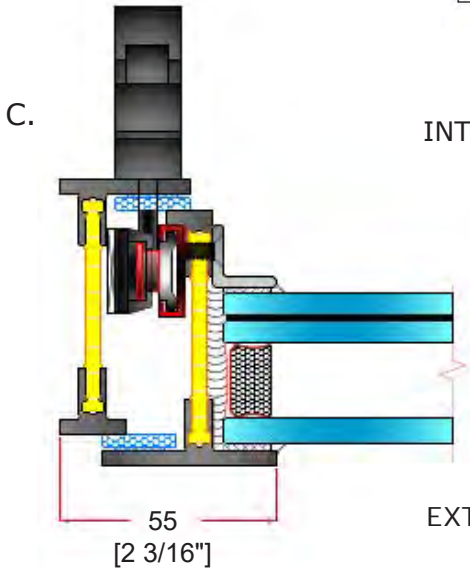
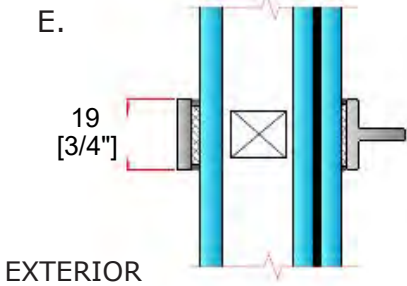
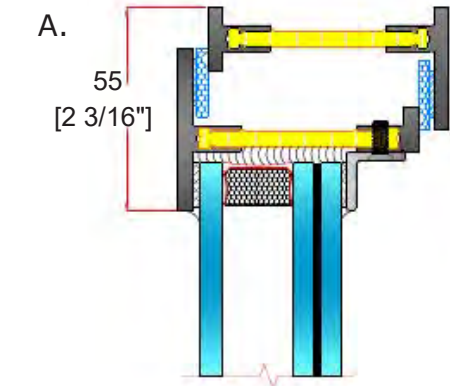
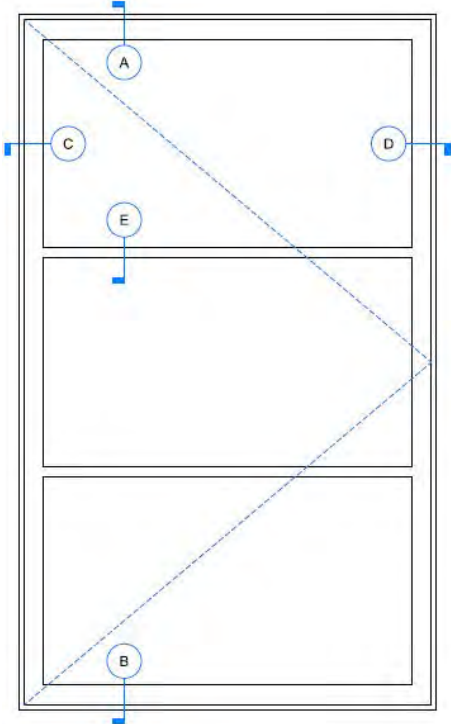

RTS430i-OC

OUT-SWING CASEMENT

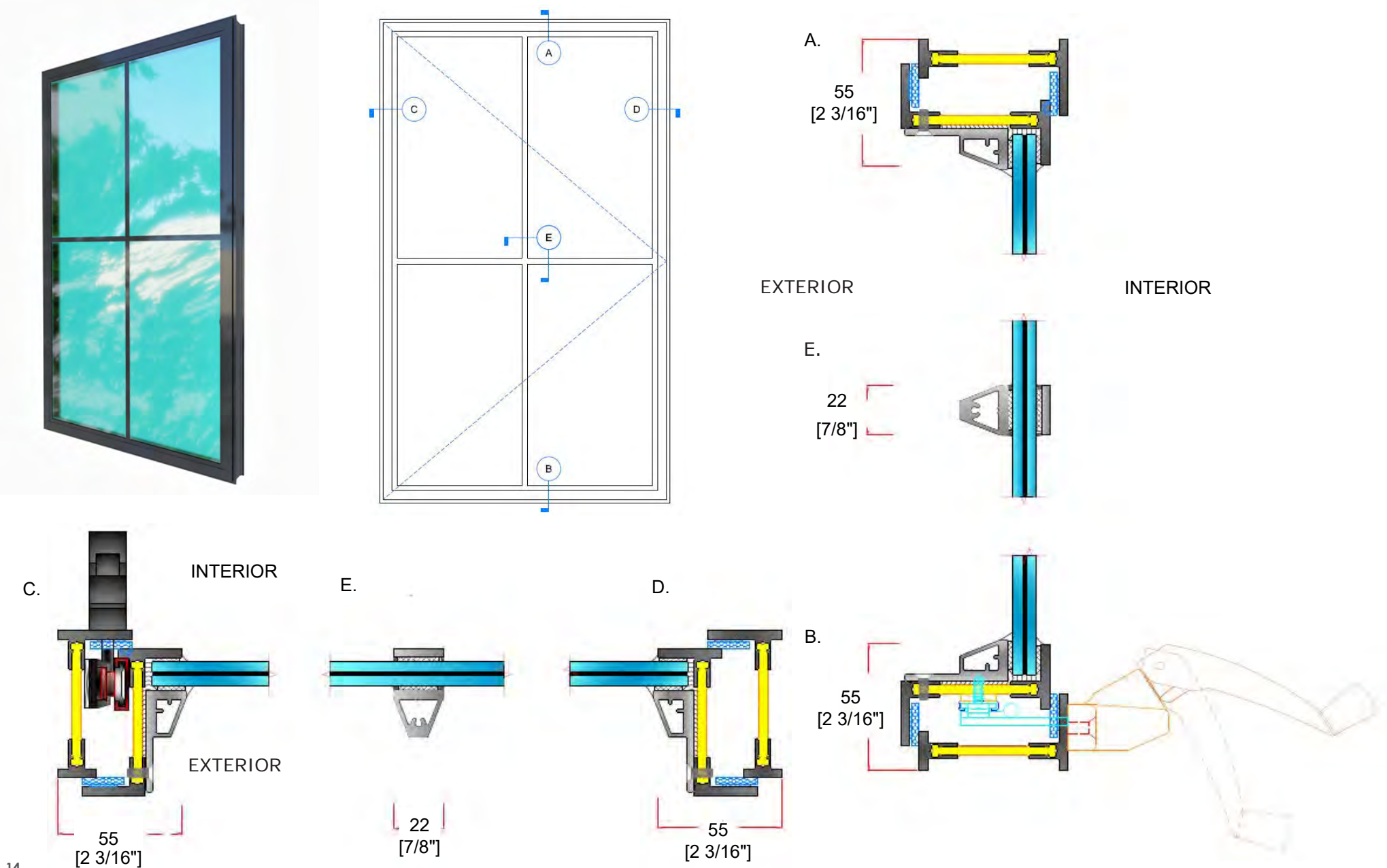

RTS430i-OC

SINGLE CASEMENT MULLED TO FIX

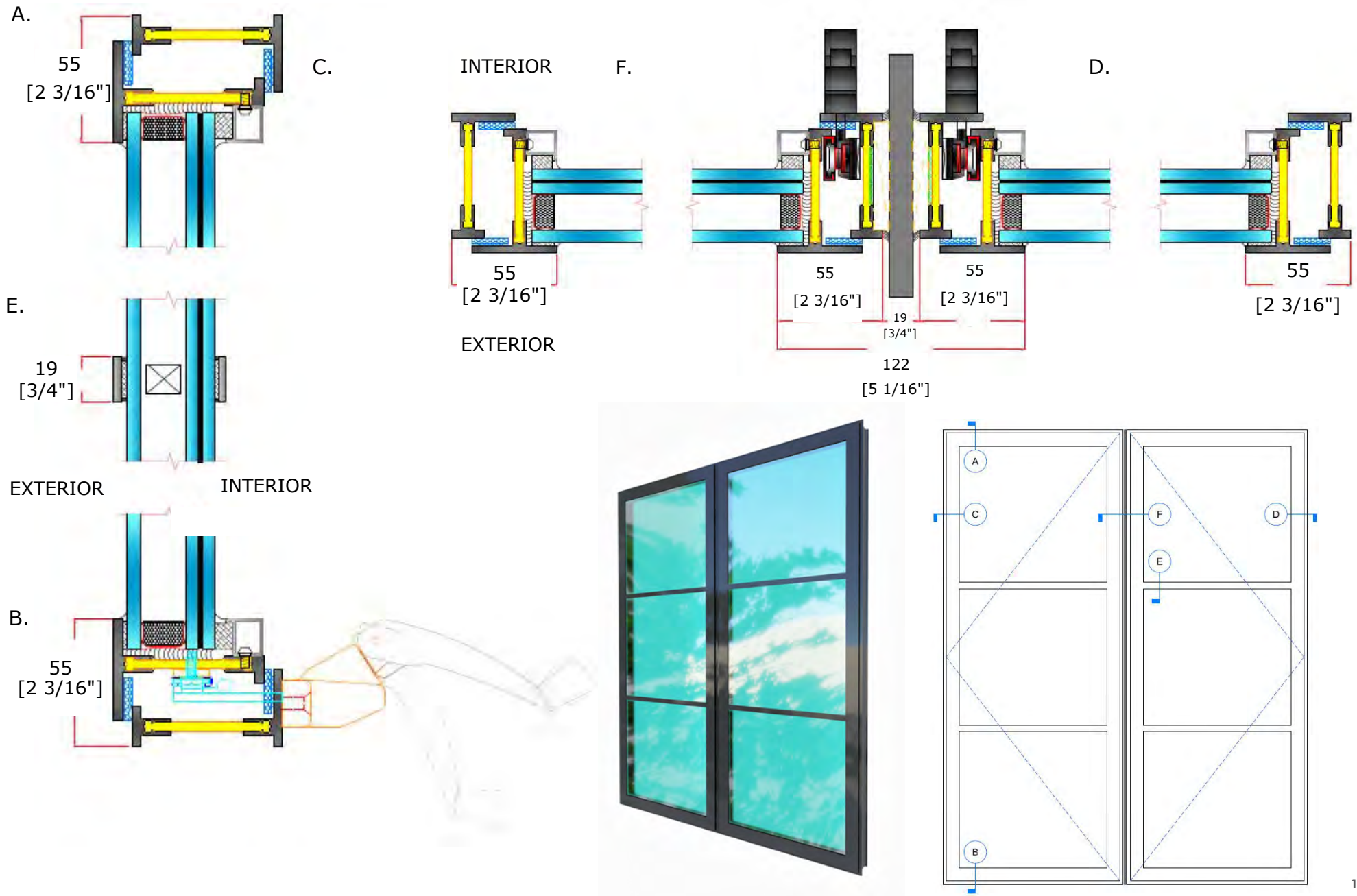

RTS430i-OC

DOUBLE CASEMENT MULLED

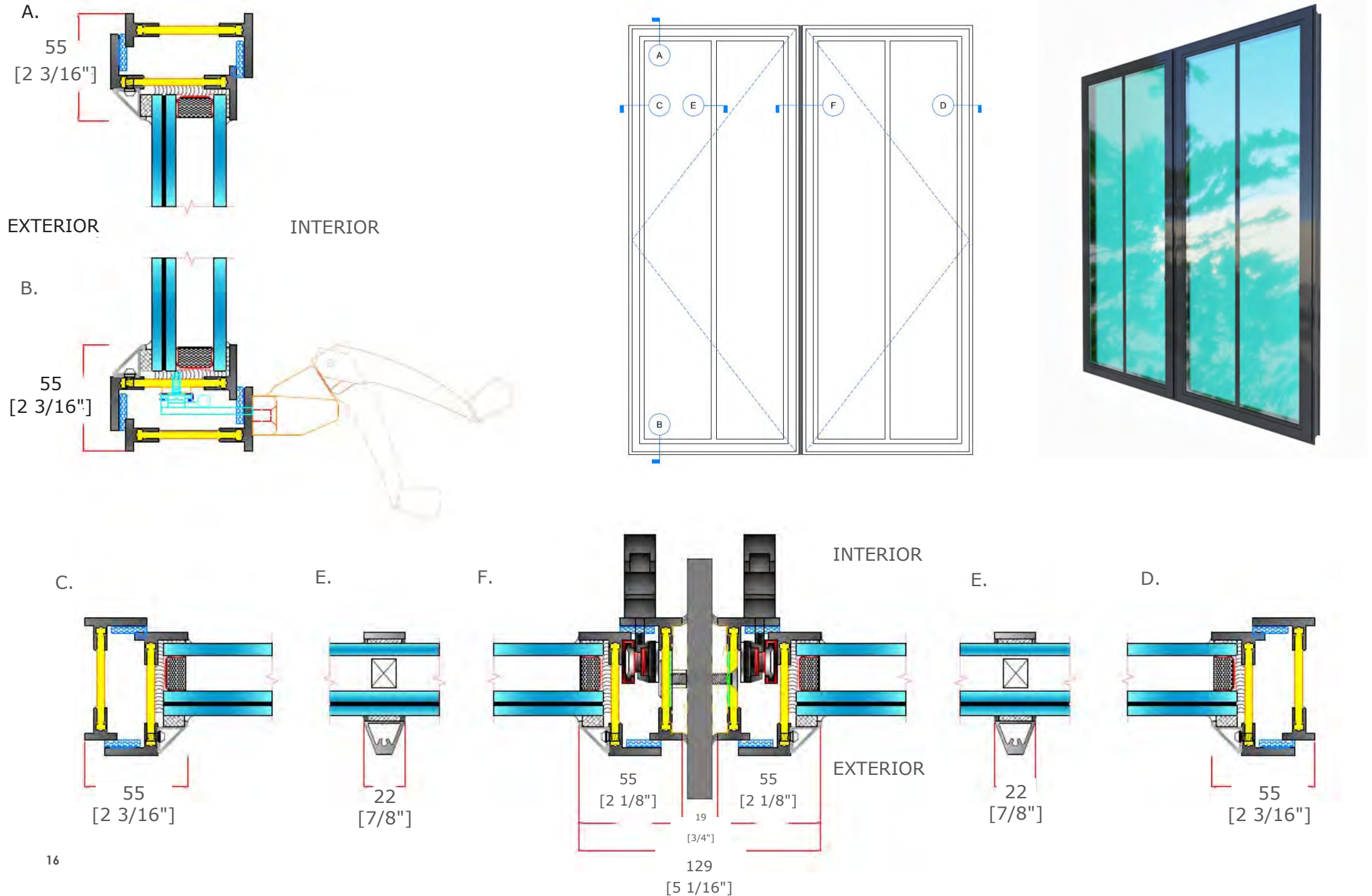

RTS430i-OC

OUT-SWING FRENCH CASEMENT

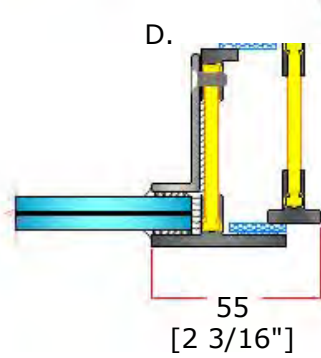
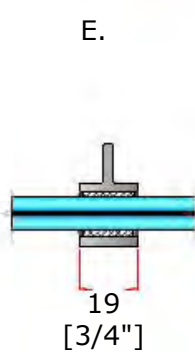
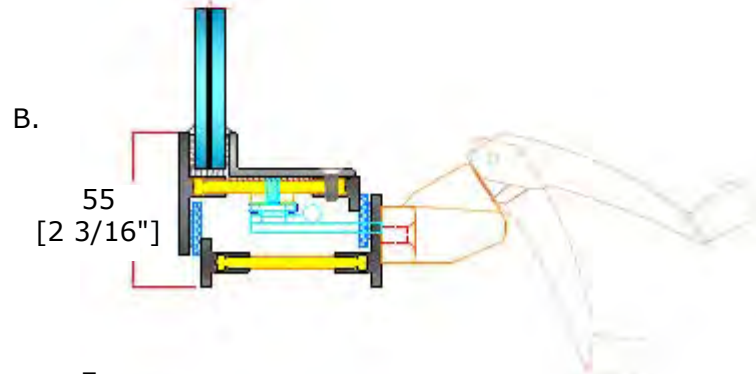
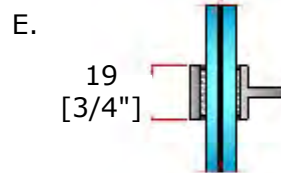
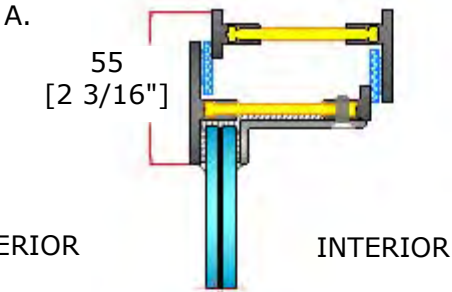
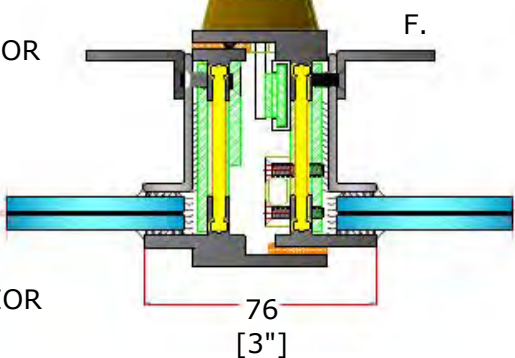
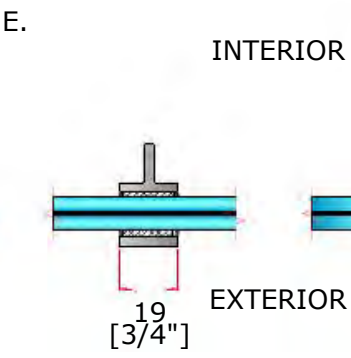
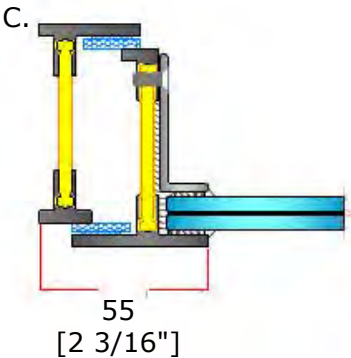
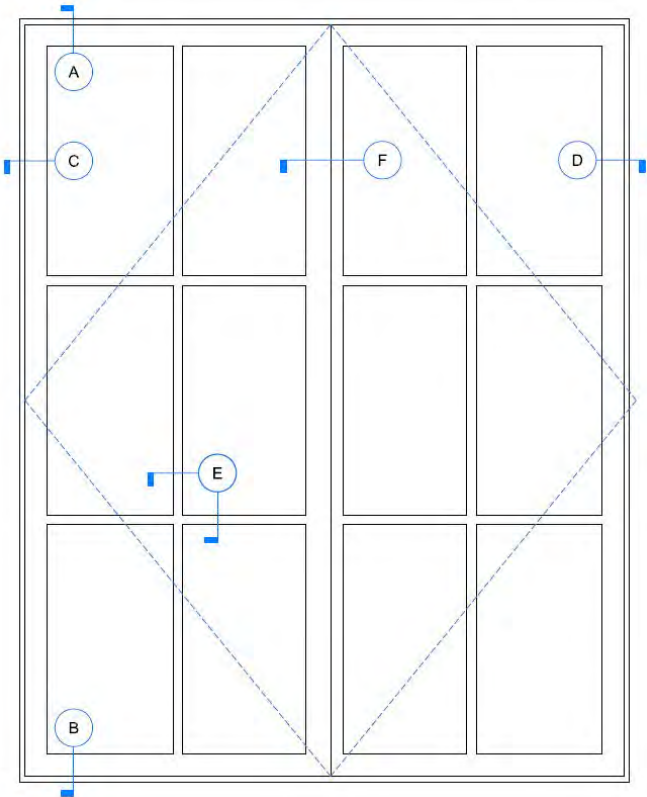

RTS430i-OC

OUT-SWING DOUBLE CASEMENT

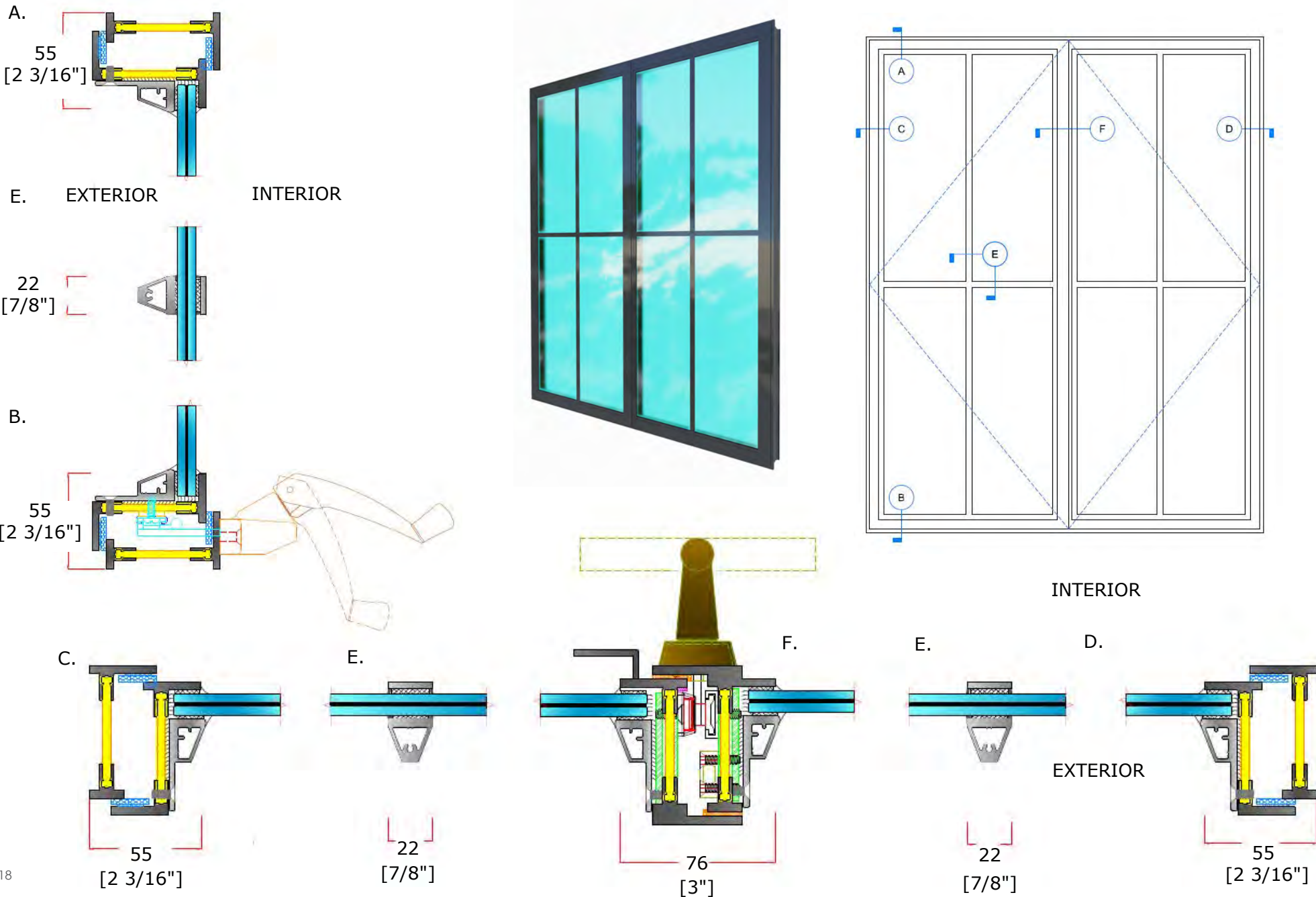

RTS430i-OD

OUT-SWING FRENCH DOOR

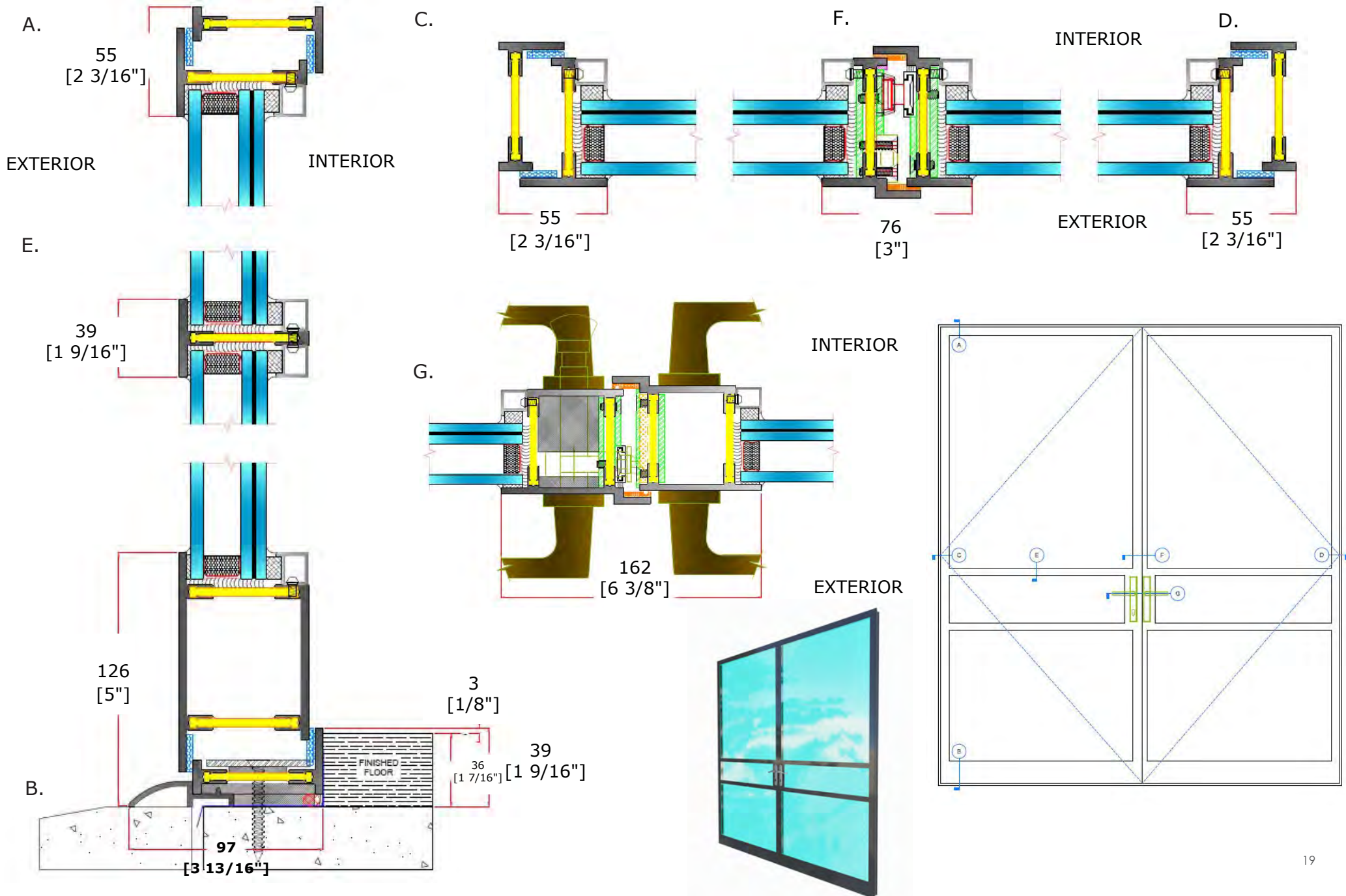

RTS430i-OD

OUT-SWING FRENCH DOOR

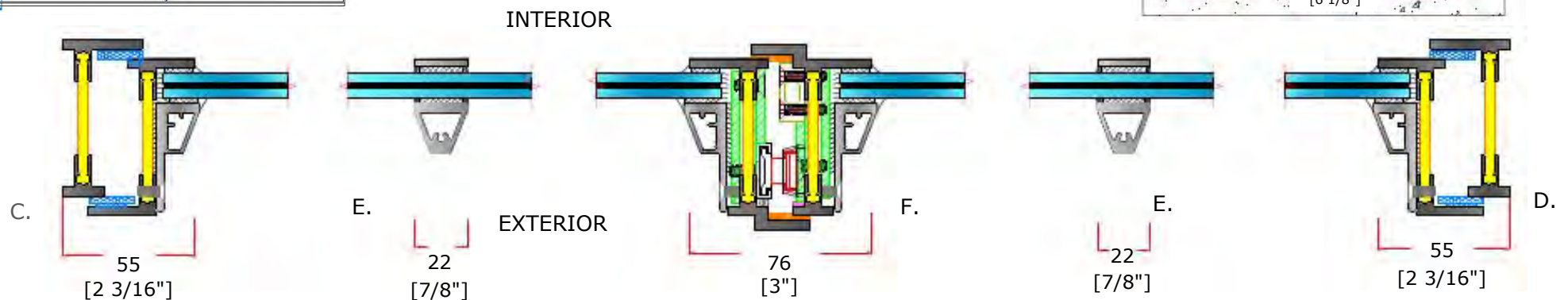
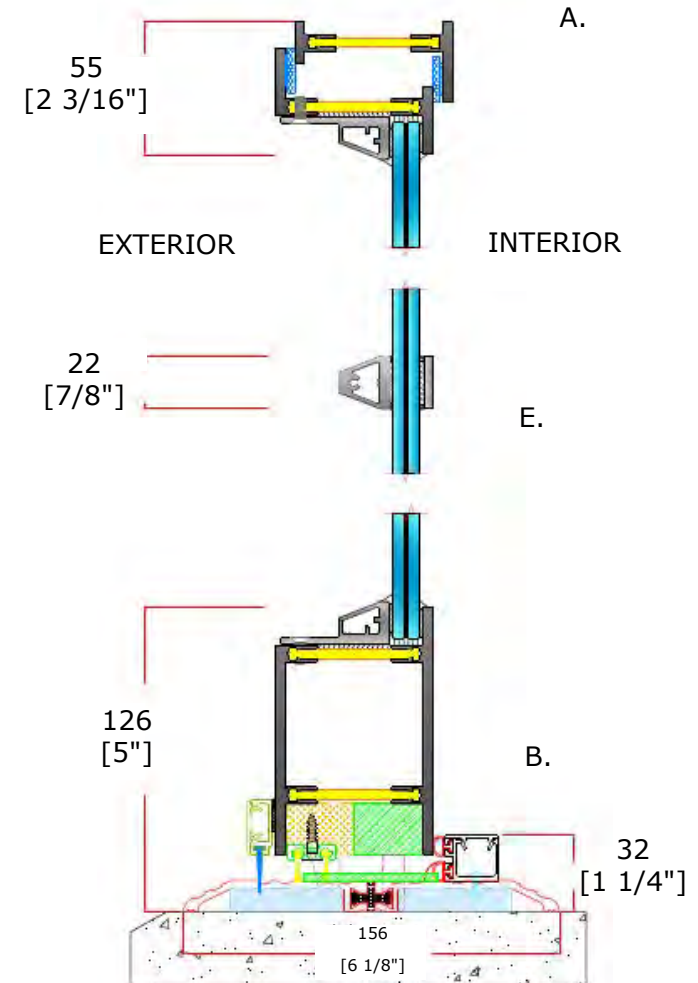
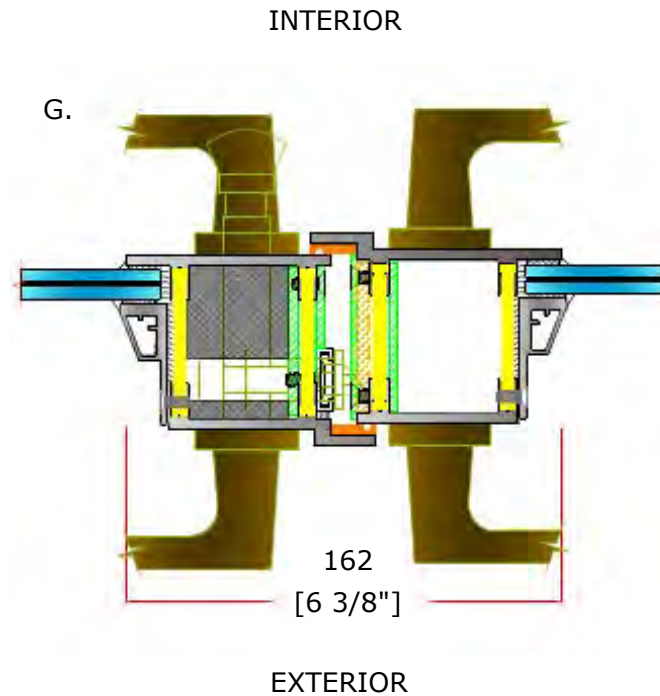
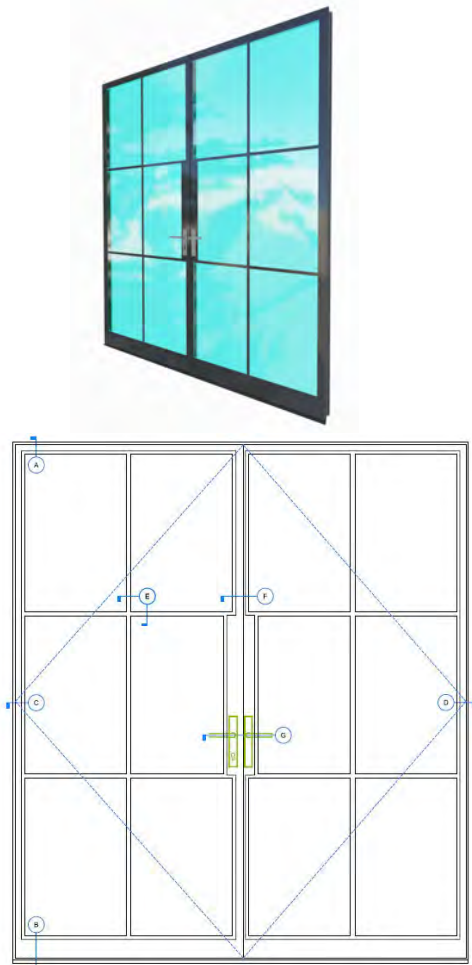

RTS430i-OD

OUT-SWING DOOR

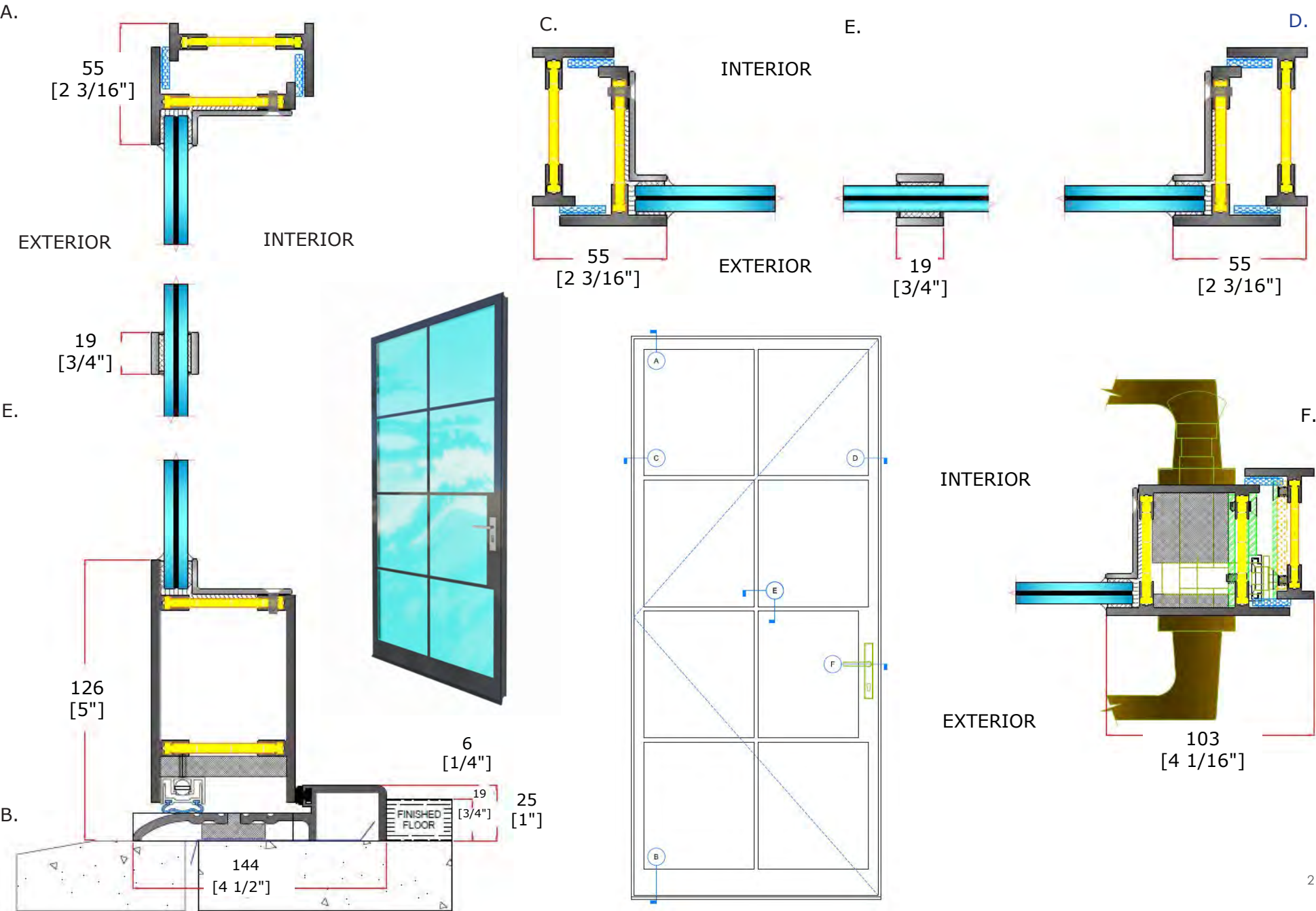

RTS430i-OD

OUT-SWING DOOR WITH LOCK RAIL

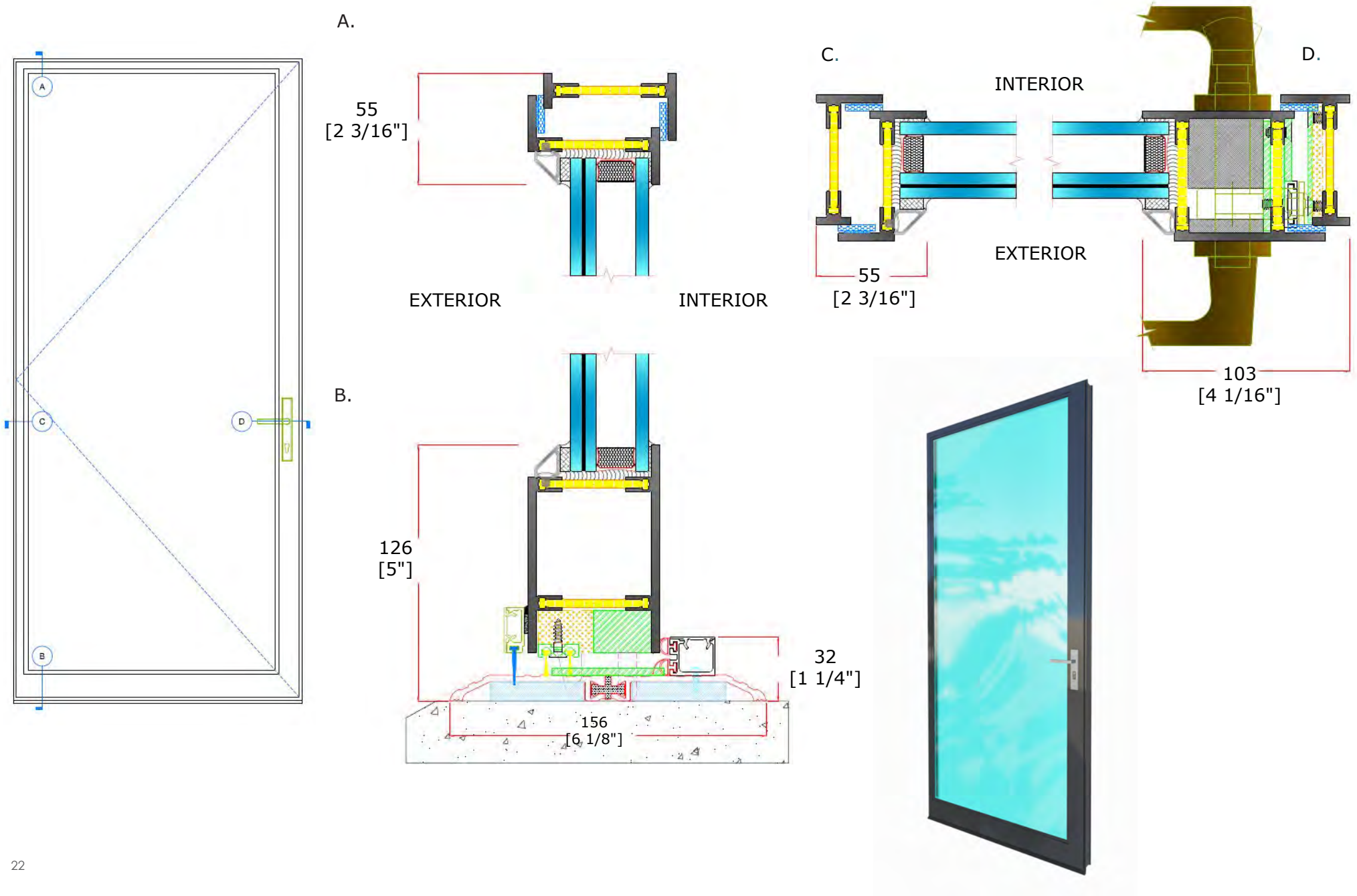

OUT-SWING HOPPER WITH ROTO OR FORK LATCHES



RTS430i-PO

OUT-SWING AWNING WITH PUSHOUT

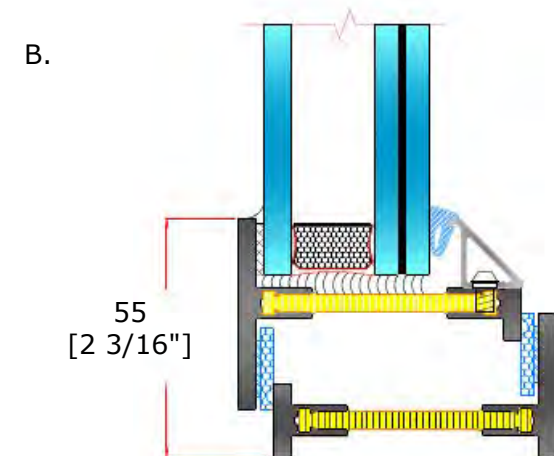
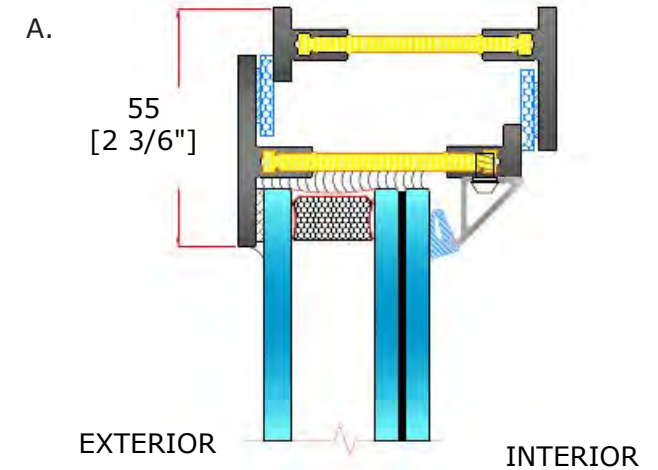
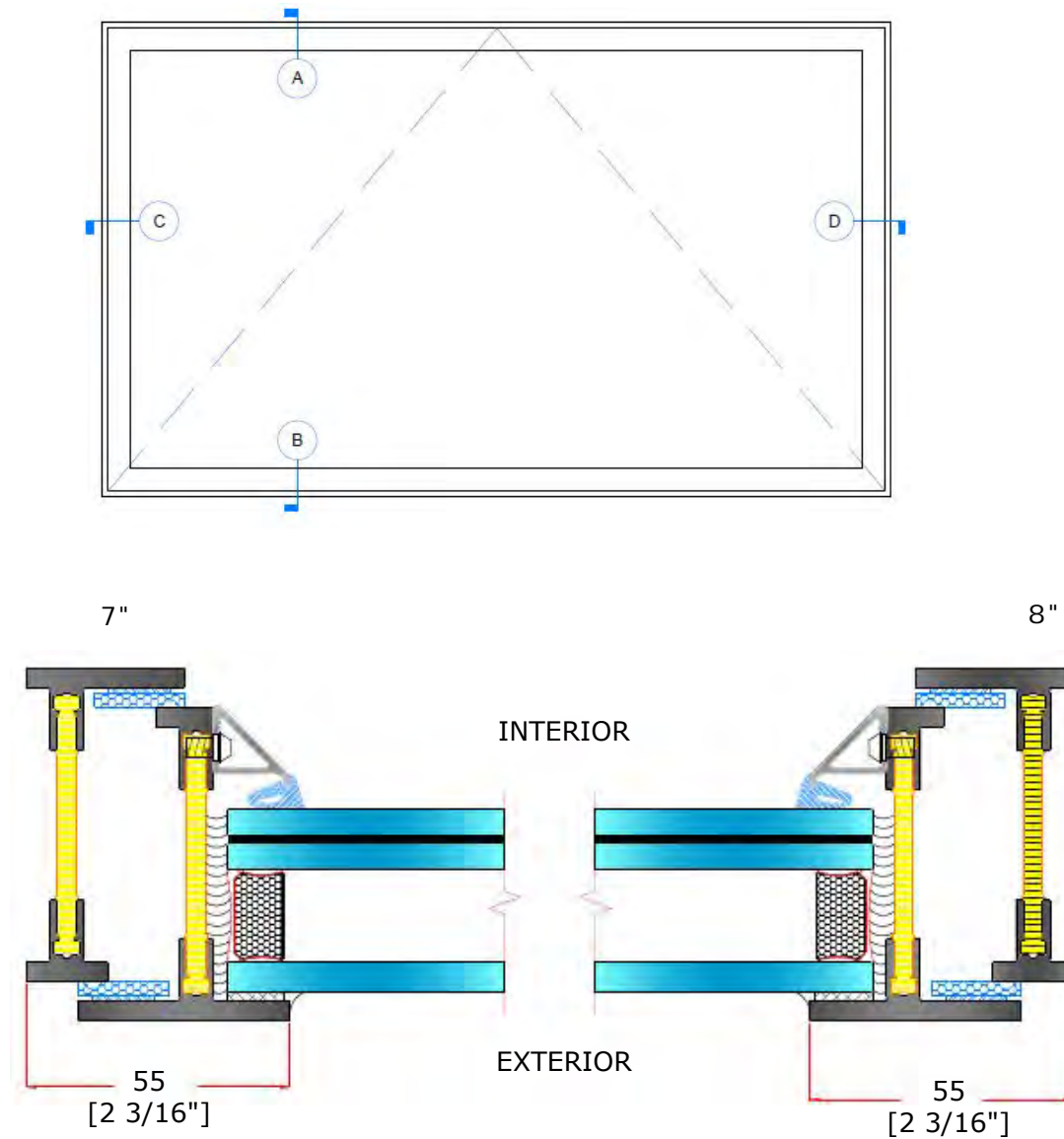

GLAZING FRAME OPTION

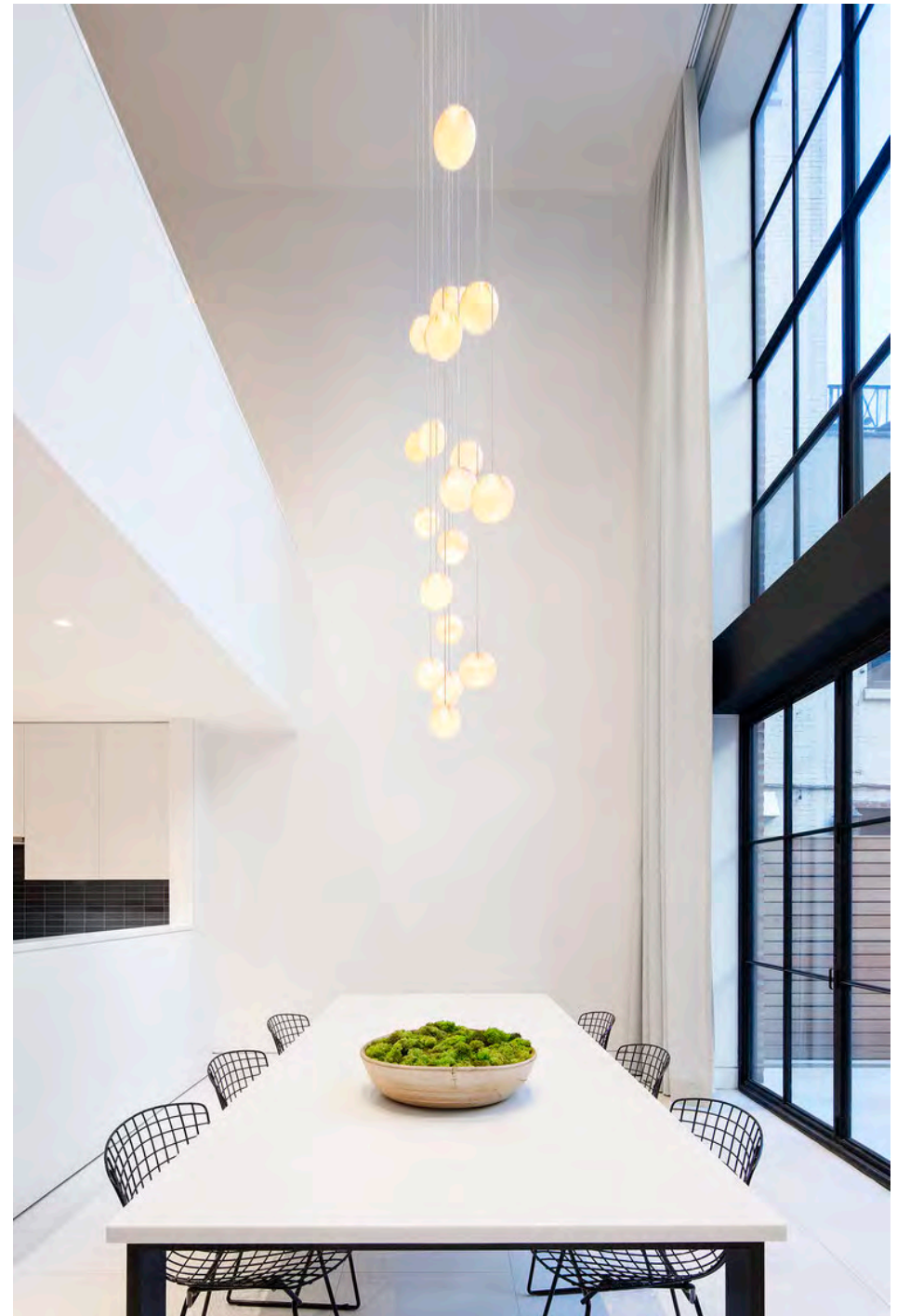
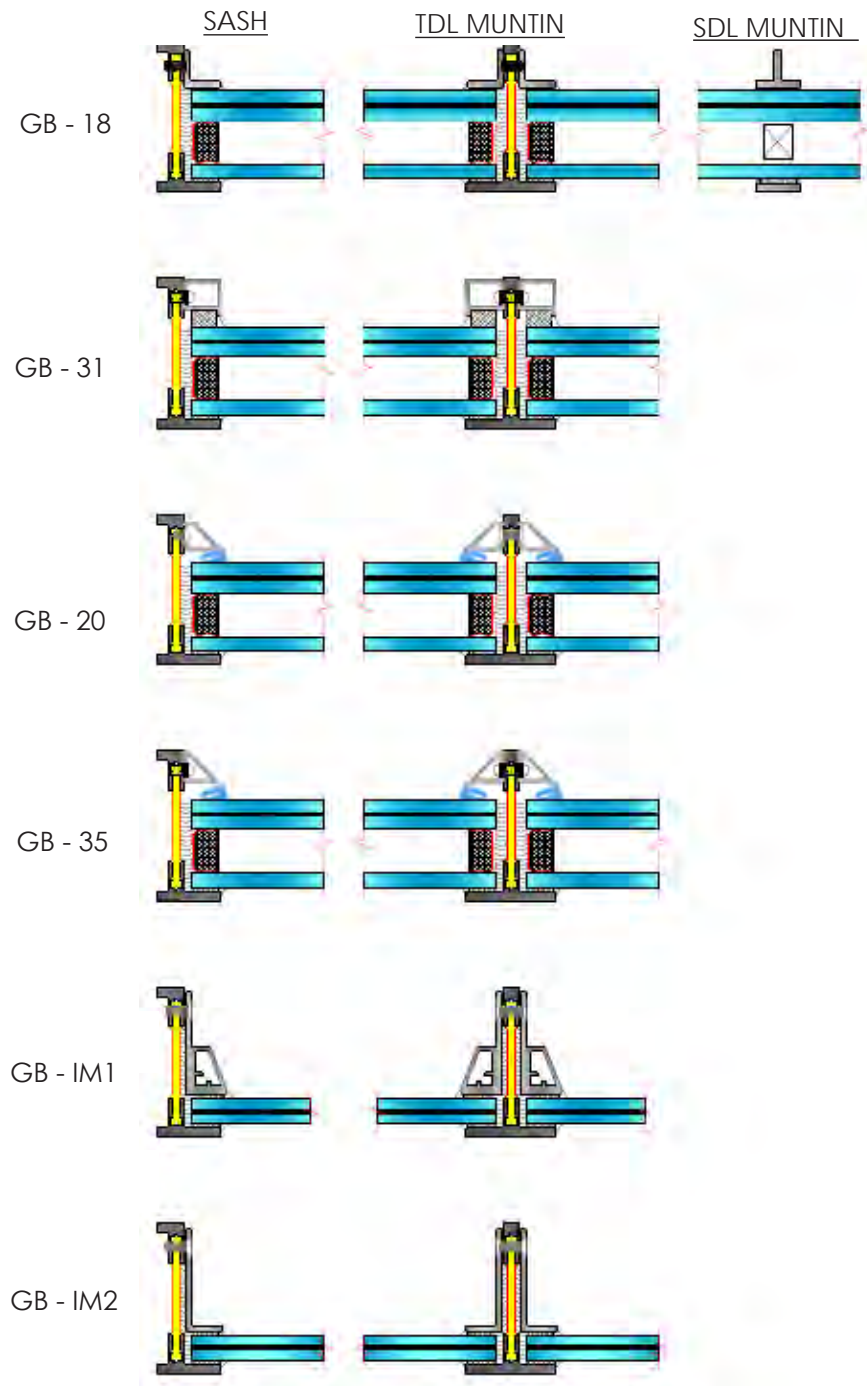

STANDARD FRAME

INTEGRAL FRAME LEG EXTENSIONS

FIXED

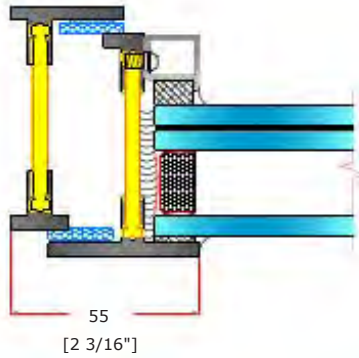

VERTICAL MULLIONS

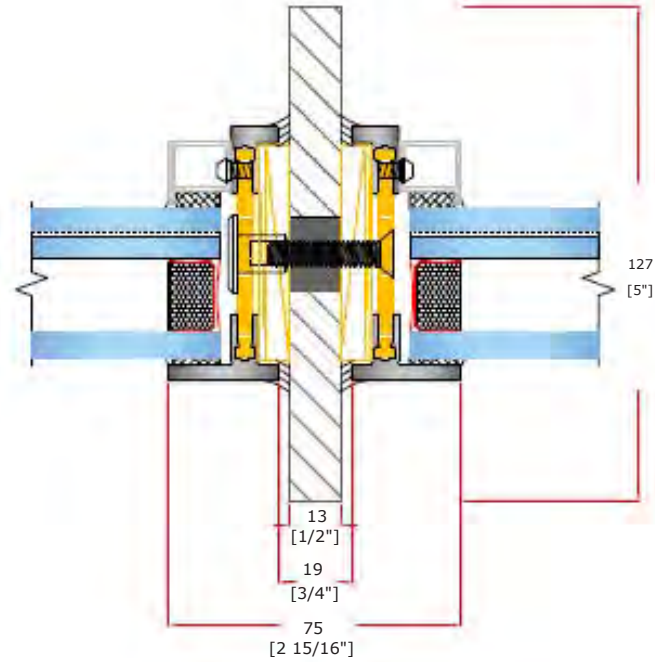

HORIZONTAL MULLIONS

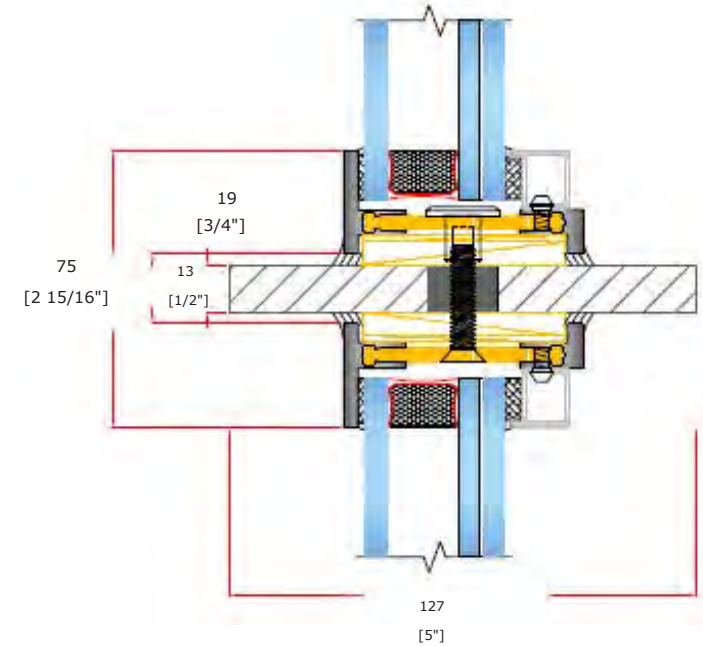

INTERIOR FLANGE

INTEGRAL FRAME LEG EXTENSIONS

FIXED / OPERABLE

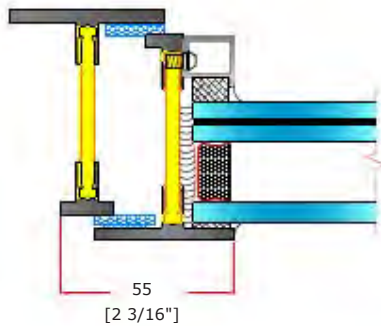

VERTICAL MULLIONS

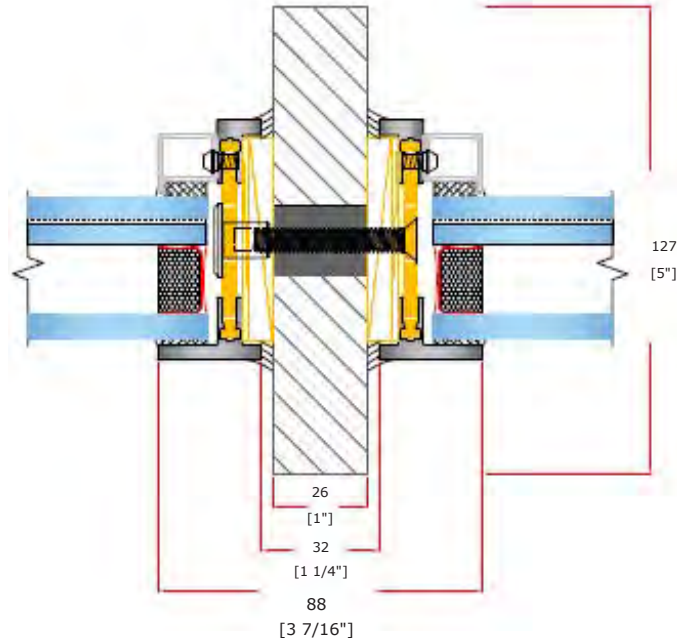

HORIZONTAL MULLIONS

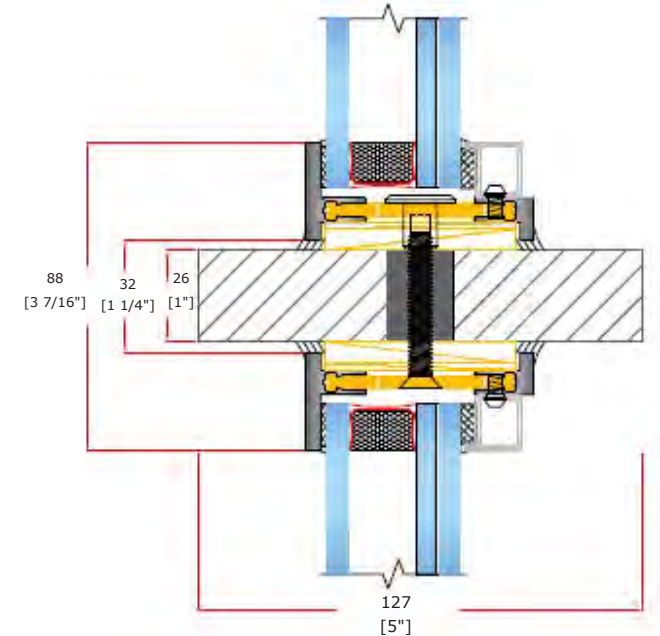

FIXED/FIXED

EXTERIOR FLANGE

INTEGRAL FRAME LEG EXTENSIONS

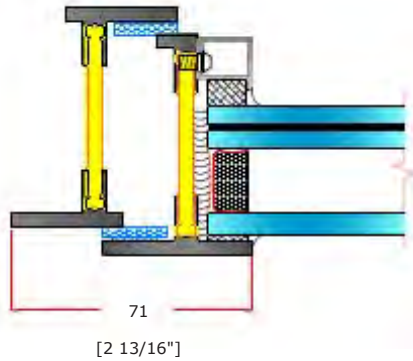

VERTICAL MULLIONS

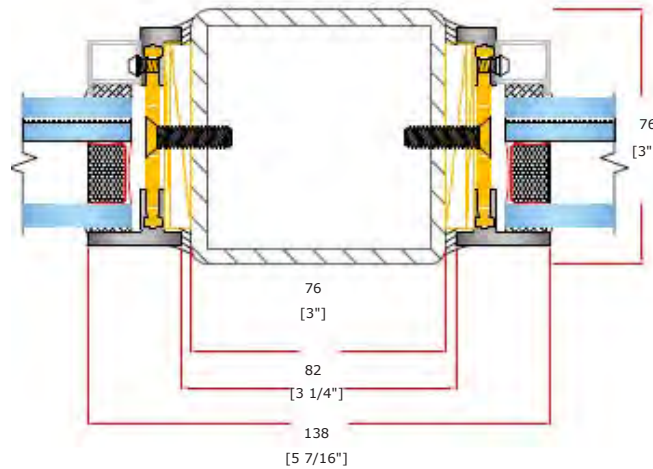

HORIZONTAL MULLIONS

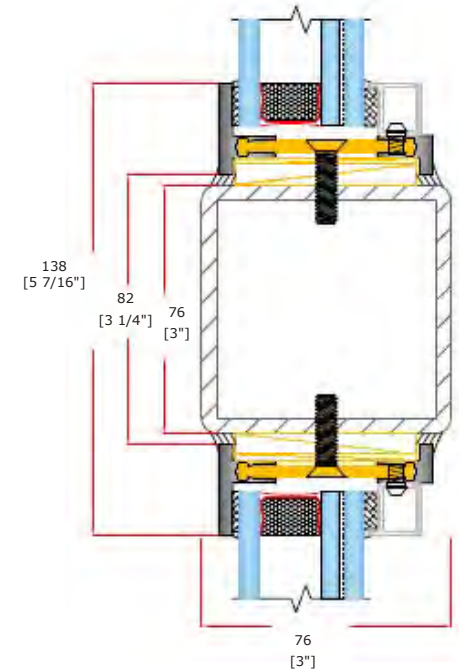

FIXED / OPERABLE

LARGE FRAME

INTEGRAL FRAME LEG EXTENSIONS

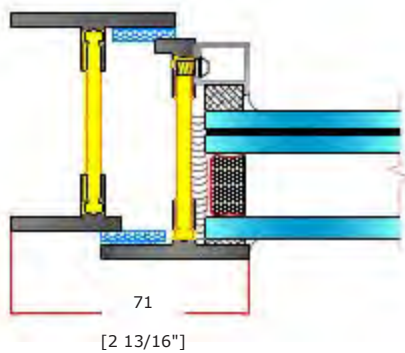

VERTICAL MULLIONS

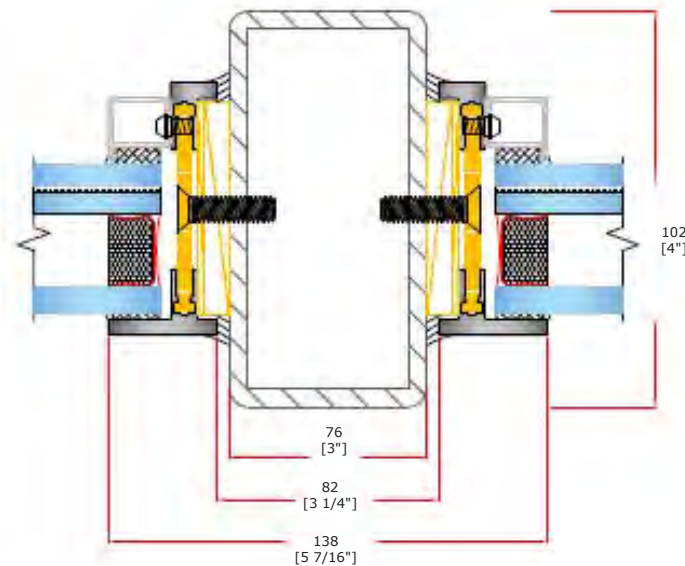

HORIZONTAL MULLIONS

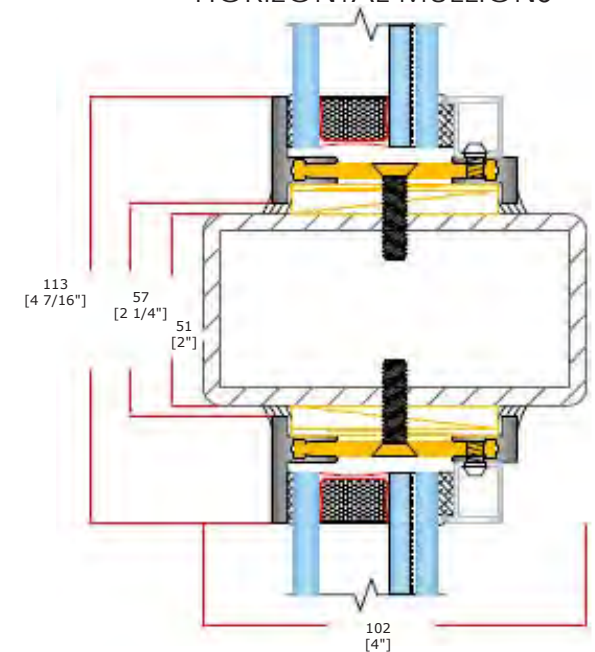



STATE-OF-THE-ART TECHNOLOGY & SUPERIOR CRAFTSMENSHIP

-
- Steel windows and doors are stronger than any alternative building material.
 - Hardware fastened to steel windows and doors will NOT pull out and ventilators do not distort or rack with age.
 - Superior Performance Welding surpasses traditionally welded steel windows and are inspected by skilled craftspeople.
 - The aesthetic virtues that can be achieved by use of steel cannot be duplicated in aluminum, wood, or vinyl alternatives.
-

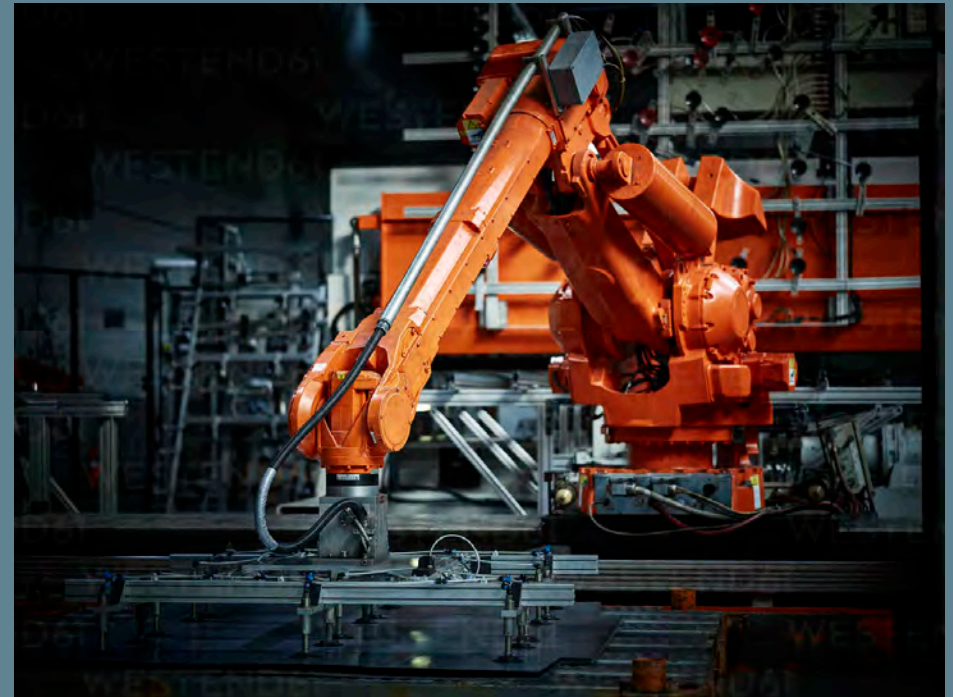

FINISH

THE PROCESS

1. Stainless Steel profiles are run through an abrasive blasting treatment producing an anchor bond for primer and paint adhesion
2. Zinc Enriched Epoxy Primer Coating, Standard 2604 Finish. Options for 2605
3. Electrostatic Powder Coating Top applied and Cured



4000 hours Salt Spray

DRY ADHESION NUMBER	GENERAL APPLICATION	SCRIBE MAX	RUST MEAN	SCRIBE SMALL	BLISTER LARGE	UNSCRIBE RUST	AREA BLISTER	ADHESION LOSS	EDGE CORROSION
RELA ESPRESSO	10	10	10	10	10	10	10	10	10
SOFT TOUCH SMOOTH BLACK	10	10	10	10	10	10	10	10	10
QUAKER BRONZE	10	10	10	10	10	10	10	10	10
STANDARD WHITE	10	10	10	10	10	10	10	10	10

*Powder-Coating Finishes listed above are OWM Standard

FINISH

With a proven track record of hardness and durability, Optimum Window applies its powder coatings in-house, allowing for better quality control of its finishes, all while streamlining the process. Optimum Window is a certified Powder Coat Applicator. Your steel windows and doors will be powder coated to your desired color on the **R.A.L. Chart (Reichs-Ausschuss für Lieferbedingungen)**. Color matching is never a concern. Our paints are designed to withstand damaging UV rays and even coastal salt regions. We take pride in providing our clients unparalleled high quality products. We also offer a variety of Patina finishes, as well.

Warranty: Limited 10 Year Warranty on finish, adhesion and caulking. Please ask an Optimum Window Representative for complete warranty information.



Enhanced Durability

- Proven track record of hardness and durability
- Inherently resistant to damage
- Resilient to chemical and corrosive attack
- Provides maximum protection to the substrate
- Excellent results with spray and humidity testing

Green Design

- Environmentally friendly
- Integral to contemporary building design and construction
- Ideal for government compliance
- Green alternative to liquid coatings
- Powder does not require high VOC solvents, as used in liquid paints
- Zero VOC's (Volatile Organic Compounds)

State of the Art Technology

- Cutting edge "GREEN" technology
- Small-batch, custom color capability
- Unparalleled high quality and durable finish

Color Customization

- Wide range of color selections and options to match
- Our standard colors meet AAMA2604 with options for 2605

Certified Quality

- Optimum applies all powder coating in-house, allow for better quality control
- OWM is a certified powder coat applicator

WINDOW TYPICAL ELEVATIONS

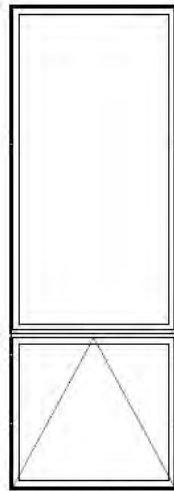

FIXED OVER
AWNING

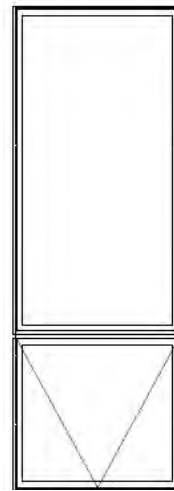

FIXED OVER
HOPPER

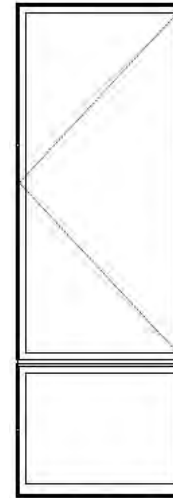

OPERABLE
OVER
FIXED

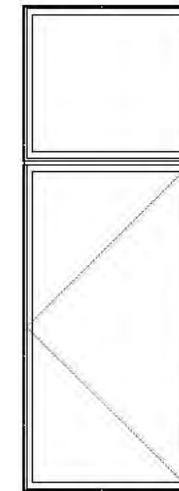

FIXED OVER
OPERABLE

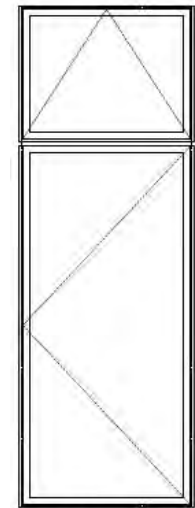

OPERABLE
OVER
OPERABLE

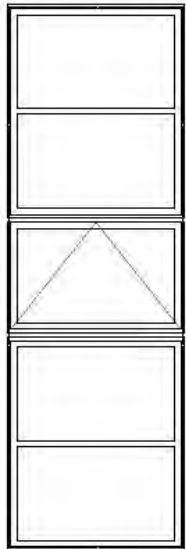

COMBINATION:
FIXED OVER &
UNDER OPERABLE

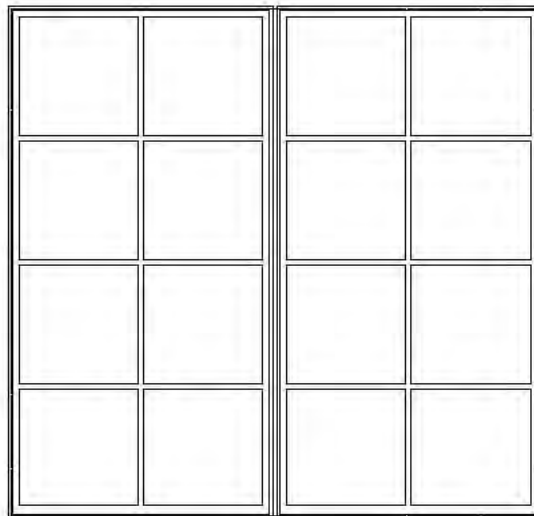

COMBINATION:
FIXED MULTI-LITE

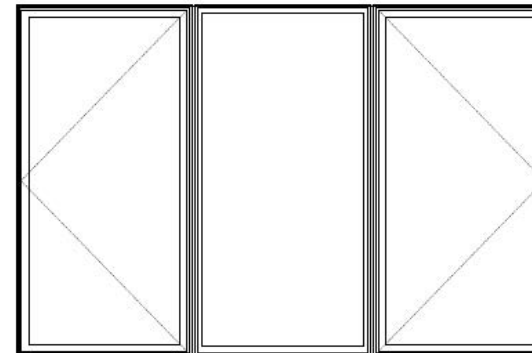

COMBINATION:
LEFT OPERABLE,
MIDDLE FIXED &
RIGHT OPERABLE

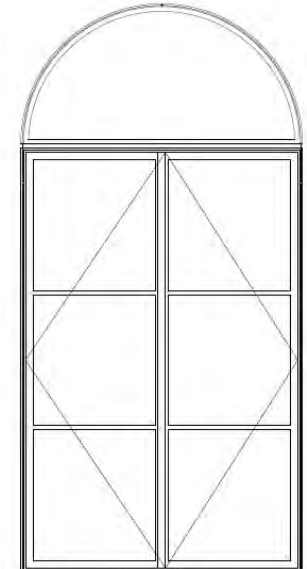

COMBINATION:
1/2 ROUND
TRANSOM OVER
OPERABLE

SINGLE CASEMENT WINDOW HARDWARE

LINEAR HANDLE OPTIONS FOR PROJECTED UNITS

BRONZE LINEAR HANDLE
OC 8200R-BNZ



NEUTRAL LINEAR HANDLE
OC 8200R-CN



SILVER LINEAR HANDLE
OC 8200R- SLV



WHITE LINEAR HANDLE
OC 8200R-WT



SATIN NICKEL LINEAR HANDLE
OC 8200R-SN



HANDLE OPTIONS (5J 5-5609-B 65HB 5B8 DC @G 98: -B-G-98)

OM HDI @-B 657? !7 C 5 H



OM HDI @-B POLISHED
M@C K 6FC BN9



OM T-PULL IN
POLISHED RED BRONZE



OM T-PULL IN POLISHED
WHITE BRONZE



OM T-PULL IN OIL RUBBED
BRONZE



CONCEALED HARDWARE AND HINGES

CAM HANDLE
(Same finish options as T-Pulls)



90 DEGREE LIMIT ARM



DOUBLE BAR ADJUSTER







ROTO CRANK



ROUND OR SQUARE
HINGE



FRENCH CASEMENT WINDOW HARDWARE

<p>OR ALISE</p> <p>Polished Varnish</p>  <p>Scratched Bronze</p> <p>Matte Black</p> <p>Satin Chrome</p>	<p>OR ASTRA</p> <p>Chrome</p>  <p>Polished Varnish</p> <p>Matte Black</p> <p>Satin Chrome</p>	<p>OR BETTY</p> <p>Satin Chrome</p>  <p>Polished Varnish</p> <p>Matte Black</p> <p>Scratched Bronze</p>	<p>OR FLORIDA</p> <p>Satin Chrome</p>  <p>Polished Varnish</p> <p>Matte Black</p> <p>Satin Chrome</p>
<p>OR PRAGA</p> <p>Oxid Brass</p>  <p>Rustic</p> <p>Antique</p> <p>Old Silver</p>	<p>OR Q-ARTE</p> <p>Satin Chrome</p>  <p>Matte Scratched Bronze</p> <p>Matte Black</p> <p>Satin Nickel Plated Varnish</p>	<p>OR SABINA</p> <p>Satin Chrome</p>  <p>Polished Varnish</p> <p>Matte Black</p> <p>Scratched Bronze</p>	<p>OR GINEVRA</p> <p>Old Silver</p>  <p>Rustic</p> <p>Antique</p> <p>Oxid Brass</p>

DOUBLE BAR ADJUSTER



CONCEALED HARDWARE AND HINGES

CONCEALED THROWBOLT



ROUND OR SQUARE HINGE



Escutcheon options:

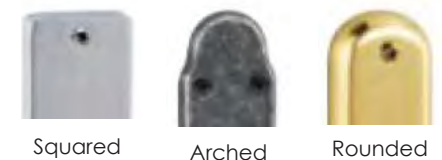

PROJECTED WINDOW HARDWARE

LINEAR HANDLE OPTIONS FOR PROJECTED UNITS

BRONZE LINEAR HANDLE
OC 8200R-BNZ



NEUTRAL LINEAR HANDLE
OC 8200R-CN



SILVER LINEAR HANDLE
OC 8200R-SLV



WHITE LINEAR HANDLE
OC 8200R-WT



SATIN NICKEL LINEAR HANDLE
OC 8200R-SN



ROTO CRANK



CAM HANDLE
(Available finishes same as T-Pulls)



ROUNDED FORK LATCH



SQUARED FORK LATCH



CONCEALED HARDWARE AND HINGES

STORM HINGE



DOUBLE BAR ADJUSTER



PROJECTED HINGE



TYPICAL DOOR ELEVATIONS

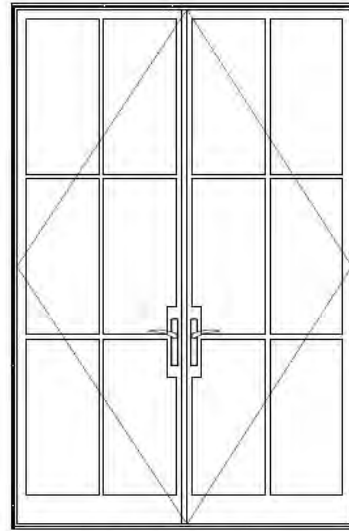

FRENCH DOOR

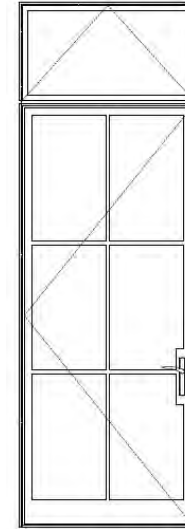

SINGLE DOOR

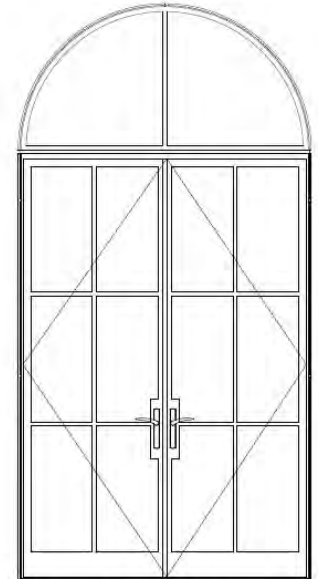

FRENCH DOOR W/
TRANSOM ABOVE

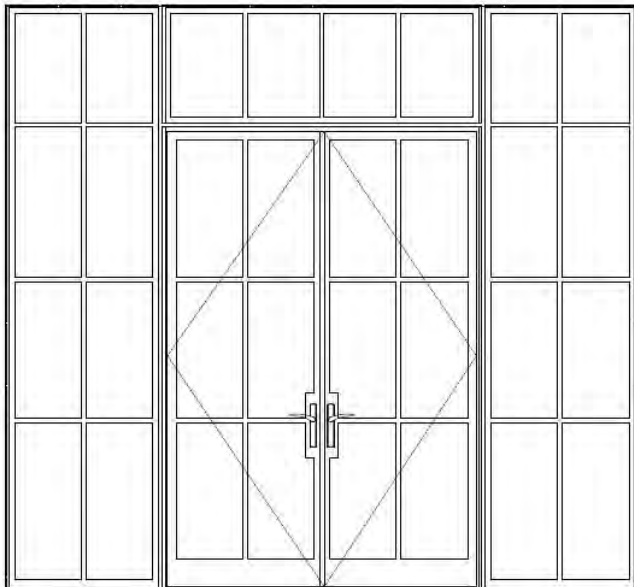

FRENCH DOOR W/ SIDE LITES
AND TRANSOM ABOVE

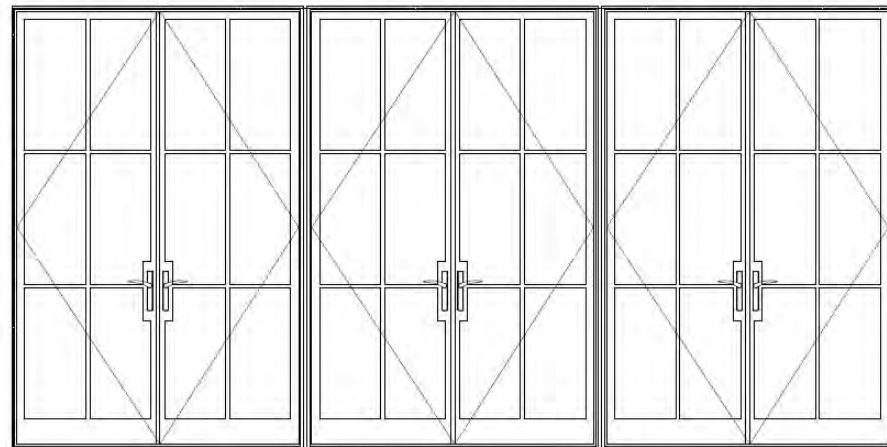

MULLED FRENCH DOOR SYSTEM

DOOR LEVERS

SINGLE DOOR HARDWARE

OR ASTRA

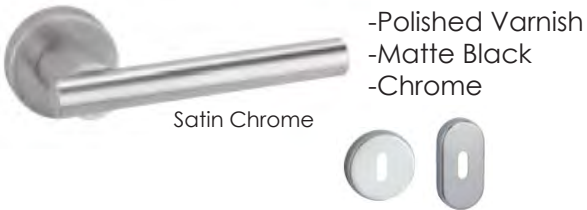

OR DESY



OR VIENNA



OR FLORIDA

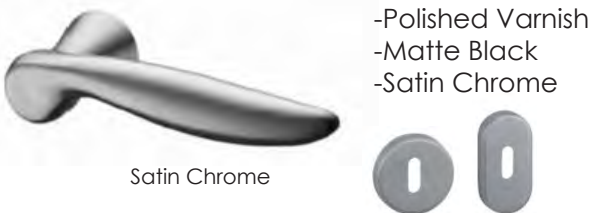

OR SPRING



OR CHARME



OR PRAGA



OR Q-MINI

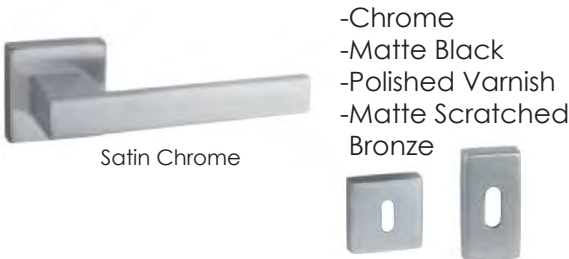

OR GINEVRA



Polished Varnish



Matte Black



Chrome



Scratched Bronze



Rustic



Old Silver



Matte Scratched Bronze



Satin Chrome



Antique



Oxid Brass

SINGLE AND FRENCH DOOR HARDWARE

DOOR LEVERS AND ESCUTCHEONS



OH ATLANTA

- Brass Resista
- Brushed Chrome
- Satin Nickel
- Matte Black
- Dark Bronze Metallic



OH DALLAS

- Brass Resista
- Satin Nickel
- Matte Black
- Dark Bronze Metallic
- Rustic Umber



OH MUNCHEN

- Brass Resista
- Antique Brass
- Brushed Chrome
- Polished Chrome
- Oil Rubbed Brass
- Rustic Umber
- Satin Nickel
- Matte Black
- Dark Bronze Metallic



OH RODOS

- Brushed Chrome Resista
- Oil Rubbed Brass
- Matte Black
- Satin Nickel
- Rustic Umber



OH VERONA

- Antique Brass
- Brushed Chrome
- Polished Chrome
- Oil Rubbed Brass
- Matte Black
- Satin Nickel
- Rustic Umber
- Dark Bronze Metallic



OH TORONTO

- Brass Resista
- Brushed Chrome
- Oil Rubbed Brass
- Matte Black
- Satin Nickel
- Rustic Umber
- Dark Bronze Metallic



Escutcheon options:



HARDWARE FINISH OPTIONS



SINGLE AND FRENCH DOOR HARDWARE

PREMIUM SELECTIONS

OS ALTURAS



OS DECO



OS MALAD



OS SILVER CREEK



OS ASPEN



OS FREMONT



OS LOLO



OS PICABO



OS BEAVER TAIL



OS HAILEY



OS KYOTO SEI



OS INGOT



OS ARCHED ESCUTCHEON



OS BEVEL EDGE ESCUTCHEON



OS CONTEMPORARY ESCUTCHEON



OS RIDGE ESCUTCHEON

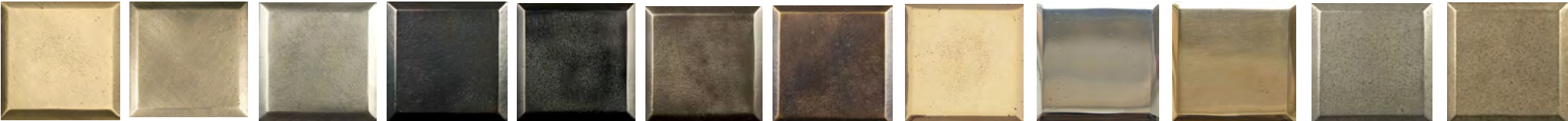

B1 S1 W1 S3 W3 W2 S2 BP WP SP W S

TYPICAL INSTALLATION DETAILS

METAL INSTALLATION CLIPS

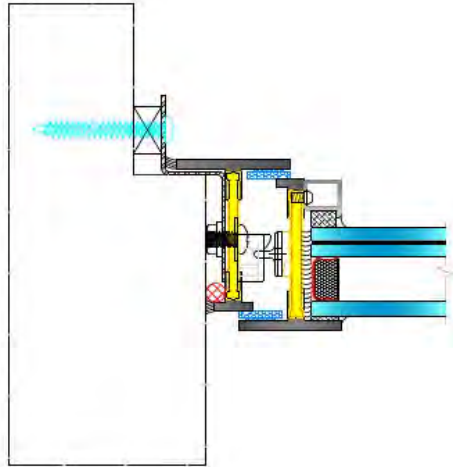

Masonry opening w/ unequal interior leg w/ installation straps

METAL NAIL FIN

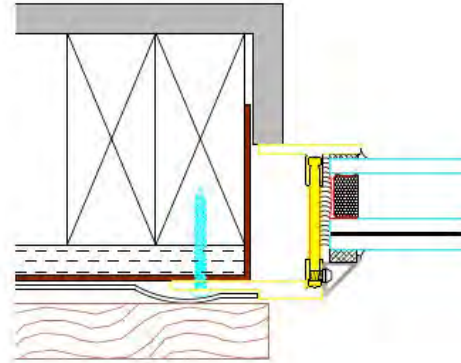

Flange frame in wood black framing w/ siding

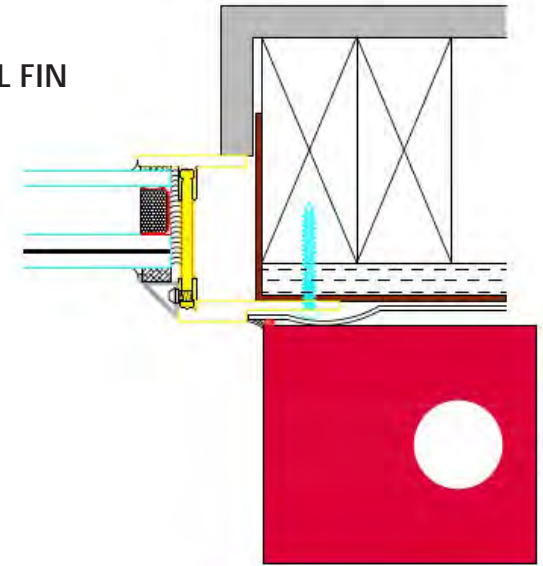

Flange frame in black framing w/ Exterior Brick

DIRECT ANCHOR

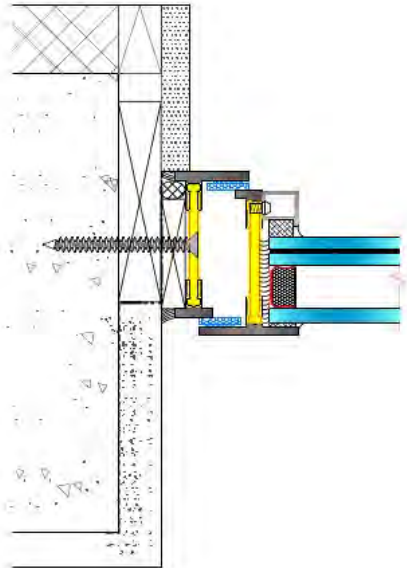

Direct set installation into Framed Blocking

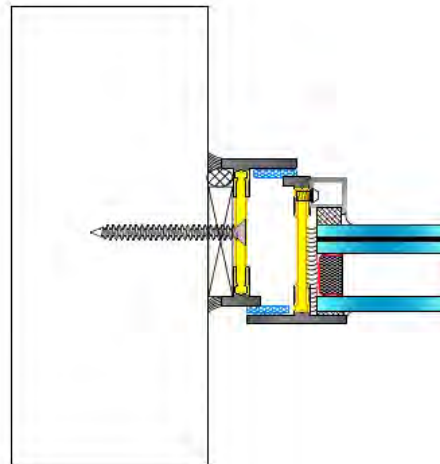

Direct set installation into masonry

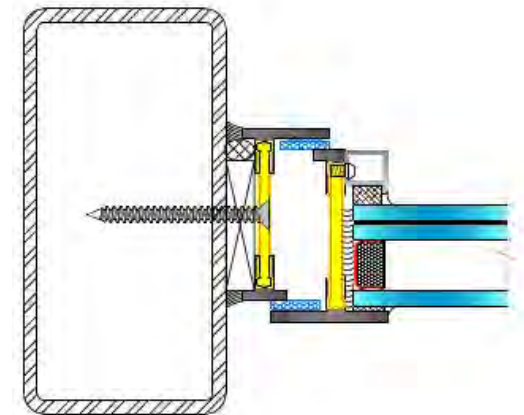

Direct set installation into steel building



AMERICA'S MOST DIVERSIFIED STEEL WINDOW & DOOR MANUFACTURER



OPTIMUM WINDOW MFG. CORP.

28 CANAL STREET, ELLENVILLE, NEW YORK

12428 P: 845.647.1900 F: 845.647.1494

optimumwindow.com

