

OUR CERTIFICATION



ISO 9001 : 2008



CE Certification
of EU



American CARB
Certification



FSC Certification



MAXSTAR INTERNATIONAL SDN BHD (1341779-H)

Factory: Plo 148, No 28, Jalan Angkasa Mas Utama,
Kawasan Perindustrian Tebrau 2, 81100
Johor Bahru, Johor, Malaysia.

T : +6016-2200628 / +607 353 0688 / +6012-8279688

E : sales@maxstarint.com.my
luisewu@maxstarint.com.my

W : www.maxstarint.com.my

USA Services Office:

1111 3rd Ave Ste 3000 Seattle WA 98101
PO Box # 477, 4580 Klahanie DR SE, Issaquah, WA 98029

T : Luise/Adriane +1 (646) 427-2180

Please scan:
Link to youtube



Please scan:
Link to facebook



Please scan:
Link to website



Ma★star International



Cabinet Manufacturer

www.maxstarint.com.my



ABOUT US

Maxstar International Sdn Bhd, established in 2019 in Malaysia, specializes in American-style kitchen cabinets. Its strategic location ensures efficient transportation and shipping services.

Known for professionalism, craftsmanship, and attention to detail, Maxstar uses skilled artisans and advanced equipment to produce high-quality, functional kitchen cabinets. The company supports both project-based and ready-stock production, ensuring consistent supply and the capacity to meet large-scale demands.

Maxstar remains committed to delivering products that exceed customer expectations while fostering lasting relationships with clients, suppliers, and employees. Its dedication to quality and customer satisfaction has solidified its reputation in the industry.

SIGNATURE SHAKER CABINET SPECIFICATIONS

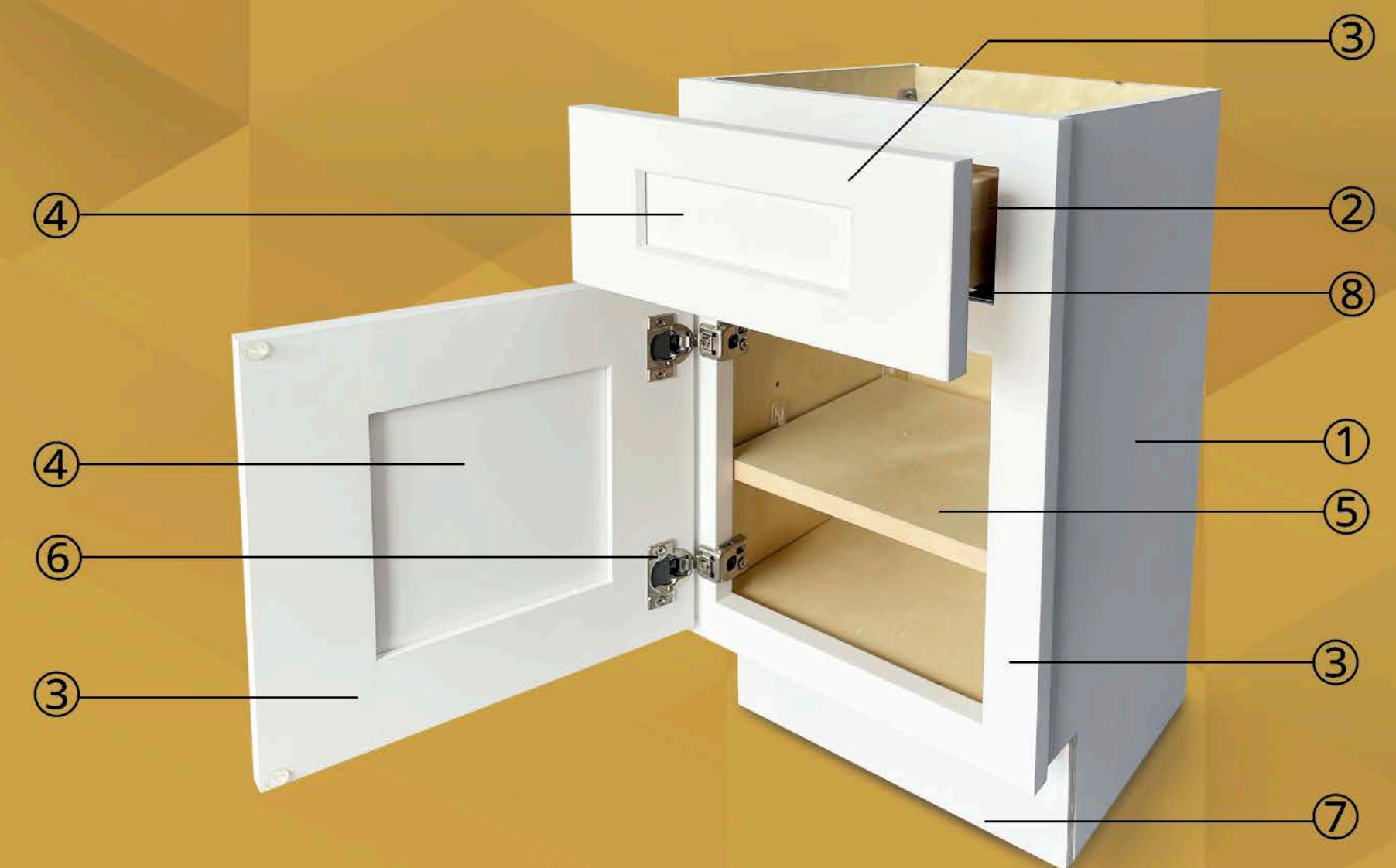

- ① **Birch veneered A grade plywood**, on the sides and a fully veneered back panel.
- ② **Dovetail joints** to secure long-lasting craftsmanship.
- ③ **HDF** or **Birch Solidwood** options for frame to enhanced durability.
- ④ **MDF** centre panels for **customizable** door styles and to ensure smooth finishes.
- ⑤ Birch veneered A grade plywood shelves to effortlessly withstand heavy duty items.
- ⑥ 6-way hinge that includes **soft-closing feature** to ensure precise alignment and easy installation with protective properties during usage.
- ⑦ **Toekick** to provide additional stability and structural support.
- ⑧ **Metal bottom-mounted drawer glides** for unobstructed, smooth and stable space that allows for greater storage.



COMPANY PURPOSE & PHILOSOPHY

- Quality Commitment**
 Maxstar uses durable, high-quality materials to meet customer needs.
- Advanced Technology**
 Continuous investment in cutting-edge equipment ensures efficient production.
- Reliable Supply**
 High-quality, high-volume output meets large-scale demand.
- After-Sales Service**
 Timely, personalized support fosters lasting relationships.
- Future Growth**
 Committed to company and employee development for sustained success.

GALLERY

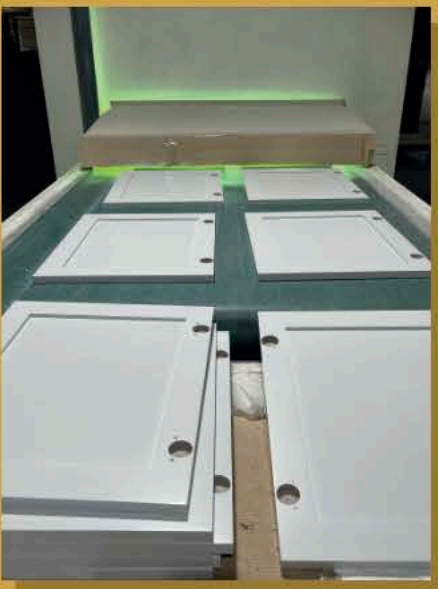

MS-D09
Double Shaker Green



MS-D09
Double Shaker Natural



MS-D09
Double Shaker White



OUR PRODUCTS



MS-D01
Pure White



MS-D01
Light Blue

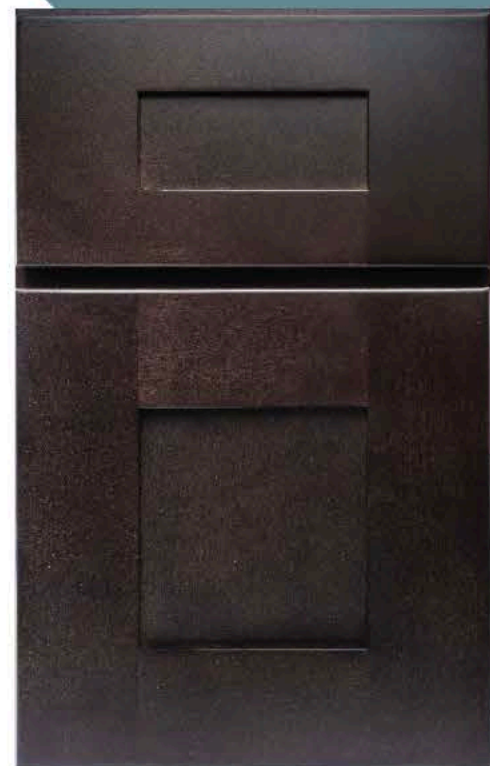

MS-D01
Espresso



MS-D01
Shale



MS-D01
Midnight

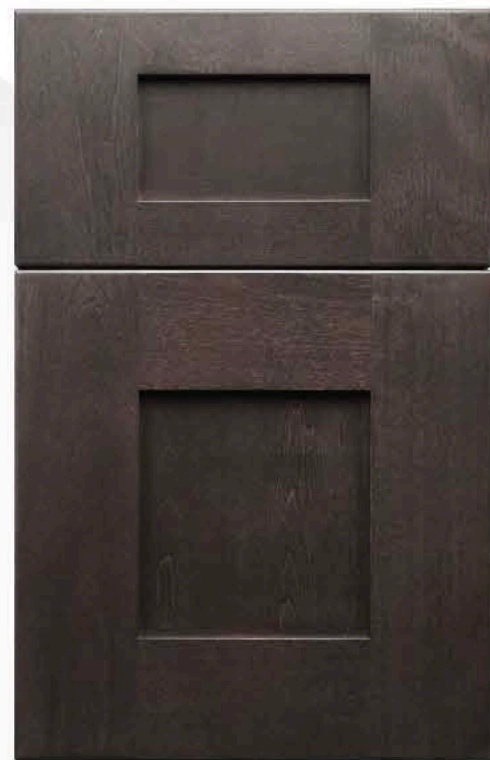

MS-D01
Stain Gray

OUR PRODUCTS



MS-D01
Off White

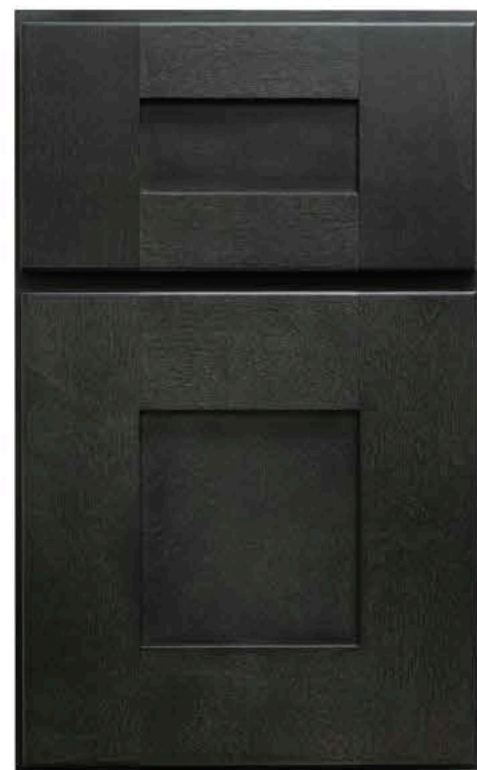

MS-D01
Roundstone



MS-D01
Stain Sandal



MS-D02
Classic White-Inset



MS-D02
Shale-Inset



MS-D03
Stain Sandal



MS-D03
Dark Blue

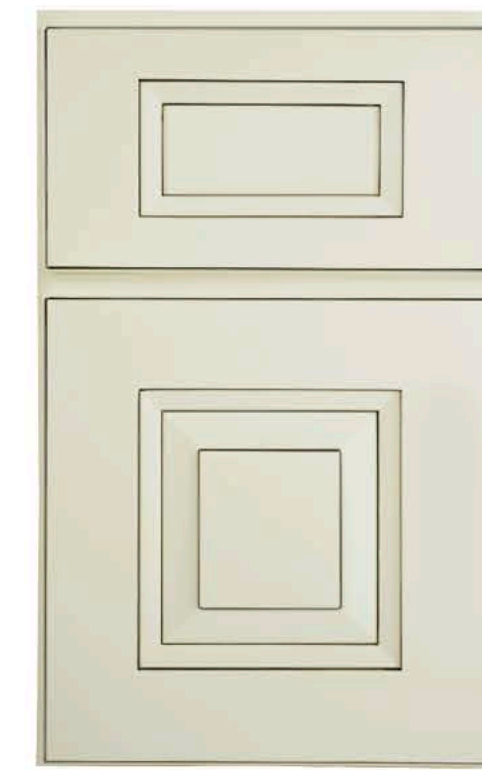

MS-D04
Classic White W/Glaze



MS-D04
Meteor Stone

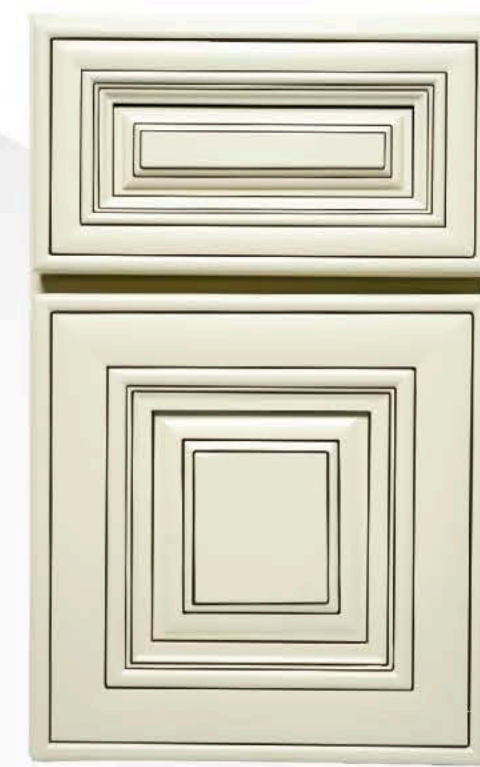

MS-D05
Miter Ivory



MS-D05
Miter Toffee



MS-D08
Princeton Green

OUR PRODUCTS



MS-D06
Pure White



MS-D06
Modern Gray



MS-D06
Midnight



MS-D06
Meteor Stone



MS-D06
Stain Gray



MS-D06
Stain Sandal

OUR PRODUCTS



MS-D07
Gloss Swan White



MS-D07
Matte Pepper Gray



MS-D07
Matte Jeju Gray



MS-D07
Chestnut

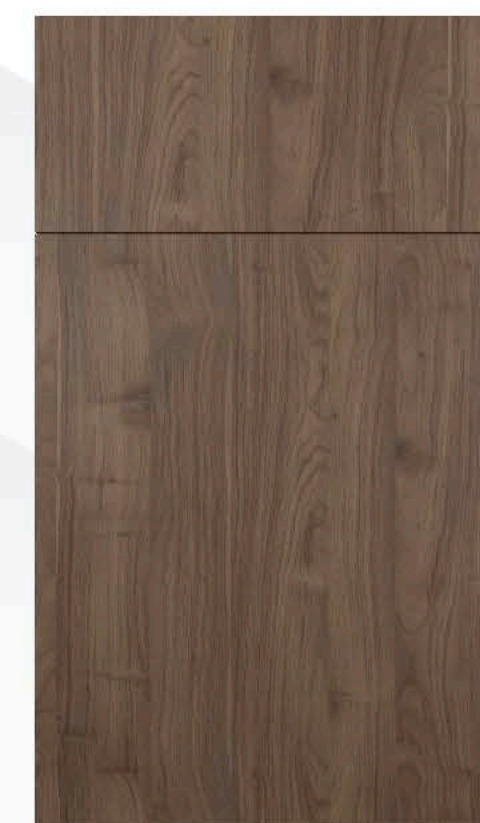

MS-D07
Kings Canyon

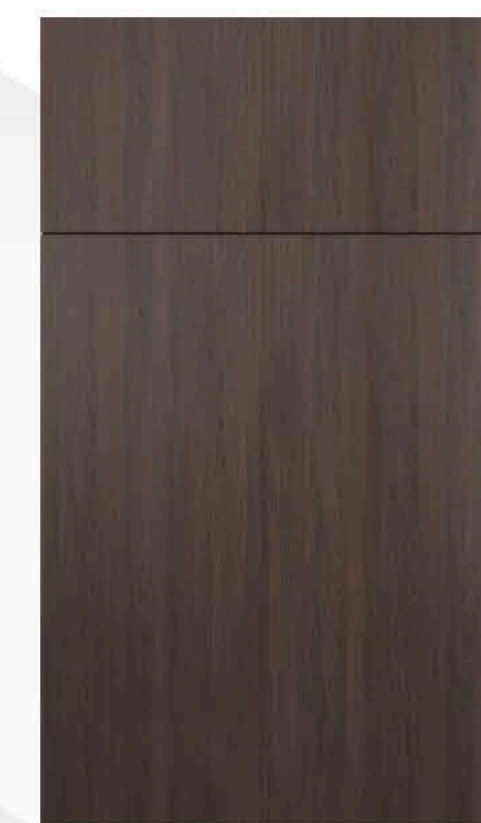

MS-D07
Forest City

OUR PRODUCTS



VSD60
with Mirror Vanity



VSD18
Vanity

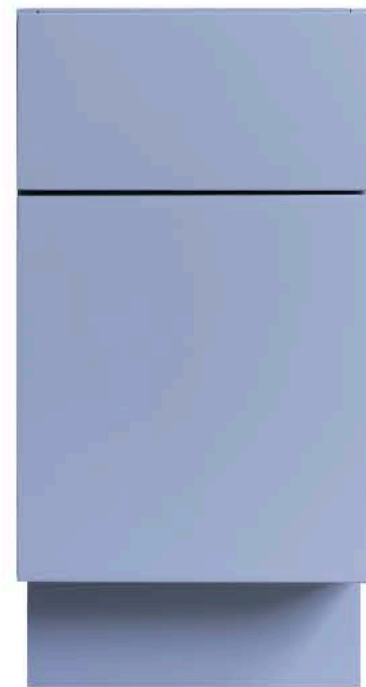

Flat Door Cabinet



Folding Lift
Up Frameless
Cabinet



Inset Door
Cabinet

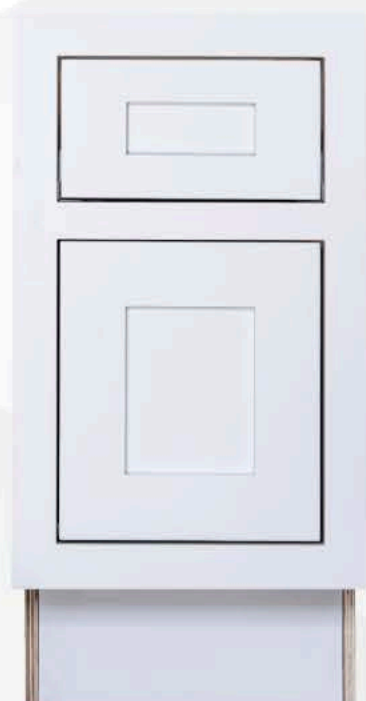

Soft Closing Inset
Door Cabinet

OUR PRODUCTS

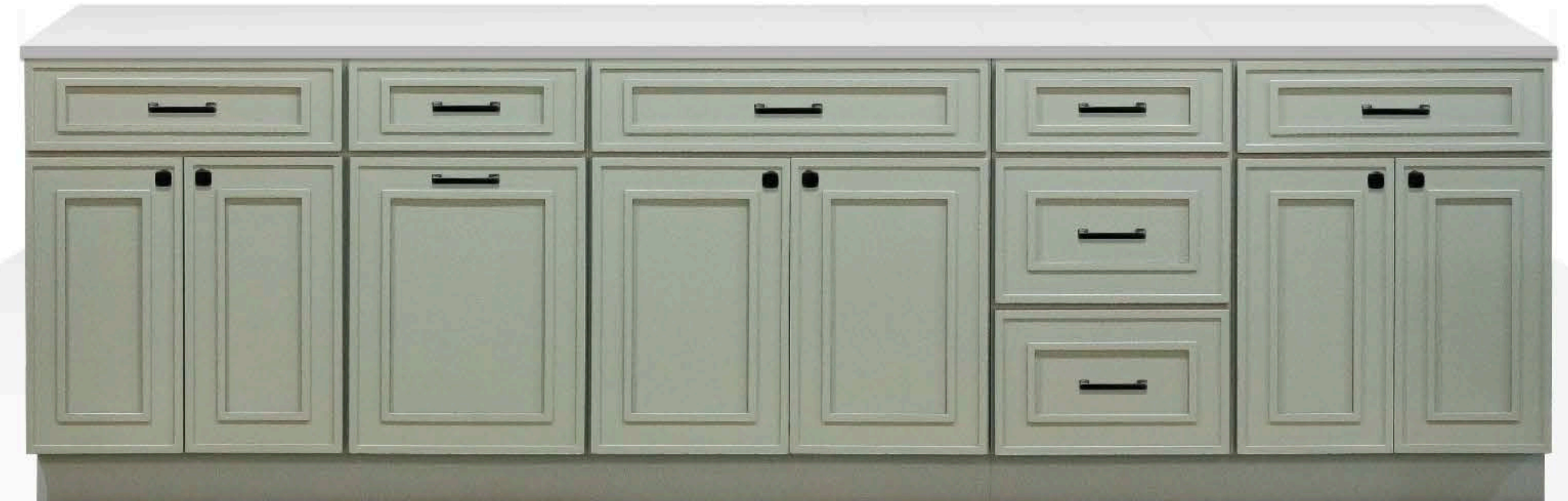

OUR PRODUCTS



OUR PRODUCTS

