

/// HOMINTEC 100

Aluminum double hung window

■ Performance

U-Factor	$Uw \leq 1.8 \sim 2.0 W/m^2K$
Air Tightness [m3/(m·h)]	level 7
Water Tightness(Pa)	level 4
Wind Load Resistance(Kpa)	level 7
Acoustic Performance(dB)	level 3

■ Personalized

Handle color:	White
External aluminum color:	White, Black, Brown, Gray
Grilles between glass:	Single-color grille 18*9; antique Chinese-style single-color grille 15*12; two-color grille 18*11
Simulated divided lites+Grilles between glass:	Three layers: 20mm wide style grille + glass inward bending spacer (black color)

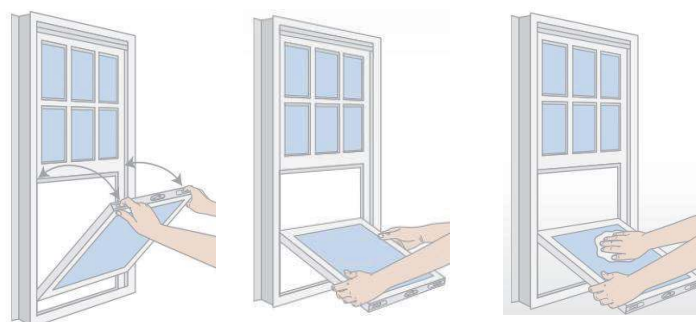

High-performance single and double sliding windows with thermal insulation profiles can be tilted inwards (double sliding windows with double sashes can be tilted inwards) to facilitate indoor cleaning.

Configuration:

- **Overall thickness of frame:** 100mm
- **Aluminum spray coating:** Powder / fluorocarbon
- **Aluminum surface effect:** Frosted
- **Aluminum wall thickness:** High-precision 6060-T5 profile, 1.6~1.8mm
- **Profile properties:** Frame insulation bridge 30mm, sash 30mm
- **Corner joint:** Corner assembly + glue injection process
- **Glass configuration:** CSG or Xinyi original glass, thickness 30mm, argon + warm edge spacer + single LOW-E
- **Glass grating:** Built-in aluminum grating
- **Hardware configuration:** Caldwell (heavy-duty puller) + anti-collision block
- **Handle standard configuration:** Flip lock + crescent lock
- **Main sealing strips:**
 1. Main seal: EPDM Jiangyin "Haida" automotive grade
 2. Glass inside and outside: soft and hard co-extruded rubber strips, Jiangyin "Haida" automotive grade
- **Recommended size:** Maximum 1000*2400mm, Minimum: 300*600mm
- **Weight of single door:** 36KG
- **Screen window:** External detachable screen window



/// HOMINTEC F130TS
Aluminum lift and slide door



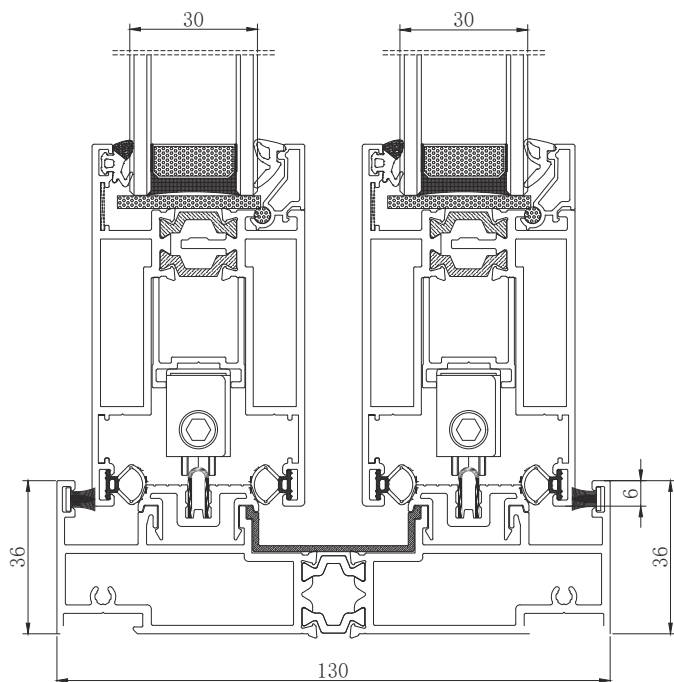
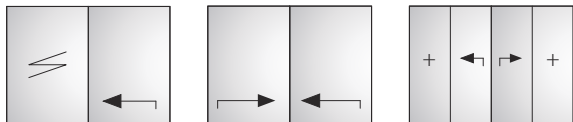

■ Performance

U-Factor	$U_w \leq 1.8 \sim 2.0 W/m^2K$
Air Tightness [m3/(m·h)]	level 7
Water Tightness(Pa)	level 4
Wind Load Resistance(Kpa)	level 7
Acoustic Performance(dB)	level 4

■ Personalized

Handle color:	Black
External aluminum color:	Customized
Door handle lock:	Double-sided multi-point buckle handle with outdoor lock cylinder
Door handle lock:	Double-sided sliding handle with lock cylinder
Glass blinds:	Manual blinds or electric blinds
Grilles between glass:	Single-color grille 18*9; antique Chinese-style single-color grille 15*12; two-color grille 18*11
Simulated divided lites+Grilles between glass:	Three layers: 20mm wide style grille + glass inward bending spacer (black color)
Screen door:	Sliding high-transparency mesh screen door



Configuration:

- **Overall thickness of frame:** 130mm
- **Aluminum spray coating:** Powder / fluorocarbon
- **Aluminum surface effect:** Frosted
- **Aluminum wall thickness:** High-precision 6060-T66 profile, 1.8~2.0mm
- **Profile properties:** Frame insulation bridge 18mm, sash 18mm
- **Corner joint:** Corner assembly + glue injection process
- **Glass configuration:** CSG or Xinyi original glass, thickness 30/33mm, argon + warm edge spacer + single LOW-E
- **Hardware configuration:** CMECH (normal sliding hardware system)
- **Handle standard configuration:** CMECH
- **Main sealing strips:**
 1. Main seal: EPDM Jiangyin "Haida" automotive grade
 2. Glass inside and outside: soft and hard co-extruded rubber strips, Jiangyin "Haida" automotive grade
- **Opening range:** Width 720~2000mm, Height: 1800~2700mm
- **Maximum load-bearing capacity of a single sash:** Standard 120KG pulley, overweight uses 300kg pulley
- **Tip:** Fixed sash glass is sent to the construction site for on-site installation

/// HOMINTEC H98S
Aluminum inward opening window
(ultra slim frame tilt and turn)



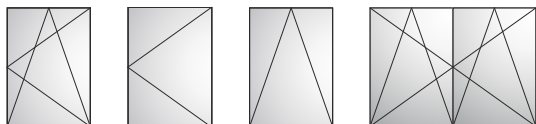

The narrow frame and flush design of the inward and outward frame sash present an integrated facade effect, which is favored by the market! It supports customization of various opening methods, such as inward opening and outward opening, and can be matched with colors to show a harmonious home style.

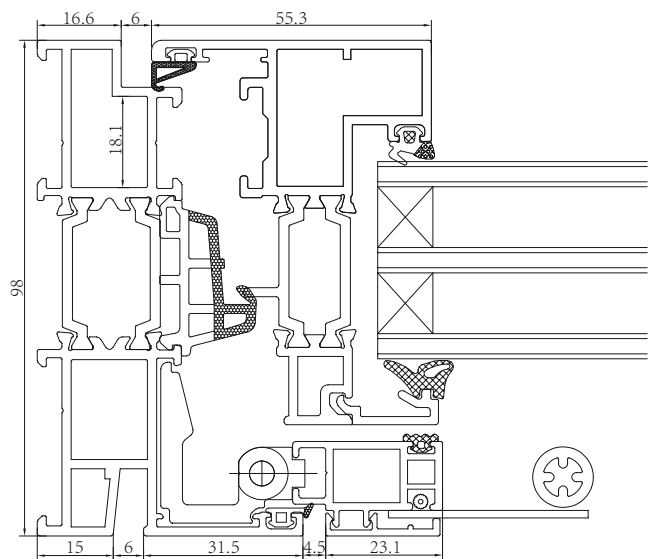

■ Performance

U-Factor	$U_w \leq 1.5 \sim 1.7 \text{ W/m}^2\text{K}$
Air Tightness [m ³ /(m·h)]	level 6
Water Tightness (Pa)	level 4
Wind Load Resistance (Kpa)	level 7
Acoustic Performance (dB)	level 4

■ Personalized

Handle color:	Brown, Silver, White, Black
External aluminum color:	Customized
Handles with locks:	German Hoppe handles with locks
Handle:	Handle without base
Handle height customization:	Can be lowered by 100~200mm
Glass blinds:	Manual blinds or electric blinds
Grilles between glass:	Single-color grille 18*9; antique Chinese-style single-color grille 15*12; two-color grille 18*11
Simulated divided lites+Grilles between glass:	Three layers: 20mm wide style grille + glass inward bending spacer (black color)
Corner window:	90 degree corner or 135 degree corner



Configuration:

- **Overall thickness of frame:** 98mm
- **Aluminum spray coating:** Powder / Fluorocarbon
- **Aluminum surface effect:** Frosted
- **Aluminum wall thickness:** High-precision 6060-T66 profile, 1.8~2.5mm
- **Profile properties:** Thermally break, 30mm
- **Corner joint:** Seamless welding process, sash round corner R=6
- **Glass configuration:** CSG or Xinyi original glass, thickness 30/39mm, argon gas + warm edge spacer + single LOW-E
- **Hardware configuration:** German ROTO hidden hardware
- **Standard handle:** German Hoppe handle
- **Main sealing strips:**
 1. Main seal: EPDM Jiangyin "Haida" automotive grade
 2. Glass inside and outside: soft and hard co-extruded rubber strip, Jiangyin "Haida" automotive grade
- **Opening production range:** Width 450~900mm, height: 600~2400mm
- **Maximum load:** 110KG
- **With screen window:** The screen can be equipped with high-transparency screen or stainless steel screen (for double windows swing open screen not applicable)
- **Optional products:** H98(without mesh screen)



▤ HOMINTEC 90HW

Aluminum-clad wood outward opening windows and outward bottom-hung windows



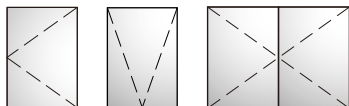

German Roto is a professional door and window hardware brand with multiple safety and anti-drop detail designs, stable performance, and more flexible opening and closing.

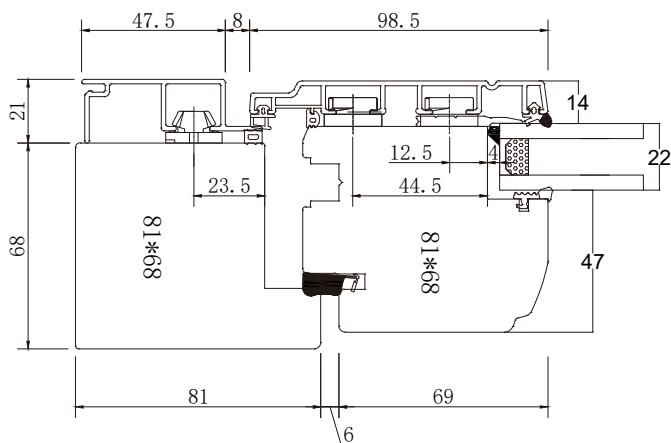

■ Performance

Uw	≤1.5~1.7W/m²K
Air Tightness [m3/(m·h)]	5 level
Water Tightness(Pa)	4 level
Wind Load Resistance(Kpa)	7 level
Acoustic Performance(dB)	4 level

■ Personalized

Handle color:	Brown, Silver, White, Black
External aluminum color:	Customized according to needs
Inner wood color:	Customized according to needs
Handles with locks:	German Hoppe handles with locks
Handle height customization:	Can be lowered by 100~200mm (except for externally hung windows)
Glass blinds:	Manual blinds or electric blinds
Glass beauty bars:	Monochrome grid bars 18*9; Antique Chinese style monochrome grid bars 15*12; Two-tone grid bars 18*11
Glass outer grille:	20mm wide style grille + glass inner bending strip (black color)



Configuration:

- **Wood frame thickness:** 68mm
- **Aluminum frame thickness:** 21mm
- **Overall thickness of frame:** 90mm (wood + aluminum + lock gap)
- **Aluminum spray coating:** Powder/ Fluorocarbon
- **Aluminum surface effect:** Frosted or flat
- **Aluminum wall thickness:** high-precision 6060-T66 profile, 1.8~2.5mm
- **Integrated wood:** standard American oak/ American cherry wood/ Optional North American black walnut/ Brazilian rosewood/ Burmese black line teak/ Burmese rosewood
- **Standard window hardware:** German "ROTO" Noto hidden hardware
- **Hardware handle standard:** German "HOPPE"/ Optional: German FSB
- **Standard glazing configuration:** CSG or Xinyi original sheet, outward-opening window (thickness 22/30/39mm), outer-hung window (thickness 22mm) argon gas + warm edge spacer + single LOW-E
- **Main sealing strip:**
 1. Standard Schlegel Q-LON-wrapped sealing strip imported from Germany
 2. Waterproof main seal: seamless welded rubber strip, Jiangyin "Haida" automotive grade
 3. Inner glass and outer glass: soft and hard co-extruded rubber strip, Jiangyin "Haida" automobile grade
- **Paints and coatings:** Germany's "Impra" environmentally friendly water-based paint has a VOC index of less than 75 g/L.
- **Screen window:** accordion-style rolled screen

▮ HOMINTEC 200TS
Aluminum clad wood lift and slide door



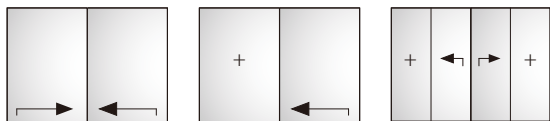

Strict sealing processes and special rubber strips imported from Germany for lifting and sliding doors meet the heat insulation requirements under different climate conditions and reduce energy loss in the process of indoor and outdoor heat conduction.

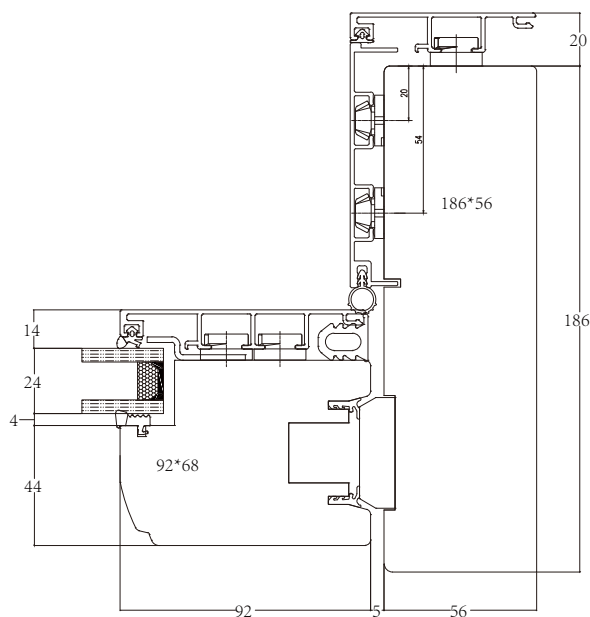

■ Performance

Uw	≤1.2~1.4W/m²K
Air Tightness [m³/(m·h)]	6 level
Water Tightness(Pa)	4 level
Wind Load Resistance(Kpa)	7 level
Acoustic Performance(dB)	4 level

■ Personalized

Handle color:	Brown, Silver, White, Black
External aluminum color:	Customized according to needs
Inner wood color:	Customized according to needs
Door lock:	Double-sided lock with extended handle
Glass blinds:	Manual blinds or electric blinds
Glass beauty bars:	Monochrome grid bars 18*9; Antique Chinese style monochrome grid bars 15*12; Two-tone grid bars 18*11
Glass outer grille:	20mm wide style grille + glass inner bending strip (black color)
Screen door:	Sliding gold steel screen door (requires a cross beam in the middle)



Configuration:

- **Wood frame thickness:** 182mm
- **Aluminum frame thickness:** 14mm
- **Overall thickness of frame:** 200mm (wood + aluminum + lock gap)
- **Aluminum spray coating:** Powder/ Fluorocarbon
- **Aluminum surface effect:** Frosted or flat
- **Aluminum wall thickness:** high-precision 6060-T66 profile, 1.8~2.5mm;
- **Integrated wood:** Standard American oak/ American cherry wood/ Optional North American black walnut/ Brazilian rosewood/ Burmese black line teak/ Burmese rosewood
- **Door hardware standard:** German "GU" lifting hardware
- **Standard hardware handle:** German "GU" Haobao, single-sided handle, and outdoor buckle handle; the handle height is set to 1050mm.
- **Standard glazing configuration:** CSG or Xinyi original glass, three-layer, two-cavities glass, or laminated insulating glass (thickness 24/33/43mm), argon gas, a warm edge spacer, and a single LOW-E
- **Main seal strip:**
 1. Main seal: EPDM material Jiangyin "Haida" automotive grade
 2. Glass inside and outside: soft and hard co-extruded rubber strip, Jiangyin "Haida" automotive grade
- **Paints and coatings:** Germany's "Impra" environmentally friendly water-based paint has a VOC index of less than 75 g/L.

Calculation area: If a single door is less than 4 square meters, it will be calculated as 4 square meters

- **Opening instructions:** single-leaf lifting and sliding door or double-leaf lifting and sliding door
- **Dimensions:** Aspect Ratio (1:2.5)
- **Bottom sill:** The sill height is 45mm (the maximum sinkage can be 23mm outdoors on site)

/// HOMINTEC HA97
Aluminum clad wood inward opening door



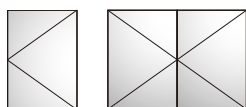

The natural texture of the wood gives windows a warm and inviting feel as a home material; it is light, vibrant, and adds depth, creating a natural, flowing scenery. Furthermore, the high-quality 304 stainless steel mesh provides high-density anti-theft and anti-mosquito features, enhancing the practical functionality of system doors and windows.

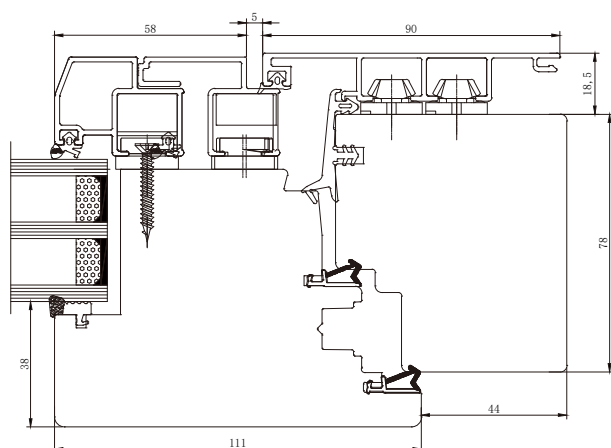

■ Performance

Uw	≤1.2~1.4W/m²K
Air Tightness [m3/(m·h)]	7 level
Water Tightness(Pa)	5 level
Wind Load Resistance(Kpa)	8 level
Acoustic Performance(dB)	5 level

■ Personalized

Handle color:	Brown, Silver, White, Black
External aluminum color:	Customized according to needs
Inner wood color:	Customized according to needs
Handle height customization:	Can be lowered by 100~200mm
Door lock:	Double-sided inner handwheel lock with lock or double-sided handle inner handwheel lock;
Top-hung sliding door:	Double-sided inner handwheel lock; double-sided handle inner handwheel lock (outdoor handle is flat)
Hinge:	Noto 3D Door Hinge
Smart door lock:	Goodjia smart fingerprint
Glass blinds:	Manual blinds or electric blinds
Glass beauty bars:	Monochrome grid bars 18*9; Antique Chinese style monochrome grid bars 15*12; Two-tone grid bars 18*11
Glass outer grille:	Three layers: 20mm wide style grille + glass inner bending strip (black color



Configuration:

- **Wood frame thickness:** 78mm
- **Aluminum frame thickness:** 15mm
- **Overall thickness of frame:** 97mm (wood + aluminum + lock gap)
- **Aluminum spray coating:** Powder/ Fluorocarbon
- **Aluminum surface effect:** Frosted/ flat
- **Aluminum wall thickness:** High-precision 6060-T66 profile, 1.8~2.5mm;
- **Integrated wood:** Standard American oak/ American cherry wood/ Optional North American black walnut/ Brazilian rosewood/ Burmese black line teak/ Burmese rosewood
- **Door hardware standard:** German "ROTO" brown
- **Hardware handle standard:** German "HOPPE"/ Optional: German FSB
- **Standard glazing configuration:** CSG or Xinyi original glass, three-layer two-cavities glass or laminated insulating glass (thickness 33/43mm), argon gas + warm edge spacer + single LOW-E
- **Main sealing strip:**
 1. Standard Schlegel Q-LON wrapped sealing strip imported from Germany
 2. Waterproof main seal: seamless welded rubber strip, Jiangyin "Haida" automotive grade
 3. Inner glass and outer glass: soft and hard co-extruded rubber strip, Jiangyin "Haida" automobile grade
- **Paints and coatings:** Germany's "Impra" environmentally friendly water-based paint has a VOC index of less than 75 g/L
- **Bottom sill:** Sill height 90mm; Optional: low sill, sill height 32mm
- **Calculation area:** If a single door is less than 1.8 square meters, it will be calculated as 1.8 square meters
- **Screen door:** outward-opening gold steel screen door (screen door cannot be realized for doors without bottom sill, double-sided handle and double-sided lock, screen door handle can be adjusted by 250mm)
- **Optional series:** HA87

HOMINTEC PASSIVE HA120

Passive window (external hanging type)

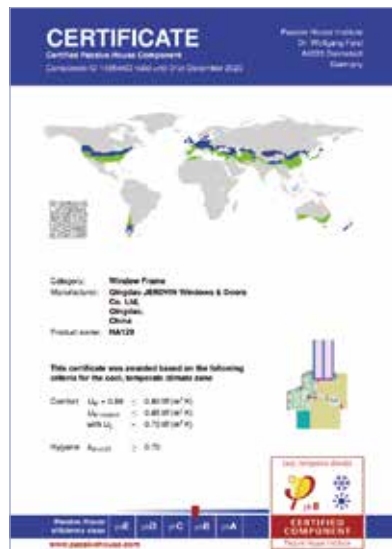

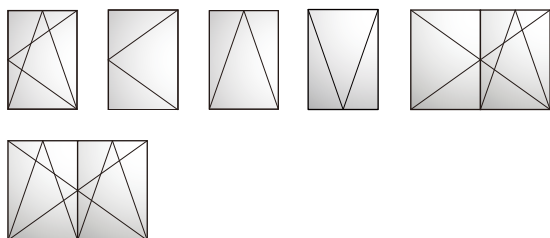

International external hanging installation: the passive window and the external wall insulation are at the same level, forming an effective isotherm, reducing heat loss by about 20%, and a professional waterproof and air barrier membrane and breathable membrane effectively ensuring the air tightness of the passive window.

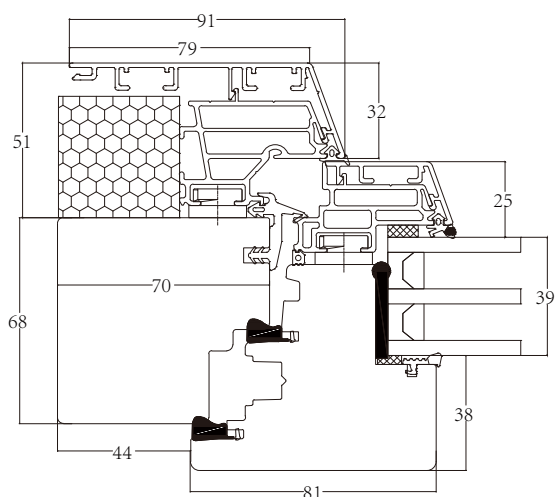

■ Performance

Uw	≤0.8W/m²K
Air Tightness [m³/(m·h)]	8 level
Water Tightness(Pa)	6 level
Wind Load Resistance(Kpa)	9 level
Acoustic Performance(dB)	6 level

■ Personalized

Handle color:	Brown, Silver, White, Black
External aluminum color:	Customized according to needs
Inner wood color:	Customized according to needs
For top-hung windows, priority option:	German "Winkhaus" hardware + German Hoppe locking handle
Handle height customization:	Can be lowered by 100~200mm
Glass blinds:	Manual blinds or electric blinds
Glass beauty bars:	Monochrome grid bars 18*9; Antique Chinese style monochrome grid bars 15*12; Two-tone grid bars 18*11
Glass outer grille:	20mm wide style grille + glass inner bending strip (black color)



Configuration:

- **Wood frame thickness:** 68mm
- **Aluminum frame thickness:** 16mm
- **ABS plastic:** 33mm
- **Overall thickness of frame:** 120mm (wood + aluminum + ABS + lock gap)
- **Aluminum spray coating:** Powder/ Fluorocarbon
- **Aluminum surface effect:** Frosted or flat
- **Aluminum wall thickness:** high-precision 6060-T66 profile, 1.8~2.5mm;
- **Integrated wood:** Standard Siberian pine or red pine/ Optional American oak/ American cherry wood/ North American black walnut/ Brazilian rosewood/ Burmese black line teak/ Burmese rosewood
- **Window hardware standard:** German "WINKHAUS"/ European standard RC2 anti-theft level/ Optional: German "ROTO"
- **Hardware handle standard:** German "HOPPE"/ Optional: German FSB
- **Standard glazing configuration:** CSG or Xinyi original glass, three-layer two-cavities glass or laminated insulating glass (thickness 39/51mm), argon gas + warm edge spacer + double silver LOW-E
- **Main sealing strip:**
 1. Standard Schlegel Q-LON-wrapped sealing strip imported from Germany
 2. Waterproof main seal: seamless welded rubber strip, Jiangyin "Haida" automotive grade
 3. Inner glass and outer glass: soft and hard co-extruded rubber strip, Jiangyin "Haida" automobile grade
- **Paints and coatings:** Germany's "Impira" environmentally friendly water-based paint has a VOC index of less than 75 g/L.
- **Screen window:** The HP35 model has an integrated internal opening screen window
- **If screen windows are selected:** Paired casement windows cannot be made. Hanging window screens can only be fixed
- **Optional series:** HA130

◊ HOMINTEC ITALIAN Z136
Slim aluminum-clad wood window



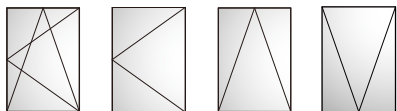

The combination of passive energy-saving technology and an extremely narrow Italian-style structure is simple and smooth, and the home style is more elegant.

The combination of natural wood and 4SG's long-lasting sealing system creates a livable space with constant temperature and humidity.

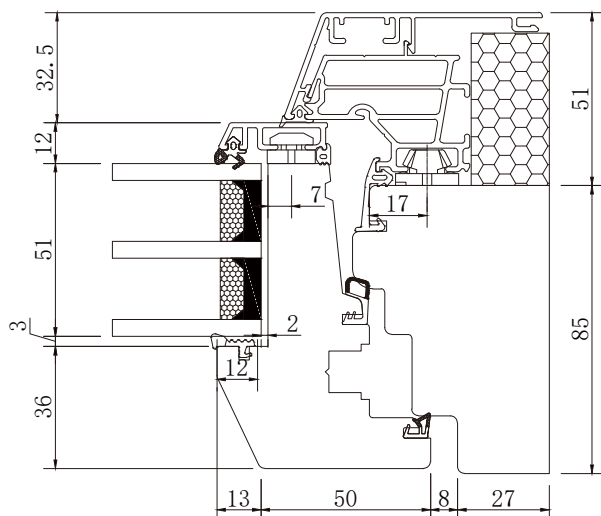

■ Performance

Uw	≤0.8~1.0W/m²K
Air Tightness [m3/(m·h)]	8 level
Water Tightness(Pa)	5 level
Wind Load Resistance(Kpa)	9 level
Acoustic Performance(dB)	5 level

■ Personalized

Handle color:	Brown, Silver, White, Black
External aluminum color:	Customized according to needs
Inner wood color:	Customized according to needs
For top-hung windows, priority option:	German "Winkhaus" hardware + German Hoppe locking handle
Handle height customization:	Can be lowered by 100~200mm
Glass blinds:	Manual blinds or electric blinds
Glass beauty bars:	Monochrome grid bars 18*9; Antique Chinese style monochrome grid bars 15*12; Two-tone grid bars 18*11
Glass outer grille:	20mm wide style grille + glass inner bending strip (black color)

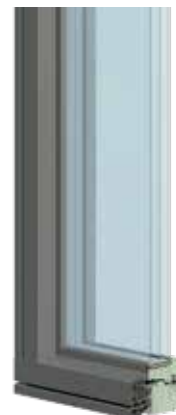

Configuration:

- **Wood frame thickness:** 85mm;
- **Aluminum frame thickness:** 18mm
- **ABS plastic:** 33mm
- **Overall thickness of frame:** 136mm (wood + aluminum + ABS plastic + lock gap)
- **Aluminum spray coating:** Powder/ Fluorocarbon
- **Aluminum surface effect:** Frosted or flat
- **Aluminum wall thickness:** High-precision 6060-T66 profile, 1.8~2.5mm
- **Integrated wood:** Standard American oak/ American cherry wood/ Optional North American black walnut/ Brazilian rosewood/ Burmese black line teak/ Burmese rosewood
- **Standard window hardware:** German "WINKHAUS" hidden hardware/ European standard RC2 anti-theft level/ optional: German "ROTO"
- **Hardware handle standard:** German "HOPPE"/ Optional: German FSB
- **Standard glazing configuration:** CSG or Xinyi original glass, three-layer, two-cavities glass, or laminated insulating glass (thickness 33/51mm), argon gas, a warm edge spacer, and a single LOW-E
- **Main sealing strip:**
 1. Standard Schlegel Q-LON-wrapped sealing strip imported from Germany
 2. Waterproof main seal: seamless welded rubber strip, Jiangyin "Haida" automotive grade
 3. Inner glass and outer glass: soft and hard co-extruded rubber strip, Jiangyin "Haida" automobile grade
- **Paints and coatings:** Germany's "Impra" environmentally friendly water-based paint has a VOC index of less than 75 g/L.
- **Screen window:** HP35/HP40 model integrated internal opening screen window
- **If screen windows are selected:** Paired casement windows cannot be made. Hanging window screens can only be fixed.