

# WoodBon

We Redefine RTA Quality



*Catalogue*

# WoodBon

**MANUFACTURED BY CAMBODIAN BIRCHEVER FURNITURE CO., LTD.**

Cambodian Birchever Furniture Co., Ltd.  
Cambodian Zhejiang Guoji SEZ, Preah Sihanouk Province, Cambodia 180101  
Phone: +855 70355066  
Email: sales@birchever.com

[www.birchever.com](http://www.birchever.com)



Woodbon by Cambodian Birchever Furniture Co., Ltd., which is located in Sihanouk Province in Cambodia, devotes to R&D, manufacturing, sales and service of kitchen cabinet and bathroom vanities. Reliable quality and large production capacity has taken us being recognized as a top company in kitchen cabinet industry in South East Asia.



## CONTENTS

Overview	.....	0 1
QC System	.....	0 2
Company Profile	.....	0 4
Advantages	.....	0 6
Factory Show	.....	0 8
Specification	.....	1 0
Product List	.....	1 1

**100%** made in  
**CAMBODIA**



# Overview



 **376,000**  
Factory Size: 376,000 square feet

 **20 Million**  
Actual Investment Capital: 20 million USD

 **700+**  
Number of Workers: 700+

 **25+**  
Number of R&D and QC: 25+

 **150 CTN monthly**  
Monthly Production Capacity: 150 \* 40HQ

 **10+Years**  
Management Team Experience: 10+ years



# Q8 Quality Control System



Our vision is to manufacture the finest cabinets. To make it happen, we adopt a comprehensive quality control system in all the key production processes from raw material selection to packing. In this way, each cabinet we produce must go through 8 quality check points before shipping. That's our particular Q8 Quality Control System.



## Q1 Selected Raw Material

Good raw materials are the foundation of good products. For each batch of incoming raw materials, we will check the accuracy of their sizes and detect the moisture content.



## Q2 Precise Woodworking

All the wood components are produced in the woodworking process. It's very important to ensure the precision of the sizes and the mortise holes and the tenon tongues. Thus, QC inspection is carried out after woodworking.



## Q3 Flawless Combination

Q3 happens after the combination of wood components into doors, face frames & drawer fronts, including checking the corners to find if there is glue left and remove it. After QC, all the combined items will be put in the wood seasoning room because wood seasoning is a significant process which can lower the moisture content of finished solid wood items and avoid cracking from inside.

## Q4 Box Perfect Fit

Perfect fit structure will provide the strongest box for our cabinets. To ensure the perfect fit structure, we will check if the slots & pilot holes are made in the right places and if their size and depth are correct.



## Q5 Substrate Check before Painting

Q5 is very critical for the production because it is the final QC process before painting. Comprehensive examination is done by the QC team, including double-checking the size, whether the glue is left in corners or not, whether sanding is fully completed, and so on.



## Q6 Primer Build-up

Primer is the first step in the painting process, and also the basis for determining the surface effect. Completed sanding can enhance the basis, so Q6 inspection emphasizes on inspecting if the items are fully sanded after primer application.



## Q7 Premium Finishes

The effect of the topcoat is like the face of the cabinet, which determines the customer's first impression of it. Q7 is the inspection of surface defects and other paint effects like color, leveling, gloss, and hand feeling.



## Q8 Assembly Simulation

In Q8, our QC simulates the assembly of our products when our customers receive them. During simulation, QC will examine if the cabinets can be assembled and if there are any items like side panels & hardware missing. Q8 examination will be implemented every 50 packed cartons.



# Company Profile

## Timeline



## Why Cambodia?



Tariff Free, No AD/CVD tariff, no trade war tariff



Rich in plywood materials



Abundant disciplined and young workers



Lower production cost, such as land cost, labor cost, electricity cost etc.



Located in bonded area, tax free, convenient for import and export



Good location, easily reach to other South East Asia Countries

Woodbon by Cambodian Birchever Furniture Co., Ltd., located in Cambodia, devotes to R&D, manufacturing, sales and service of kitchen cabinet and bathroom vanities. Reliable quality and large production capacity has taken us being recognized as a top company in kitchen cabinet industry in South East Asia. The actual investment of 20 million USD for land, equipment and construction etc. has made us the highest automation cabinet factory with the hugest investment capital and largest production capacity in Cambodia.

“Legalization first, people oriented, strives for the survival by high quality, strive for the development by innovation” is our business concept.

With our carefully selected materials, expertly crafted doors, professionally engineered products, state-of-art machines, experienced craftsmen and strict quality control system, you can trust that your supplier will be the best-in-class when you choose Woodbon.

# Advantages



## 01 High quality

- 700+ skilled workers and full Chinese management with over 20-year manufacturing experience ensure high-quality supply.
- Q8 comprehensive quality control is implemented in all 8 key production processes from raw material selection to packing.

## 02 100% production in Cambodia

- Zero risk from investigations about evasion of anti-dumping duties
- Reliable materials source



The mark of responsible forestry



## 03 High efficiency

- Production lines are set up in a way that allows the layout to be consistent with the sequence of production
- 8 fully automatic CNC electronic cutting saw for box panel production.
- Slotting & pilot hole drilling completed by an automatic production line composed of automatic feeding equipment, slotting machines, automatic steering wheels, 6 rows of drills and automatic cutting equipment.
- Assembly line is applied: each worker is trained to perform one specific task rather than build an entire product unit.



## 04 OEM Plus service

- Our vision is to become a partner with our customers instead of a supplier.
- Besides OEM service, we'd like to provide practical aftersales service including quick response to customers' complaint & marketing support for sales promotion or introduction of new lines.



## 05 Eco-friendly

- Our suppliers of raw material have obtained CARB 2 certificate & EPA certificate.
  - All the dust from sanding machines is collected by machine instead of scattering everywhere.
  - VOC emission treatment system is equipped in manual painting line.
- The heat released by UV roller coating machine is collected and transferred to the wood seasoning room.



Birchever is a professional and well-managed cabinet factory. Birchever is the No.1 cabinet manufacturer in Cambodia, and Top 5 cabinet manufacturer in South East Asia ranked by actual investment capital and production capacity. Birchever adopts the latest technology and high precision equipment, which costs almost 10 million USD. As a result, it can ensure the high accuracy, high efficiency, and high quality to maximum extend. Furthermore, with decades of experiences in kitchen cabinet industry, our factory layout is at optimal level which makes production flow smooth and efficient. We care every detail. Making the highest quality cabinets with affordable price is our ultimate goal and everlasting pursuit.

# Factory Show

## Production Process

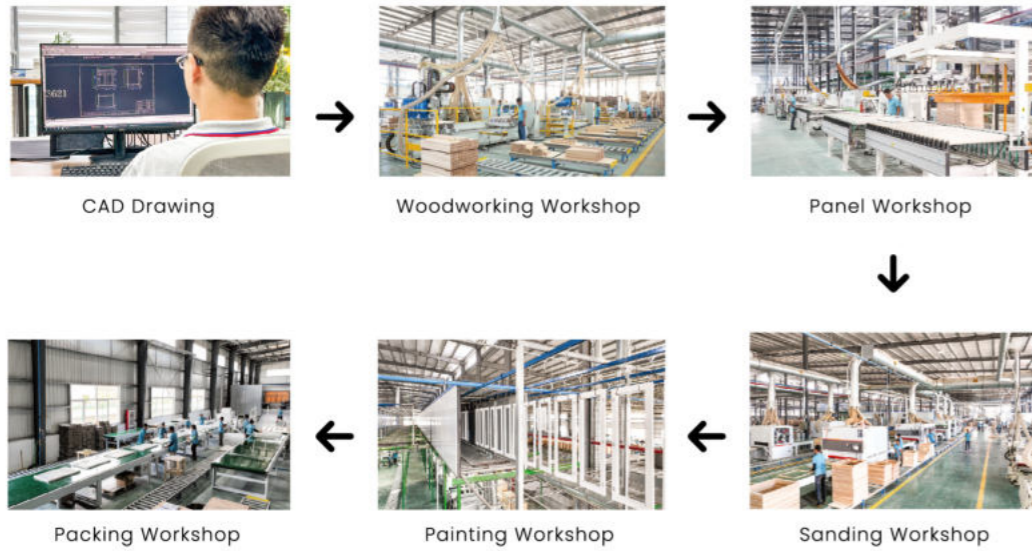

## Woodworking Workshop

- 4 German Weing Four-sided planer lines
- Double-end tenoner machine can do 4 profile per time
- Large and heated assembly machine
- Wood seasoning room with numerical system to accurately control temperature, humidity and moisture content
- 6 automatic profile sanding machines



## Panel Workshop

- 8 fully automatic CNC electronic cutting saw
- Automatic production lines combining feeding, grooving, drilling and cutting equipment in one line
- Side panel production line could finish 5 different processes in one time
- Automatic edge banding machines

## Painting Workshop



- 2 Auto reciprocating spray painting lines for primer
- 3 Auto reciprocating spray painting lines for topcoat
- 2 hanging lines for stain color
- 4 UV Roller coating lines for carcass, drawer box and face frame.
- Standard light room for color checking.



## Packing Workshop

- Pre-assemble components preparation area
- Hardware assembly area
- 2 Fully automatic packing assembly line
- Finished product inspection area
- Assembly area, every 1 out of 10 products of the same code, we assemble it to check every details.

# Specification



- A** Door - Solid wood door frame (width=3"; thickness=3/4") + MDF center panel (thickness=3/8"), 5-Piece, Full overlay
- B** Face Frame - Solid wood (width=1 1/2"; thickness=3/4")
- C** Drawer Front - 3/4" solid wood
- D** Cabinet Side Panel - Panel made of 1/2" thickness plywood
- E** Cabinet Bottom & Top Panel - Panel made of 1/2" thickness plywood
- F** Adjustable Shelves - Half-depth panel made of 3/4" plywood with front edge banding, clear coat finish
- G** Drawer Box - 5/8" thickness solid wood with dovetail construction
- H** Hinges - DTC six-way adjustable soft closing hinge
- I** Glide - DTC full extension undermount soft closing glide
- J** Toe Kick Panel - 1/2" thickness plywood

## BASE CABINETS

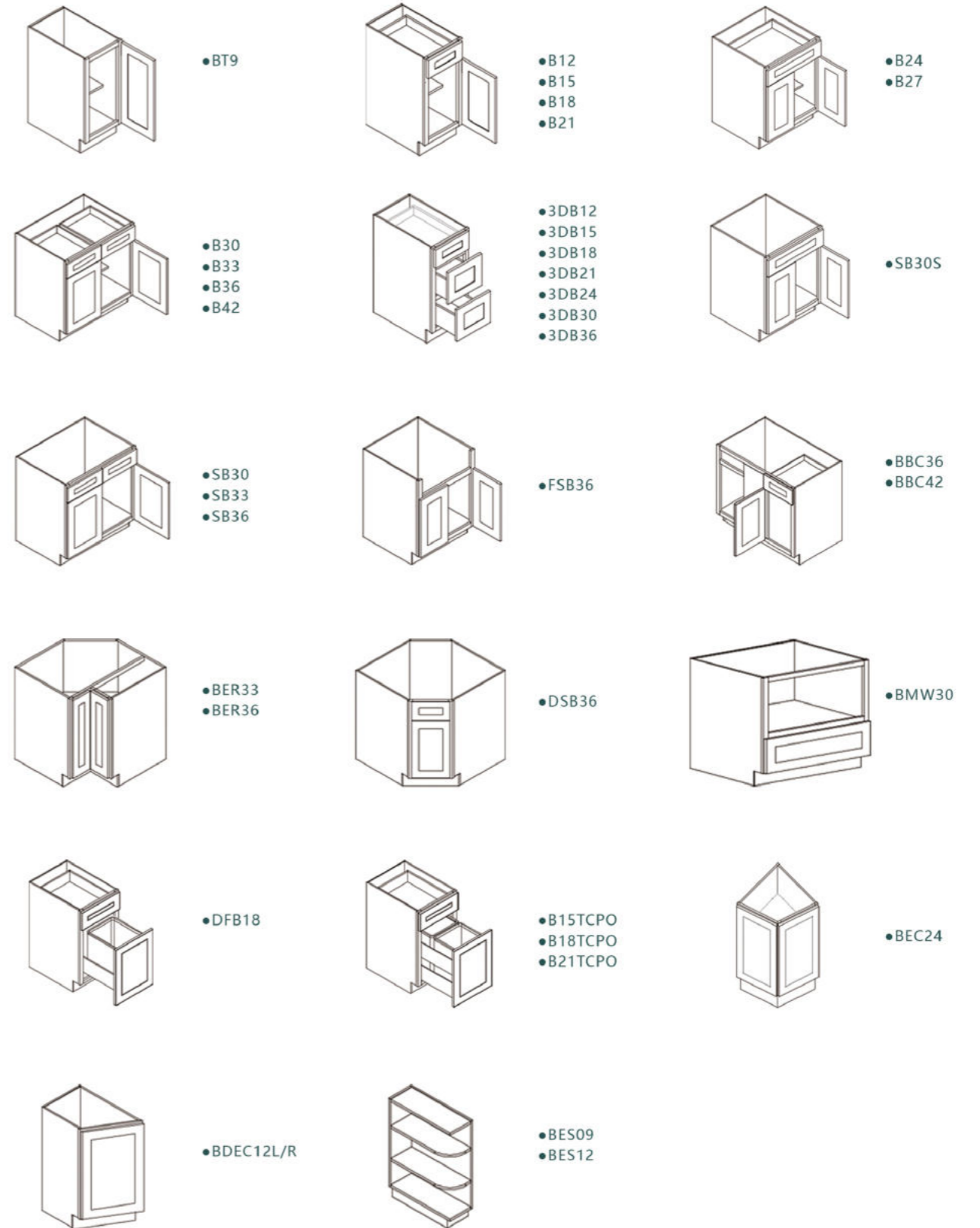

## WALL CABINETS



- W0930    •W0936
- W1230    •W1236
- W1530    •W1536
- W1830    •W1836
- W2130    •W2136



- W0942
- W1242
- W1542
- W184
- W2142



- W3012    •W3015    •W3018
- W3612    •W3615    •W3618
- W301224    •W301524    •W301824
- W331224    •W331524    •W331824
- W361224    •W361524    •W361824



- W3024
- W3624
- W302424
- W332424
- W362224



- W2430    •W2436
- W2730    •W2736
- W3030    •W3036
- W3330    •W3336
- W3630    •W3636



- W2442
- W2742
- W3042
- W3342
- W3642



- WBC2730
- WBC2736



- WBC2742



- DCW2430
- DCW2436
- DCW2442



- WER2430
- WER2436
- WER2442

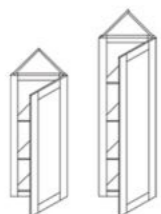

- AW1230
- AW1236
- AW1242



- MW2430    •MW2436
- MW2730    •MW2736
- MW3030    •MW3036
- MW2442
- MW2742
- MW3042

## TALL CABINETS

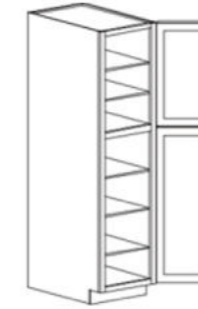

- U188424
- U189024

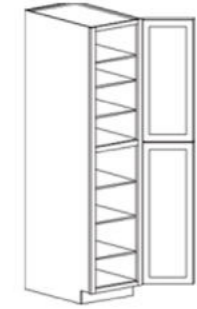

- U189624

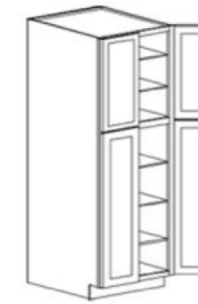

- U248424
- U249024
- U309024

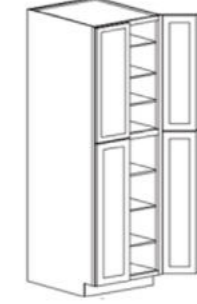

- U249624
- U309624



- O338424

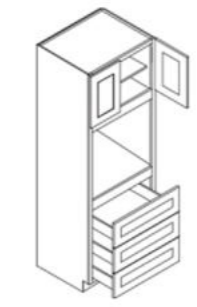

- O339024

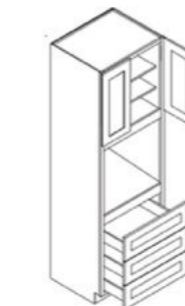

- O339624

## VANITIES



- V3021DL
- V3021DR
- V3621DL
- V3621DR

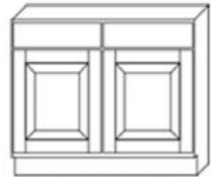

- VS30
- VS36

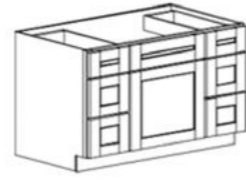

- Vddb42

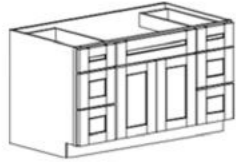

- Vddb48

## ACCESSORIES

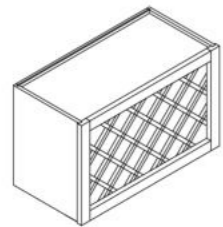

- Wine Rack**
- WR3018
  - WR3618



- Stem Glass Holder**
- SGH30
  - SGH36

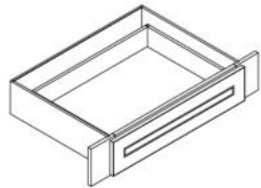

- DKD36



- Roll Out shelf**
- RS18
  - RS21
  - RS24
  - RS27
  - RS30
  - RS33
  - RS36

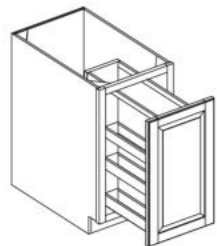

- Spice Rack**
- BSRO9

## CROWN MOLDING

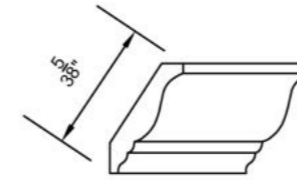

DCM

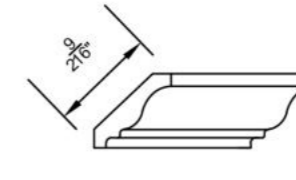

CM8

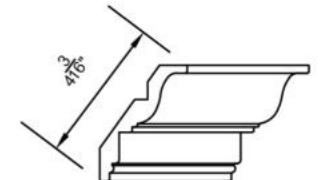

ICM

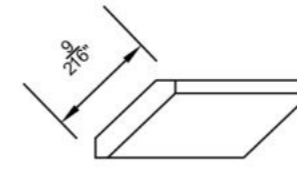

ACM8

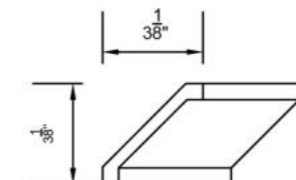

RCM8

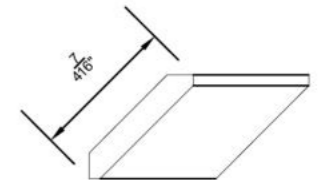

LACM8

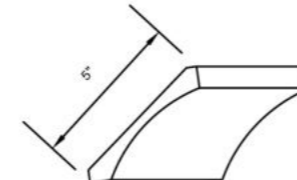

COV

## LIGHT MOLDING

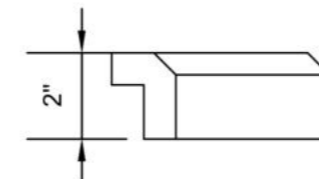

ALRM

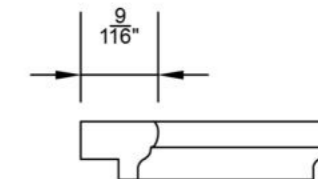

LRM

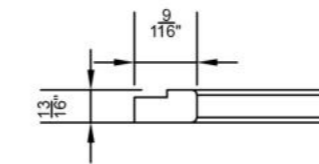

LRM-1.5

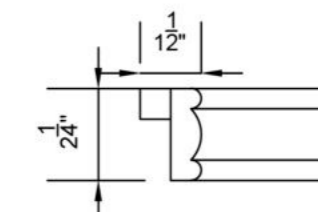

LRM8

## CORNER MOLDING

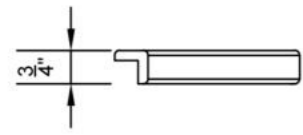

OCM

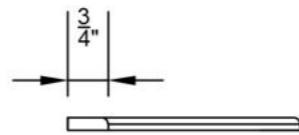

SCR

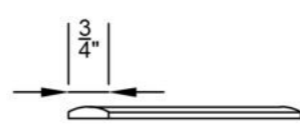

BAM

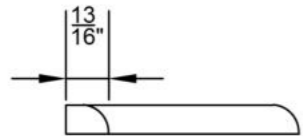

SHM

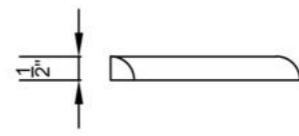

QR8

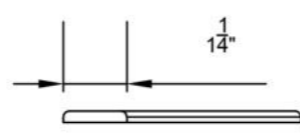

SM8-1 1/4

## OTHER MOLDING

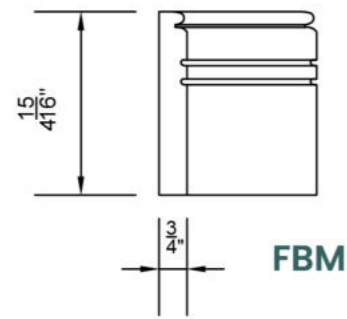

FBM

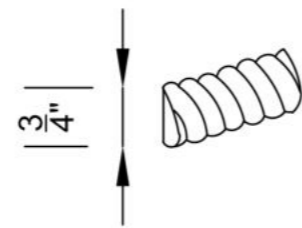

ROPE

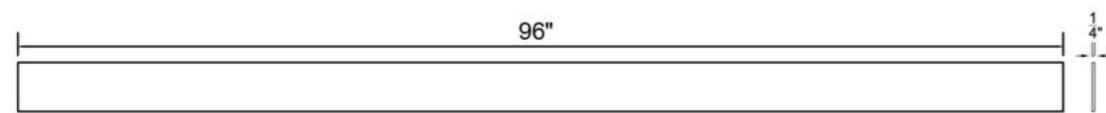

TK8

## FILLER

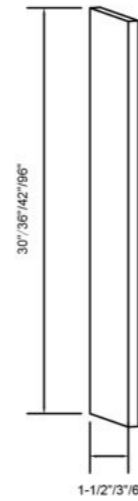

WF

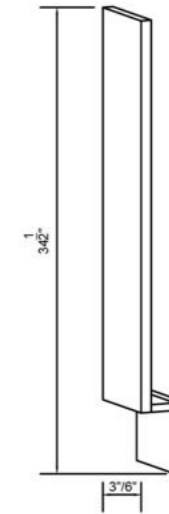

BF

## PANEL

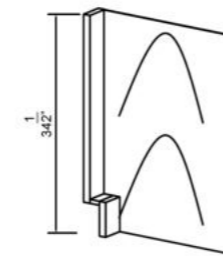

DWEP3

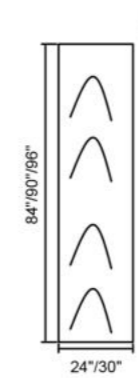

REP



REPV



Tall Decorative End Panel

- TDEP2484
- TDEP2490
- TDEP2496

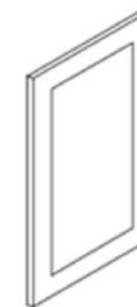

Base Decorative End Panel

- BDEP

Wall Decorative End Panel

- WDEP1212
- WDEP30
- WDEP36
- WDEP42

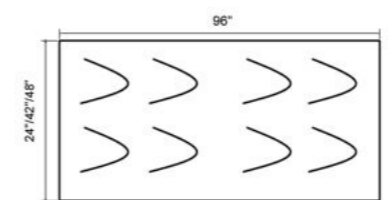

USV

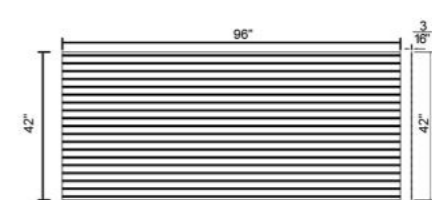

BBFPV4296

## VALANCES



VASH48



VACR48

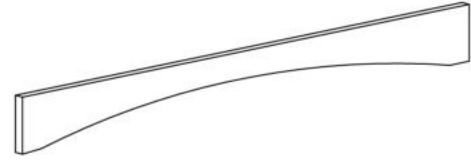

VA48

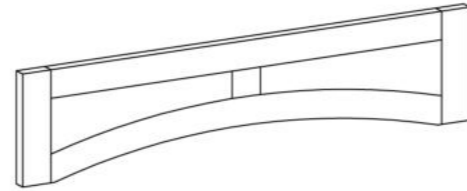

VAS36 VAS48 VAS72

## CORBEL

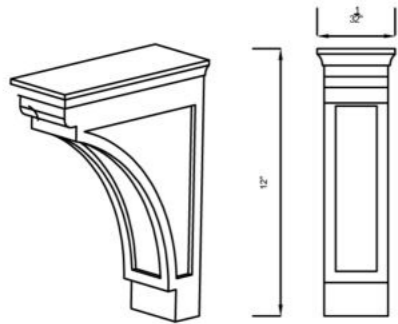

MCB

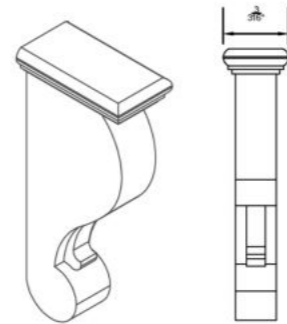

CBT

## DECORATIVE LEG

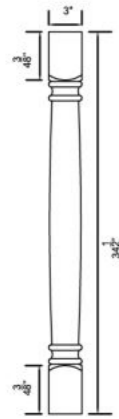

CLDL

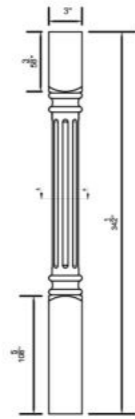

FLDL

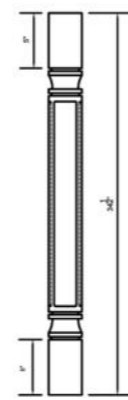

SQDL

## Popular Door Styles & Colors



Shaker White



Shaker Grey



Shaker Navy Blue



Shaker Black



Shaker Sage



Shaker Smoked Grey



Shaker Oak



Ashland Linen



Ashland Coffee

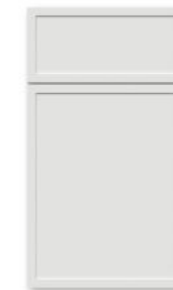

Slim Shaker White

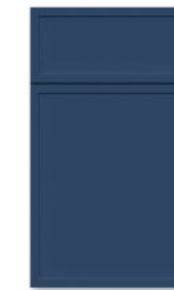

Slim Shaker Blue



Slim Shaker Timber

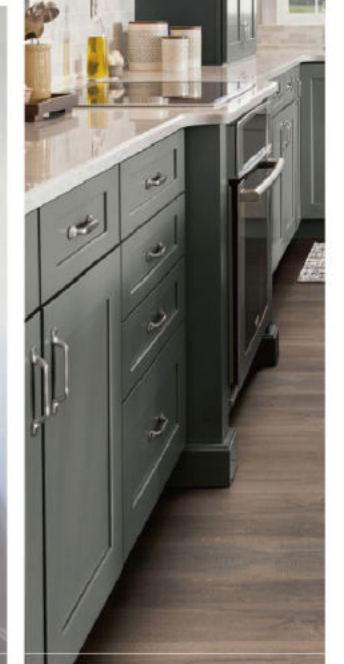

# Door Style

## Modern



Shaker (M1)



Slab (M2)

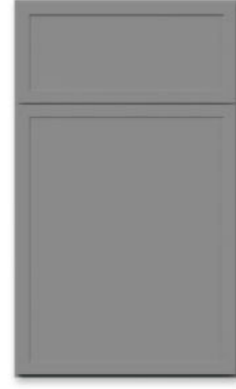

Slim Shaker (M3)

## Transitional



Ashland (T1)



Wendell (T2)



Leeton (T3)

## Timeless



Inset (TL1)



Murphy (TL2)



Davis (TL3)



